

CBAT54W  
 CBAT54AW  
 CBAT54CW  
 CBAT54SW

**SURFACE MOUNT  
 SILICON SCHOTTKY DIODES**

**SUPERmini™**



**SOT-323 CASE**



[www.centrasemi.com](http://www.centrasemi.com)

**DESCRIPTION:**

The CENTRAL SEMICONDUCTOR CBAT54W Series types are Silicon Schottky Diodes in an SOT-323 Surface Mount Package.

CBAT54W: SINGLE  
 CBAT54AW: DUAL, COMMON ANODE  
 CBAT54CW: DUAL, COMMON CATHODE  
 CBAT54SW: DUAL, IN SERIES

**MARKING CODE: C4L**  
**MARKING CODE: C42**  
**MARKING CODE: C4C**  
**MARKING CODE: C44**

**MAXIMUM RATINGS:** (T<sub>A</sub>=25°C)

Continuous Reverse Voltage  
 Continuous Forward Current  
 Peak Repetitive Forward Current  
 Forward Surge Current, tp=10ms  
 Power Dissipation  
 Operating and Storage Junction Temperature  
 Thermal Resistance

**SYMBOL**

V<sub>R</sub> 30  
 I<sub>F</sub> 200  
 I<sub>FRM</sub> 300  
 I<sub>FSM</sub> 600  
 P<sub>D</sub> 250  
 T<sub>J</sub>, T<sub>stg</sub> -65 to +150  
 θ<sub>JA</sub> 500

**UNITS**

V  
 mA  
 mA  
 mA  
 mW  
 °C  
 °C/W

**ELECTRICAL CHARACTERISTICS PER DIODE:** (T<sub>A</sub>=25°C unless otherwise noted)

SYMBOL	TEST CONDITIONS	MAX	UNITS
I <sub>R</sub>	V <sub>R</sub> =25V	2.0	μA
V <sub>F</sub>	I <sub>F</sub> =0.1mA	240	mV
V <sub>F</sub>	I <sub>F</sub> =1.0mA	320	mV
V <sub>F</sub>	I <sub>F</sub> =10mA	400	mV
V <sub>F</sub>	I <sub>F</sub> =30mA	500	mV
V <sub>F</sub>	I <sub>F</sub> =100mA	800	mV
C <sub>d</sub>	V <sub>R</sub> =1.0V, f=1.0MHz	10	pF
t <sub>rr</sub>	I <sub>F</sub> =I <sub>R</sub> =10mA, I <sub>rr</sub> =1.0mA, R <sub>L</sub> =100Ω	5.0	ns

CBAT54W  
 CBAT54AW  
 CBAT54CW  
 CBAT54SW

SURFACE MOUNT  
 SILICON SCHOTTKY DIODES



SOT-323 CASE - MECHANICAL OUTLINE

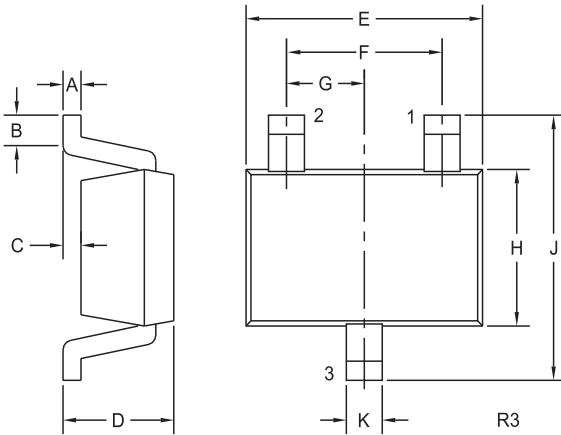

SYMBOL	INCHES		MILLIMETERS	
	MIN	MAX	MIN	MAX
A	0.002	0.008	0.05	0.20
B	0.004	-	0.10	-
C	-	0.004	-	0.10
D	0.031	0.043	0.80	1.10
E	0.071	0.087	1.80	2.20
F	0.051		1.30	
G	0.026		0.65	
H	0.045	0.053	1.15	1.35
J	0.079	0.087	2.00	2.20
K	0.008	0.016	0.20	0.40

SOT-323 (REV: R3)

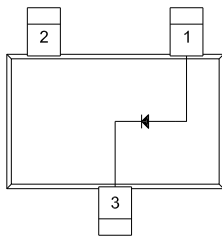

**CBAT54W**

**LEAD CODE:**

- 1) Anode
- 2) No Connection
- 3) Cathode

**MARKING  
 CODE: C4L**

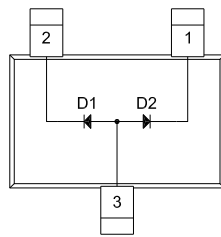

**CBAT54AW**

**LEAD CODE:**

- 1) Cathode D2
- 2) Cathode D1
- 3) Anode D1, D2

**MARKING  
 CODE: C42**

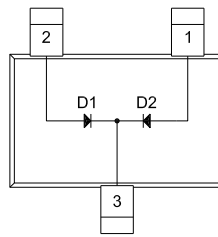

**CBAT54CW**

**LEAD CODE:**

- 1) Anode D2
- 2) Anode D1
- 3) Cathode D1, D2

**MARKING  
 CODE: C4C**

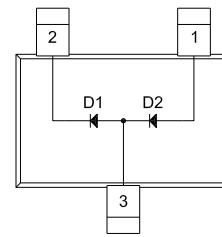

**CBAT54SW**

**LEAD CODE:**

- 1) Anode D2
- 2) Cathode D1
- 3) Anode D1, Cathode D2

**MARKING  
 CODE: C44**

R1 (4-January 2010)