



FAST RECOVERY RECTIFIERS

DESCRIPTION

This 1N3879 – 1N3883 rectifier device is suitable for applications in DC power supplies, inverters, converters, choppers and ultrasonic systems as well as other applications. It can also be used as a free-wheeling diode. It is available in both standard and reverse polarities. Microsemi also offers numerous other products to meet higher and lower power voltage regulation applications.

Important: For the latest information, visit our website <http://www.microsemi.com>.

FEATURES

- Very low forward voltage.
- Fast recovery time.
- Low thermal resistance.
- Mechanically rugged.
- Both polarities available.
- RoHS compliant devices available by adding “e3” suffix.

APPLICATIONS / BENEFITS

- 6 amps current rating.
- Short reverse recovery time.
- High surge capability.
- Hermetically sealed.

MAXIMUM RATINGS

Parameters/Test Conditions	Symbol	Value	Unit
Junction and Storage Temperature	T _J and T _{STG}	-65 to +175	°C
Thermal Resistance Junction-to-Case	R _{θJC}	2.0	°C/W
Working Peak Reverse Voltage	V _{RWM}	1N3879(R)	50
		1N3880(R)	100
		1N3881(R)	200
		1N3882(R)	300
		1N3883(R)	400
Repetitive Peak Reverse Voltage	V _{RRM}	1N3879(R)	50
		1N3880(R)	100
		1N3881(R)	200
		1N3882(R)	300
		1N3883(R)	400
Maximum Non-Repetitive Sinusoidal Surge Current (8.3 ms)	I _{FSM}	200	Amps



**DO-203AA (DO-4)
Package**

MSC – Lawrence
6 Lake Street,
Lawrence, MA 01841
Tel: 1-800-446-1158
(978) 620-2600
Fax: (978) 689-0803

MSC – Ireland
Gort Road Business Park,
Ennis, Co. Clare, Ireland
Tel: +353 (0) 65 6840044
Fax: +353 (0) 65 6822298

Website:
www.microsemi.com

MECHANICAL and PACKAGING

- CASE: Hermetically sealed metal and glass case body with 10-32 UNF3A threaded stud.
- TERMINALS: Tin-lead plated or RoHS compliant matte-tin plating on nickel.
- MARKING: MSC, date code, and symbol.
- WEIGHT: 5 grams (approximate).
- Maximum Stud Torque: 10-15 inch pounds.
- See [Package Dimensions](#) on last page.

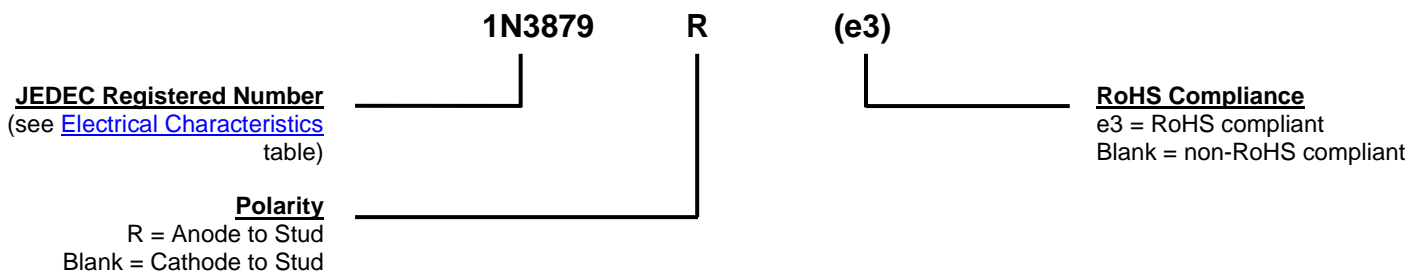
PART NOMENCLATURE

SYMBOLS & DEFINITIONS

Symbol	Definition
C_J	Junction Capacitance: The junction capacitance in pF at a specified frequency.
$I_{F(AV)}$	Average Forward Current: The average forward current dc value, no alternating component.
I_{FSM}	Maximum Forward Surge Current: The forward current, surge peak or rated forward surge current.
I_{RM}	Maximum Reverse Current: The maximum reverse (leakage) current that will flow at the specified voltage and temperature.
t_{rr}	Reverse Recovery Time: The time interval between the instant the current passes through zero when changing from the forward direction to the reverse direction and a specified decay point after a peak reverse current occurs.
V_{FM}	Maximum Forward Voltage: The maximum forward voltage the device will exhibit at a specified current.
V_{RRM}	Repetitive Peak Reverse Voltage: The peak reverse voltage including all repetitive transient voltages but excluding all non-repetitive transient voltages.
V_{RWM}	Working Peak Reverse Voltage: The maximum peak voltage that can be applied over the operating temperature range excluding all transient voltages (ref JESD282-B). Also sometimes known as PIV.

ELECTRICAL CHARACTERISTICS

Type	Typical Junction Capacitance C_J	Average Forward Current $I_{F(AV)}$	Maximum Forward Voltage V_{FM}	Maximum Reverse Current I_{RM}		Maximum Reverse Recovery Time t_{rr}
		$T_C = 100\text{ }^\circ\text{C}$	$T_J = 25\text{ }^\circ\text{C}$	$T_J = 25\text{ }^\circ\text{C}$	$T_J = 150\text{ }^\circ\text{C}$	
1N3879(R) 1N3880(R) 1N3881(R) 1N3882(R) 1N3883(R)	115 pF ⁽¹⁾	6 A	1.4 V @ $I_{FM} = 20\text{ A}$ ⁽²⁾	15 μA @ V_{RRM}	3 mA @ V_{RRM}	200 ns ⁽³⁾

- NOTES:**
1. $V_R = 10\text{ V}$, $f = 1\text{ Mhz}$, $T_J = 25\text{ }^\circ\text{C}$.
 2. $I_{FM} = 20\text{ A}$, $T_J = 25\text{ }^\circ\text{C}$. Pulse test: pulse width 300 μsec , duty cycle 2%.
 3. $I_F = 1\text{ A}$, $V_R = 30\text{ A}$, $di/dt = 25\text{ A}/\mu\text{s}$, $T_C = 55\text{ }^\circ\text{C}$.

GRAPHS

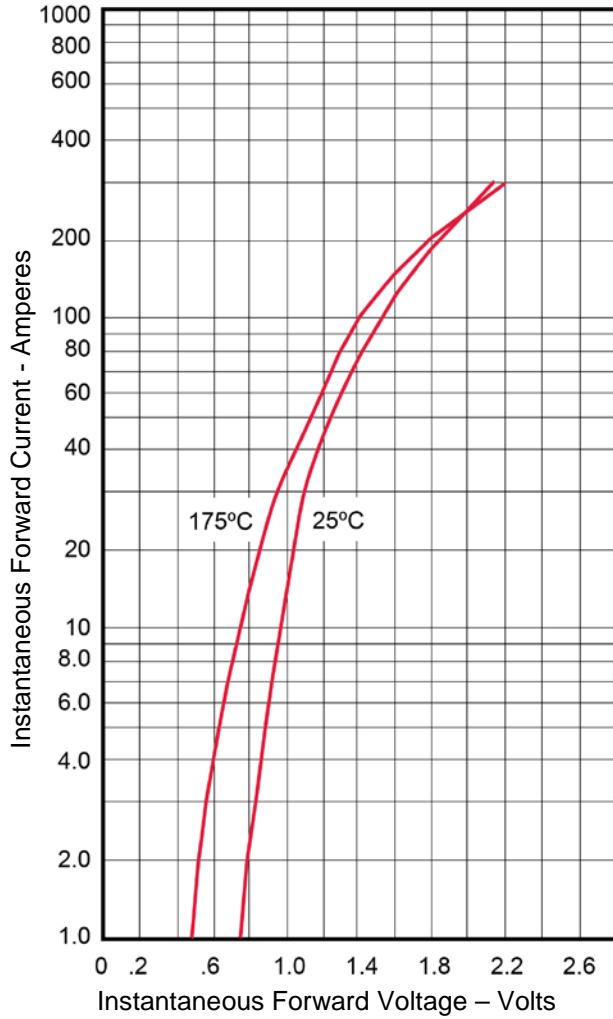

FIGURE 1
Typical Forward Characteristics

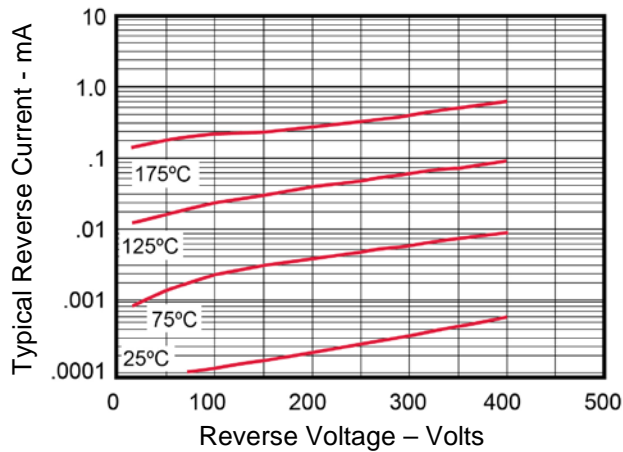

FIGURE 2
Typical Reverse Characteristics

GRAPHS (continued)

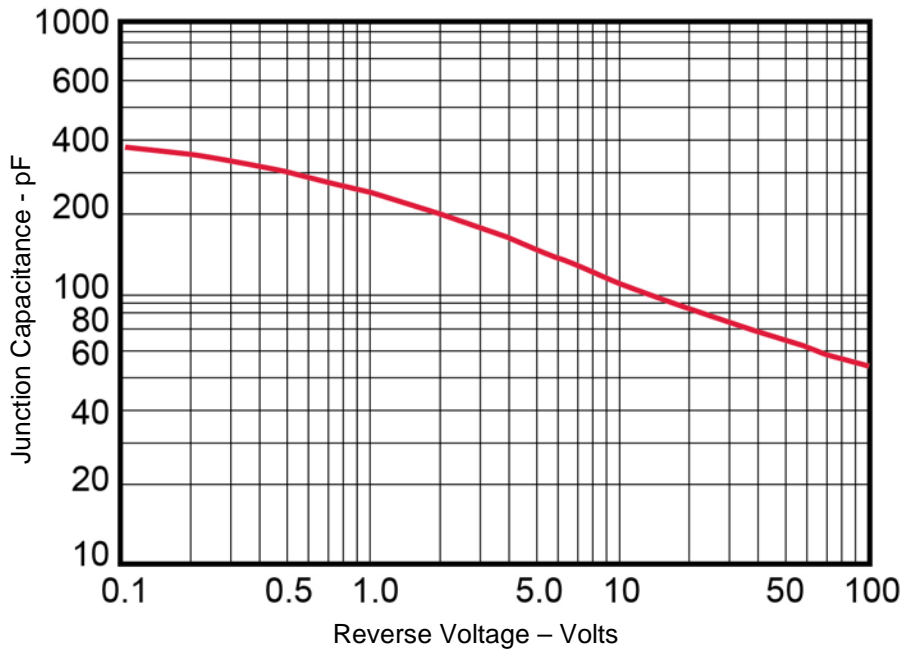

FIGURE 3
Typical Junction Capacitance

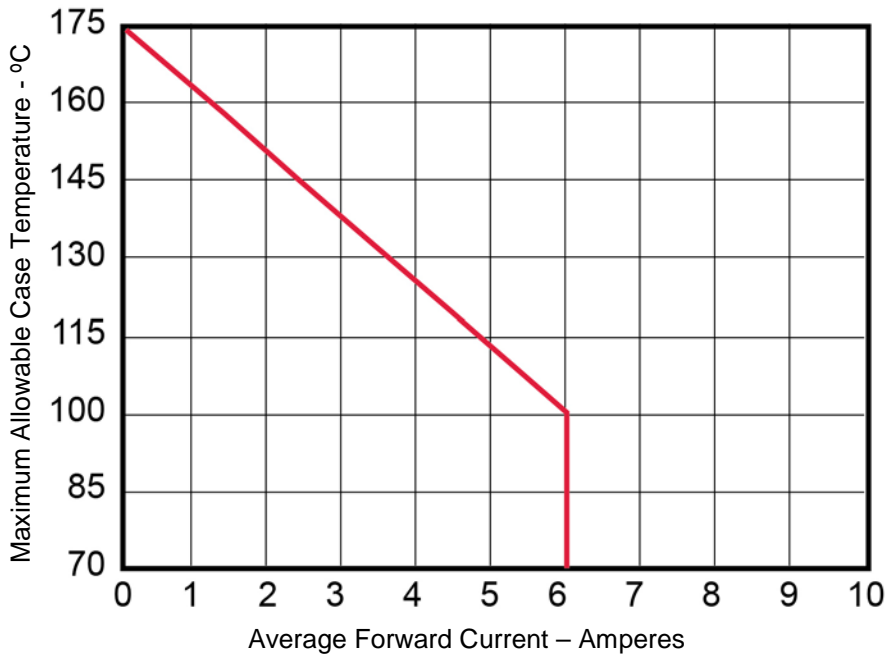
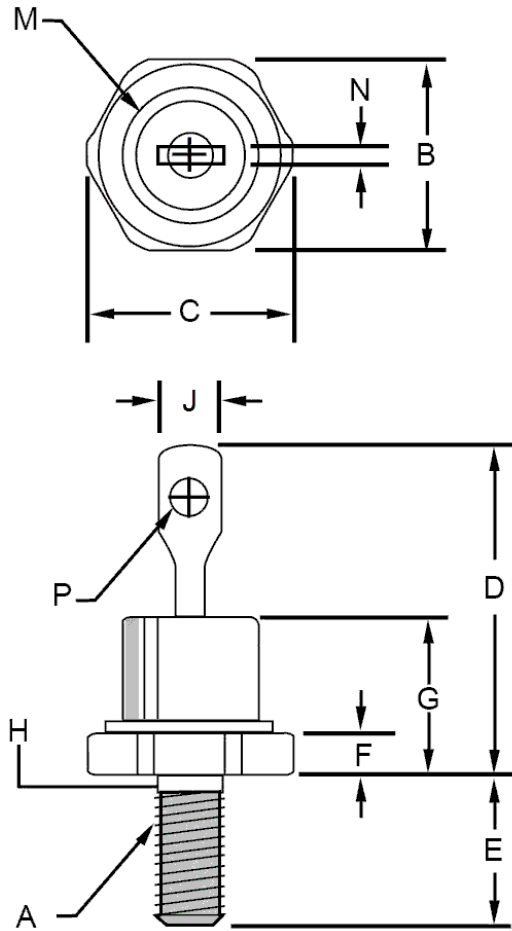

FIGURE 4
Forward Current Derating

PACKAGE DIMENSIONS

NOTES:

1. 10-32 UNF3A threads.
2. Full threads within 2 ½ threads.
3. Standard polarity: stud is cathode. Reverse polarity: stud is anode.

Ltr	Dimensions				Notes
	Inches		Millimeters		
	Min	Max	Min	Max	
A	-	-	-	-	1
B	.424	.437	10.77	11.10	
C	-	.505	-	12.82	
D	-	.800	-	20.32	
E	.422	.453	10.72	11.50	
F	.075	.175	1.90	4.44	
G	-	.405	-	10.29	
H	.163	.189	4.14	4.80	2
J	-	.250	-	6.35	
M	-	.424	-	10.77	Dia.
N	.020	.065	.510	1.65	
P	.060	-	1.52	-	Dia.