

RECOM POWER LED Drivers



This page of product is RoHS compliant.

LIGHTLINE LED DRIVERS

Low Power AC Input LED Drivers

* Dimmable † Analog PWM

For quantities greater than listed, call for quote.

| MOUSER STOCK NO. | Recom Part No. | Fig. | Input Range (VAC) | Output Voltage (VDC) | Output Current (mA) | Power (W) | IP Ratings | Max. No. LEDs (W) | Price Each | | |
|---------------------|----------------|------|-------------------|----------------------|---------------------|-----------|------------|-------------------|------------|-------|-------|
| | | | | | | | | | 1 | 5 | 10 |
| 919-RACD03-350 | RACD03-350 | A | 90-264 | 3-12 | 350 | 3 | IP66 | 3x1 | 10.12 | 9.88 | 9.64 |
| 919-RACD03-700 | RACD03-700 | A | 90-264 | 3-4.5 | 700 | 3 | IP66 | 1x2 | 10.12 | 9.88 | 9.64 |
| 919-RACD06-350 | RACD06-350 | B | 90-264 | 3-2.2 | 350 | 6 | IP20 | 6x1 | 11.34 | 10.77 | 10.20 |
| 919-RACD06-700 | RACD06-700 | B | 90-264 | 3-8.4 | 700 | 6 | IP20 | 2x2 | 11.34 | 10.77 | 10.20 |
| 919-RACD07-250 | RACD07-250 | C | 90-295 | 28 | 250 | 7 | IP67 | - | 11.56 | 10.98 | 10.40 |
| 919-RACD07-350 | RACD07-350 | C | 90-295 | 21 | 350 | 7 | IP67 | - | 11.56 | 10.98 | 10.40 |
| 919-RACD07-500 | RACD07-500 | C | 90-295 | 14.5 | 500 | 7 | IP67 | - | 11.56 | 10.98 | 10.40 |
| 919-RACT20-700-US | RACT20-700-US | D | 115 | 15-28 | 700 | 20 | IP20 | 8x2W,8+8x1 | 32.49 | 30.78 | 29.07 |
| 919-RACT20-350 | RACT20-350 | D | 230 | 30-56 | 350 | 20 | IP20 | 15x1 | 31.73 | 30.06 | 28.39 |
| 919-RACT20-700 | RACT20-700 | D | 230 | 15-28 | 700 | 20 | IP20 | 8x2W,8+8x1 | 31.73 | 30.06 | 28.39 |
| 919-RACD20-350/277 | RACD20-350/277 | E | 90-305 | 28-57 | 350 | 20 | IP66 | - | 31.68 | 30.01 | 28.35 |
| 919-RACD20-500/277 | RACD20-500/277 | E | 90-305 | 20-40 | 500 | 20 | IP66 | - | 31.67 | 30.00 | 28.34 |
| 919-RACD20-700/277 | RACD20-700/277 | E | 90-305 | 14-29 | 700 | 20 | IP66 | - | 31.67 | 30.00 | 28.34 |
| 919-RACD30-500 | RACD30-500 | F | 90-264 | 10-56 | 500 | 30 | IP20 | 15x2 | 30.07 | 28.49 | 26.91 |
| 919-RACD30-700 | RACD30-700 | F | 90-264 | 10-43 | 700 | 30 | IP20 | 12x3W,12+12x1 | 30.07 | 28.49 | 26.91 |
| *† 919-RACD35-500A | RACD35-500A | G | 90-305 | 48-57 | 500 | 28.5 | IP67 | - | 34.37 | 33.39 | 31.42 |
| *† 919-RACD35-700A | RACD35-700A | G | 90-305 | 36-48 | 700 | 33.6 | IP67 | - | 34.37 | 33.39 | 31.42 |
| *† 919-RACD35-1000A | RACD35-1000A | G | 90-305 | 24-36 | 1000 | 36 | IP67 | - | 34.37 | 33.39 | 31.42 |
| *† 919-RACD35-1400A | RACD35-1400A | G | 90-305 | 12-24 | 1400 | 33.6 | IP67 | - | 34.37 | 33.39 | 31.42 |
| *† 919-RACD35-2500A | RACD35-2500A | G | 90-305 | 9-12 | 2500 | 30 | IP67 | - | 34.37 | 33.39 | 31.42 |
| † 919-RACD45-1850A | RACD45-1850A | H | 90-307 | 48 | 105-1050 | 15-24 | IP45 | - | 43.99 | 42.74 | 40.85 |
| † 919-RACD45-1250A | RACD45-1250A | H | 90-306 | 36 | 12-1250 | 24-36 | IP45 | - | 43.99 | 42.74 | 40.85 |
| † 919-RACD45-1050A | RACD45-1050A | H | 90-305 | 24 | 185-1850 | 33-48 | IP48 | - | 43.99 | 42.74 | 40.85 |
| † 919-RACD45-700A | RACD45-700A | H | 90-308 | 57 | 70-700 | 40-57 | IP40 | - | 43.99 | 42.74 | 40.85 |
| † 919-RACD60-1050A | RACD60-1050A | H | 90-309 | 12 | 420-4200 | 40-57 | IP58 | - | 45.40 | 44.10 | 42.14 |
| † 919-RACD60-1200A | RACD60-1200A | H | 90-310 | 24 | 250-2500 | 33-48 | IP60 | - | 45.40 | 44.10 | 42.14 |

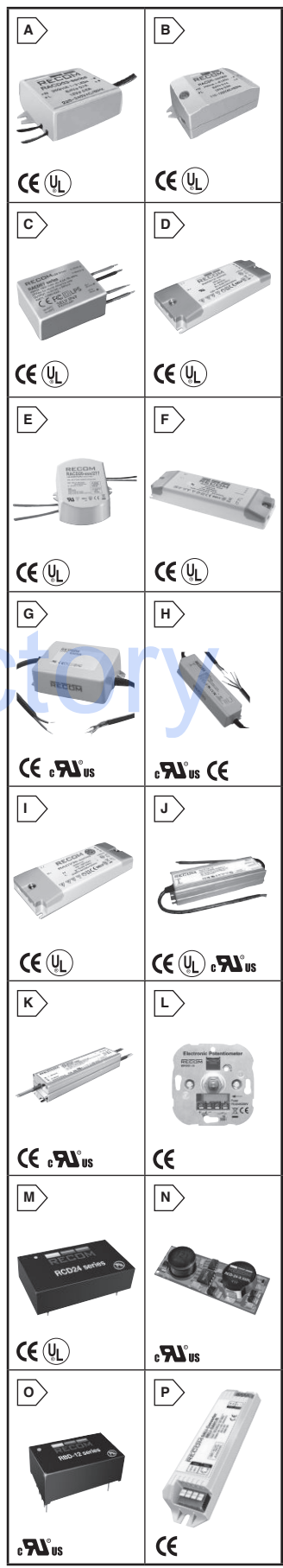

PFC Single CV Output LED AC/DC Converters

For quantities greater than listed, call for quote.

| MOUSER STOCK NO. | Recom Part No. | Fig. | Input Range (VAC) | Output Voltage (VDC) | Output Current (mA) | Power (W) | Efficiency (%) | Price Each | | |
|------------------|----------------|------|-------------------|----------------------|---------------------|-----------|----------------|------------|-------|-------|
| | | | | | | | | 1 | 5 | 10 |
| 919-RACV30-12 | RACV30-12 | I | 100-240 | 12 | 0-2500 | 30 | 83 | 31.04 | 29.41 | 27.78 |
| 919-RACV30-24 | RACV30-24 | I | 100-240 | 24 | 0-1250 | 30 | 84 | 31.04 | 29.41 | 27.78 |

Single Constant Voltage and Constant Current LED Drivers

* Analog, PWM ** PSE Certified for Japan market

For quantities greater than listed, call for quote.

| MOUSER STOCK NO. | Recom Part No. | Fig. | CV Mode | | | | CC Mode | | Power (W) | Efficiency (%) | Price Each | | |
|-----------------------|----------------|------|----------------------|-------------------|----------------|----------------------|----------------|----------------------|-----------|----------------|------------|---|----|
| | | | Constant Voltage (V) | Current Range (A) | DC Voltage (V) | Constant Current (A) | DC Voltage (V) | Constant Current (A) | | | 1 | 5 | 10 |
| * 919-RACD100-1400A | RACD100-1400A | J | 71 | 1.4 | 50-71 | 1.4 | 100 | 91 | 78.36 | 76.13 | 72.76 | | |
| * 919-RACD100-700A | RACD100-700A | J | 142 | 7.0 | 100-142 | 7.0 | 100 | 91 | 78.36 | 76.13 | 72.76 | | |
| 919-RACD100-48 | RACD100-48 | J | 48 | 0-2.1 | 34-48 | 2.1 | 100 | 91 | 71.50 | 69.47 | 66.39 | | |
| ** 919-RACD100-12-PSE | RACD100-12-PSE | J | 12 | 0-8.3 | 9-12 | 8.3 | 100 | 87 | 71.51 | 69.46 | 61.29 | | |
| ** 919-RACD100-24-PSE | RACD100-24-PSE | J | 24 | 0.4-2 | 14-24 | 4.2 | 100 | 87 | 71.51 | 69.46 | 61.29 | | |
| ** 919-RACD100-36-PSE | RACD100-36-PSE | J | 36 | 0-2.8 | 26-36 | 2.8 | 100 | 89 | 71.51 | 69.46 | 61.29 | | |
| ** 919-RACD100-48-PSE | RACD100-48-PSE | J | 48 | 0.2-1 | 34-48 | 2.1 | 100 | 89 | 71.51 | 69.46 | 61.29 | | |
| 919-RACD150-12 | RACD150-12 | J | 12 | 0-11 | 9-12 | 11 | 150 | 88 | 72.87 | 70.79 | 67.66 | | |
| ** 919-RACD150-12-PSE | RACD150-12-PSE | J | 12 | 0-11 | 9-12 | 11 | 150 | 85 | 72.87 | 70.79 | 62.46 | | |
| ** 919-RACD150-24-PSE | RACD150-24-PSE | J | 24 | 0-6.3 | 14-24 | 6.3 | 150 | 87 | 72.87 | 70.79 | 62.46 | | |
| 919-RACD150-36 | RACD150-36 | J | 36 | 0-4.2 | 26-36 | 4.2 | 150 | 90 | 72.87 | 70.79 | 67.66 | | |
| ** 919-RACD150-36-PSE | RACD150-36-PSE | J | 36 | 0-4.2 | 26-36 | 4.2 | 150 | 90 | 72.87 | 70.79 | 62.46 | | |
| ** 919-RACD150-48-PSE | RACD150-48-PSE | J | 48 | 0-3.2 | 34-48 | 3.2 | 150 | 90 | 72.87 | 70.79 | 62.46 | | |

High Output Voltage and Constant Current Operation

For quantities greater than listed, call for quote.

| MOUSER STOCK NO. | Recom Part No. | Fig. | Input Range (VAC) | Output Voltage (VDC) | Output Current (mA) | Power (W) | Efficiency (%) | Price Each | | | |
|-------------------|----------------|------|-------------------|----------------------|---------------------|-----------|----------------|------------|-------|-------|-------|
| | | | | | | | | 1 | 2 | 5 | 10 |
| 919-RACD150-1050A | RACD150-1050A | K | 90-305 | 60-143 | 1050 | 147 | 92 | 90.74 | 89.43 | 88.00 | 85.24 |
| 919-RACD150-1400A | RACD150-1400A | K | 90-305 | 60-107 | 1400 | ±150 | 91 | 90.74 | 89.43 | 88.00 | 85.24 |
| 919-RACD150-700A | RACD150-700A | K | 90-305 | 60-210 | 700 | ±150 | 92 | 90.74 | 89.43 | 88.00 | 85.24 |

Potentiometer for RACDxx Series Driver

For quantities greater than listed, call for quote.

| MOUSER STOCK NO. | Recom Part No. | Fig. | Input Voltage (VAC) | Output Current (mA) | Output Power (W) | Price Each | | |
|------------------|----------------|------|---------------------|---------------------|------------------|------------|-------|-------|
| | | | | | | 1 | 5 | 10 |
| 919-REPOT01-10 | REPOT01-10 | L | 230 | 40 | 40 | 45.87 | 44.56 | 42.59 |

High Power DC/DC LED Drivers

* M = Metal case

For quantities greater than listed, call for quote.

| MOUSER STOCK NO. | Recom Part No. | Fig. | Input Range (VDC) | Output Current (mA) | Output Voltage (V _{Min} -V _{Max}) (VDC) | Power (W) | Price Each | | |
|----------------------|------------------|------|-------------------|---------------------|--|-----------|------------|-------|-------|
| | | | | | | | 1 | 5 | 10 |
| 919-RCD-24-0.30 | RCD-24-0.30 | M | 4.5-36 | 300 | 2-35 | 11 | 13.46 | 12.79 | 12.11 |
| 919-RCD-24-0.35 | RCD-24-0.35 | M | 4.5-36 | 350 | 2-35 | 12 | 10.30 | 9.79 | 9.27 |
| 919-RCD-24-0.35/PLB | RCD-24-0.35/PLB | N | 4.5-36 | 350 | 2-35 | 12 | 12.88 | 12.24 | 11.59 |
| 919-RCD-24-0.35/W | RCD-24-0.35/W | M | 4.5-36 | 350 | 2-35 | 12 | 15.08 | 14.33 | 13.57 |
| 919-RCD-24-0.35/W/X1 | RCD-24-0.35/W/X1 | M | 4.5-36 | 350 | 2-35 | 12 | 16.02 | 15.22 | 14.42 |
| 919-RCD-24-0.50 | RCD-24-0.50 | M | 4.5-36 | 500 | 2-35 | 18 | 14.50 | 13.78 | 13.05 |
| 919-RCD-24-0.70 | RCD-24-0.70 | M | 4.5-36 | 700 | 2-35 | 25 | 11.90 | 11.30 | 10.70 |
| 919-RCD-24-0.70/W | RCD-24-0.70/W | M | 4.5-36 | 700 | 2-35 | 25 | 17.62 | 16.74 | 15.86 |
| 919-RCD-24-1.00 | RCD-24-1.00 | M | 6-36 | 1000 | 3-33 | 31 | 14.44 | 13.71 | 12.99 |
| 919-RCD-24-1.00/W/X1 | RCD-24-1.00/W/X1 | M | 6-36 | 1000 | 3-33 | 33 | 20.84 | 19.74 | 18.65 |
| 919-RCD-24-1.20 | RCD-24-1.20 | M | 6-36 | 1200 | 3-33 | 37 | 15.32 | 14.55 | 13.78 |
| 919-RCD-24-1.00/PLA | RCD-24-1.00/PLA | M | 6-36 | 1000 | 2-35 | 32 | 15.66 | 14.88 | 14.09 |
| 919-RCD-48-0.35 | RCD-48-0.35 | M | 9-60 | 350 | 2-56 | 70 | 17.92 | 17.03 | 16.13 |
| 919-RCD-48-0.35/W | RCD-48-0.35/W | M | 9-60 | 350 | 2-56 | 20 | 18.98 | 18.03 | 17.08 |
| 919-RCD-48-0.50 | RCD-48-0.50 | M | 9-60 | 500 | 2-56 | 28 | 19.12 | 18.17 | 17.21 |
| 919-RCD-48-0.70 | RCD-48-0.70 | M | 9-60 | 700 | 2-56 | 39 | 19.70 | 18.72 | 17.73 |
| 919-RCD-48-0.70/W | RCD-48-0.70/W | M | 9-60 | 700 | 2-56 | 39 | 19.84 | 18.79 | 17.75 |
| * 919-RCD-48-1.20/M | RCD-48-1.20/M | M | 9-60 | 1200 | 2-56 | 67 | 24.85 | 23.54 | 22.24 |

Constant Current Buck-Boost LED Drivers

For quantities greater than listed, call for quote.

| MOUSER STOCK NO. | Recom Part No. | Fig. | Input Voltage (VAC) | Power Consumption (Typ.) | Power Consumption (mA) (Max.) | Diming Output | Price Each | | | |
|-------------------|----------------|------|---------------------|--------------------------|-------------------------------|---------------|------------|-------|-------|-------|
| | | | | | | | 1 | 2 | 5 | 10 |
| 919-RBD-12-0.35 | RBD-12-0.35 | O | 8-36 | | 350 | 2-40 | 14 | 26.87 | 25.45 | 24.04 |
| 919-RBD-12-0.35/W | RBD-12-0.35/W | O | 8-36 | | 350 | 2-40 | 20 | 27.91 | 26.44 | 24.97 |
| 919-RBD-12-0.50 | RBD-12-0.50 | O | 8-36 | | 500 | 2-40 | 20 | 28.08 | 26.60 | 25.13 |
| 919-RBD-12-0.50/W | RBD-12-0.50/W | O | 8-36 | | 500 | 2-40 | 20 | 29.13 | 27.59 | 26.06 |

REL-D01/R Converter AC/DC DALI Converter

For quantities greater than listed, call for quote.

| MOUSER STOCK NO. | Recom Part No. | Fig. | Input Voltage (VAC) | Power Consumption (Typ.) | Power Consumption (mA) (Max.) | Diming Output | Price Each | | | |
|------------------|----------------|------|---------------------|--------------------------|-------------------------------|---------------------------|------------|-------|-------|-------|
| | | | | | | | 1 | 2 | 5 | 10 |
| 919-RELI-DA01/R | RELI-DA01/R | P | 90-264 | 1.6 | 2 | PWM or DC 0-10V, DC 1-10V | 43.22 | 41.82 | 38.99 | 38.70 |

RECOM Power
Power Supplies

