



Positronic Industries
connectpositronic.com

MILITARY QUALITY, REMOVABLE CONTACT, HIGH DENSITY SUBMINIATURE-D CONNECTORS

D-Sub

FOR MILITARY AND SEVERE INDUSTRIAL ENVIRONMENTAL APPLICATIONS

Size 22 Signal and
Thermocouple Contacts,
Removable Crimp and
Printed Board Mount

Military/Industrial
Quality Connectors

MIL-DTL-24308 and MIL-C-39029

U.L. Recognized
File #E49351

CSA Recognized
File #LR54219

Telecommunication
U.L. File #14098



DD SERIES

Densi-D Series connectors are Military/Industrial quality, high density rectangular connectors designed for use in sheltered, mildly corrosive environments having a wide range of temperature, pressure and humidity changes. These crimp removable contact connectors are qualified to MIL-DTL-24308 and MIL-C-39029.

Densi-D Series connectors utilize precision machined contacts with closed barrel crimp terminations, solder cup terminations, straight and 90° printed board mount. All female contacts are of closed entry design, featuring a fluted stainless steel shroud.

Six standard contact variants are arranged in arrangements of 15, 26, 44, 62, 78 and 104 contacts. Densi-D Series connectors are mateable

and compatible with other high density D-Subminiature connectors conforming to MIL-DTL-24308.

A wide assortment of mounting spacers, cable support hoods and locking systems is available from stock.



Contact Technical
Sales for details.

DENSI-D SERIES TECHNICAL CHARACTERISTICS

MATERIALS AND FINISHES:

Insulators:	Glass filled polyester per MIL-M-24519, UL 94V-0, blue color.
Contacts:	Male contacts – precision machined high tensile copper alloy. Female contacts – precision machined high tensile copper alloy with stainless steel shroud.
Contact Plating:	Military performance – 0.000050 inch [1.27 microns] gold over copper plate. Industrial performance – gold flash over nickel plate. Other finishes available upon request.
Shells:	Steel with tin plate; zinc and cadmium plate with dichromate seal, stainless steel, passivated. Other materials and finishes available upon request.
Mounting Spacers:	Nylon plastic and brass; zinc plate with dichromate seal.
Push-On Fastener:	Phosphor bronze or beryllium copper with tin plate.
Vibration Lock Systems:	Slide lock and lock tabs, steel with nickel plate.
Jackscrew Systems:	Steel with zinc plate and dichromate seal, or clear zinc plate.
Hoods:	Thermoplastic UL 94V-0. Composite, brass or steel with zinc plate and dichromate seal.

ELECTRICAL CHARACTERISTICS:

Contact Current Rating:	5 amperes nominal.
Initial Contact Resistance:	0.005 ohms maximum.
Proof Voltage:	1000 V r.m.s.
Insulator Resistance:	5 G ohms.
Clearance and Creepage Distance [minimum]:	0.042 inch [1.06mm].
Working Voltage:	300 V r.m.s.

CLIMATIC CHARACTERISTICS:

Temperature Range:	-55°C to +125°C.
Damp Heat, Steady State:	21 days.

MECHANICAL CHARACTERISTICS:

Removable Contacts:	Insert contact to rear face of insulator and release from rear face of insulator. Size 22 contacts, male – 0.030 inch [0.76mm] diameter; female – closed entry design with stainless steel shroud.
Contact Retention In Insulator:	9 lbs. [40 N].
Contact Terminations:	Closed barrel crimp, wire sizes 22 AWG [0.3mm ²] through 30 AWG [0.05mm ²] per IEC 352-2.
Shells:	90° Printed Board Mount contact terminations. Male shells may be dimpled for EMI/ESD ground paths.
Polarization:	Trapezoidally shaped shells and polarized jackscrews.
Mounting To Angle Brackets:	Jackscrews and riveted fasteners with 0.120 inch [3.05mm] clearance hole, and threaded riveted fasteners with 4-40 threads and nylon lock inserts.
Mounting To Printed Board:	Rapid installation push-on fasteners and mounting posts.
Locking Systems:	Jackscrews and vibration locking systems.
Mechanical Operations:	1000 operations minimum per IEC 512-5.

THERMOCOUPLE CONTACTS:

Size 22 crimp contacts are available, see page 49 for details. PCB mount contacts are available, please contact Technical Sales for details.



CONTACT VARIANTS

FACE VIEW OF MALE OR REAR VIEW OF FEMALE

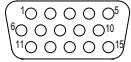

DD 15

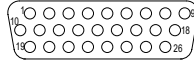

DD 26

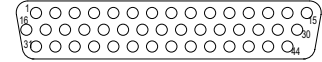

DD 44

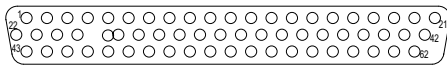

DD 62

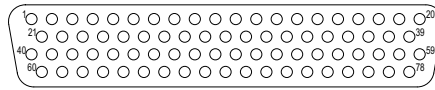

DD 78

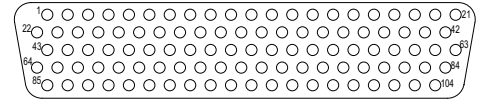

DD 104

STANDARD SHELL ASSEMBLY

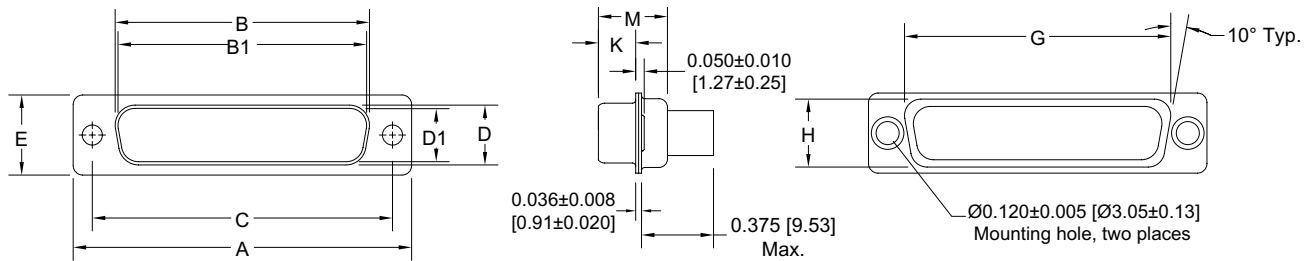

OPTIONAL SHELL ASSEMBLY [0, 02]

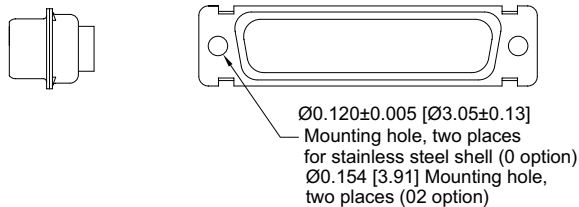

OPTIONAL SHELL ASSEMBLY WITH UNIVERSAL FLOAT MOUNTS [F]

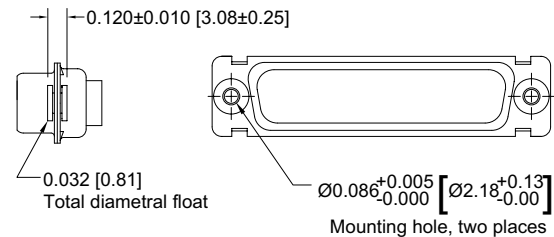

CONNECTOR VARIANT SIZES	A ±0.015 [0.38]	B ±0.005 [0.13]	B1 ±0.005 [0.13]	C ±0.005 [0.13]	D ±0.005 [0.13]	D1 ±0.005 [0.13]	E ±0.015 [0.38]	G ±0.010 [0.25]	H ±0.010 [0.25]	K ±0.005 [0.13]	M ±0.010 [0.25]
DD 15 M	1.213 [30.81]		0.666 [16.92]	0.984 [24.99]		0.329 [8.36]	0.494 [12.55]	0.759 [19.28]	0.422 [10.72]	0.233 [5.92]	0.422 [10.72]
DD 15 F	1.213 [30.81]	0.643 [16.33]		0.984 [24.99]	0.311 [7.90]		0.494 [12.55]	0.759 [19.28]	0.422 [10.72]	0.243 [6.17]	0.429 [10.90]
DD 26 M	1.541 [39.14]		0.994 [25.25]	1.312 [33.32]		0.329 [8.36]	0.494 [12.55]	1.083 [27.51]	0.422 [10.72]	0.233 [5.92]	0.422 [10.72]
DD 26 F	1.541 [39.14]	0.971 [24.66]		1.312 [33.32]	0.311 [7.90]		0.494 [12.55]	1.083 [27.51]	0.422 [10.72]	0.243 [6.17]	0.429 [10.90]
DD 44 M	2.088 [53.04]		1.534 [38.96]	1.852 [47.04]		0.329 [8.36]	0.494 [12.55]	1.625 [41.28]	0.422 [10.72]	0.230 [5.84]	0.426 [10.82]
DD 44 F	2.088 [53.04]	1.511 [38.38]		1.852 [47.04]	0.311 [7.90]		0.494 [12.55]	1.625 [41.28]	0.422 [10.72]	0.243 [6.17]	0.429 [10.90]
DD 62 M	2.729 [69.32]		2.182 [55.42]	2.500 [63.50]		0.329 [8.36]	0.494 [12.55]	2.272 [57.71]	0.422 [10.72]	0.230 [5.84]	0.426 [10.82]
DD 62 F	2.729 [69.32]	2.159 [54.84]		2.500 [63.50]	0.311 [7.90]		0.494 [12.55]	2.272 [57.71]	0.422 [10.72]	0.243 [6.17]	0.429 [10.90]
DD 78 M	2.635 [66.93]		2.079 [52.81]	2.406 [61.11]		0.441 [11.20]	0.605 [15.37]	2.178 [55.32]	0.534 [13.56]	0.230 [5.84]	0.426 [10.82]
DD 78 F	2.635 [66.93]	2.064 [52.43]		2.406 [61.11]	0.423 [10.74]		0.605 [15.37]	2.178 [55.32]	0.534 [13.56]	0.243 [6.17]	0.429 [10.90]
DD 104 M	2.729 [69.32]		2.212 [56.18]	2.500 [63.50]		0.503 [12.78]	0.668 [16.97]	2.302 [58.47]	0.596 [15.14]	0.230 [5.84]	0.426 [10.82]
DD 104 F	2.729 [69.32]	2.189 [55.60]		2.500 [63.50]	0.485 [12.32]		0.668 [16.97]	2.302 [58.47]	0.596 [15.14]	0.243 [6.17]	0.429 [10.90]



Positronic Industries
connectpositronic.com

MILITARY QUALITY, REMOVABLE CONTACT, HIGH DENSITY SUBMINIATURE-D CONNECTORS

FOR MILITARY AND SEVERE INDUSTRIAL ENVIRONMENTAL APPLICATIONS

D-Sub

CRIMP CONTACTS CLOSED CRIMP BARREL

FEMALE CONTACT "CLOSED ENTRY" DESIGN

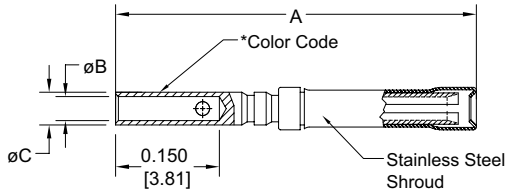

Part Number: FC8122D

MALE CONTACT

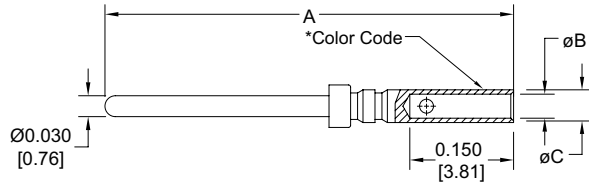

Part Number: MC8022D

Crimp contacts may be supplied kitted with connector or ordered separately.

PART NUMBER	WIRE SIZE AWG/[mm ²]	A	ØB	ØC
FC8022D	22 / 24 / 26 / 28 / 30 [0.3/0.25/0.12/0.08/0.05]	0.518 [13.16]	0.035 [0.89]	0.047 [1.19]
*M39029/57-354	22 / 24 / 26 / 28 [0.3/0.25/0.12/0.08]	0.518 [13.16]	0.035 [0.89]	0.047 [1.19]

Material - Leaded nickel copper.

Plating - Gold flash over nickel or 0.000050 inch [1.27µ] gold over copper for military specification contacts.

*Color Code - ORANGE/GREEN/YELLOW for military specification contacts.

PART NUMBER	WIRE SIZE AWG/[mm ²]	A	ØB	ØC
MC8022D	22 / 24 / 26 / 28 / 30 [0.3/0.25/0.12/0.08/0.05]	0.531 [13.49]	0.035 [0.89]	0.047 [1.19]
*M39029/58-360	22 / 24 / 26 / 28 [0.3/0.25/0.12/0.08]	0.531 [13.49]	0.035 [0.89]	0.047 [1.19]

Material - Brass.

Plating - Gold flash over nickel or 0.000050 inch [1.27µ] gold over copper for military specification contacts.

*Color Code - ORANGE/BLUE/BLACK for military specification contacts.

For contact crimp tool information see page 54.

Additional plating options available by adding suffix to part number

add -14 for 0.000030 [0.76 microns] gold over nickel

Example: FC8022D-14

add -50 for 0.000050 [1.27 microns] gold over copper

Example: MC8022D-50

FEMALE CONTACT

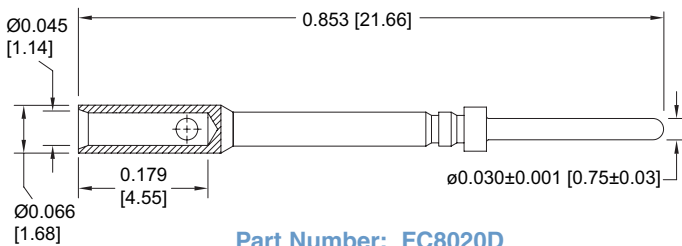

Part Number: FC8020D

MALE CONTACT

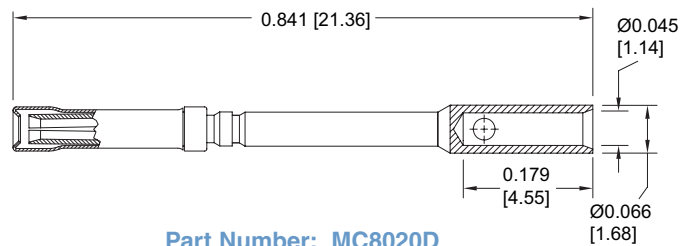

Part Number: MC8020D

Crimp area extends above connector molding.

Crimp contacts may be supplied kitted with connector or ordered separately.

PART NUMBER	WIRE SIZE AWG/[mm ²]	A	ØB	ØC
FC8020D	20 [0.5] max	0.852 [21.64]	0.045 [1.14]	0.066 [1.68]

Material - Phosphor bronze

Plating - Gold flash over nickel

PART NUMBER	WIRE SIZE AWG/[mm ²]	A	ØB	ØC
MC8020D	20 [0.5] max	0.853 [21.66]	0.045 [1.14]	0.066 [1.68]

Material - Brass

Plating - Gold flash over nickel

Additional plating options available by adding suffix to part number

add -14 for 0.000030 [0.76 microns] gold over nickel

Example: FC8120D-14 or MC8020D-14

Thermocouple contacts are available, see page 49

DD SERIES



REELS FOR AUTOMATIC PNEUMATIC CRIMP TOOLS

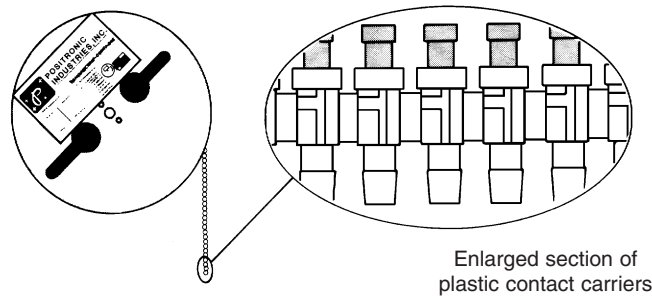

Contacts may be supplied in plastic carriers, packaged in reels holding 2,000 contacts for use with the automatic pneumatic crimp tools, catalog part number 9550-1. The same type carrier is used for both male and female contacts.

All male and female crimp contacts can be ordered in reels by adding letter "R" after the contact part number, such as MC8022DR for a male contact and FC8022DR for a female contact.

SOLDER CUP CONTACTS

FEMALE CONTACT
"CLOSED ENTRY" DESIGN

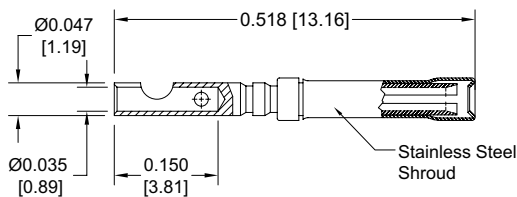

Part Number: FS8022D

Material - Phosphor bronze.
Plating - Gold flash over nickel.

MALE CONTACT

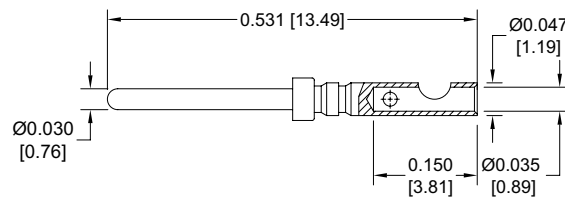

Part Number: MS8022D

Material - Brass.
Plating - Gold flash over nickel.

Solder contacts may be supplied kitted with connector or ordered separately.



SIZE 22 CRIMP THERMOCOUPLE CONTACTS

22 AWG [0.3mm²]

MALE CONTACT

FEMALE CONTACT

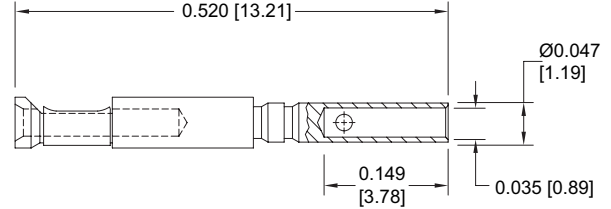
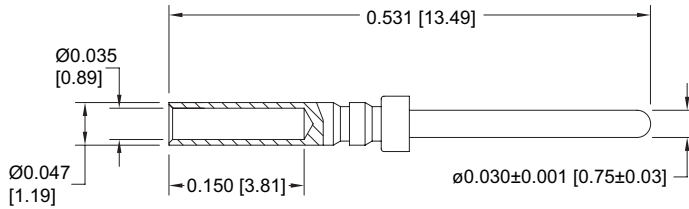

TYPE	MATERIAL	MALE PART NUMBER	FEMALE PART NUMBER	COLOR CODE	WIRE SIZE AWG [mm ²]
K	CHROMEL (+)	MC8022DCH	FC8022DCH	WHITE	22 / 24 / 26 [0.3 / 0.25 / 0.12]
	ALUMEL (-)	MC8022DAL	FC8022DAL	GREEN	22 / 24 / 26 [0.3 / 0.25 / 0.12]
T	COPPER (+)	MC8022DCU	FC8022DCU	RED	22 / 24 / 26 [0.3 / 0.25 / 0.12]
	CONSTANTAN (-)	MC8022DCO	FC8022DCO	YELLOW	22 / 24 / 26 [0.3 / 0.25 / 0.12]
E	CHROMEL (+)	MC8022DCH	FC8022DCH	WHITE	22 / 24 / 26 [0.3 / 0.25 / 0.12]
	CONSTANTAN (-)	MC8022DCO	FC8022DCO	YELLOW	22 / 24 / 26 [0.3 / 0.25 / 0.12]

Chromel® and Alumel® are registered trademarks of Hoskins Manufacturing Company

For more information on the availability of Type J thermocouple contacts, please contact Technical Sales.

For more information about thermocouple contacts with PCB solder termination, please contact Technical Sales.

See page 54 for Crimp Tool information.





STRAIGHT PRINTED BOARD MOUNT CONTACTS

FEMALE CONTACT
"CLOSED ENTRY" DESIGN

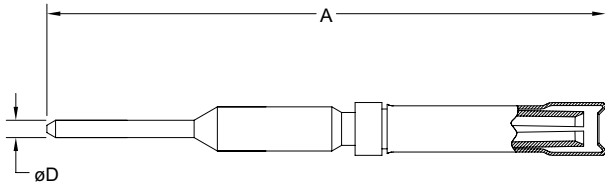

MALE CONTACT

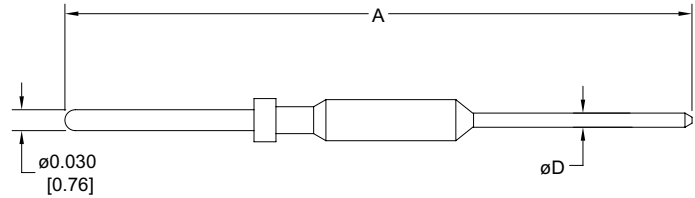

Straight printed board mount contacts are supplied in connector.

CODE NUMBER	L	ØD	A
3	0.150 [3.81]	0.020 [0.51]	0.725 [18.42]
32	0.300 [7.62]	0.020 [0.51]	0.865 [21.97]

For straight printed board mount contacts specify code no. in step 4 of ordering information.

CODE NUMBER	L	ØD	A
3	0.150 [3.81]	0.020 [0.51]	0.737 [18.72]
32	0.300 [7.62]	0.020 [0.51]	0.877 [22.28]

Material – Phosphor bronze or brass.
Plating – Gold flash over nickel.

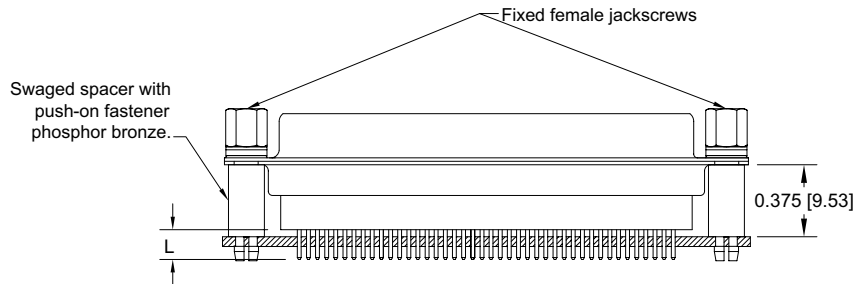

Typical Part Number: DD62F3S60T2X

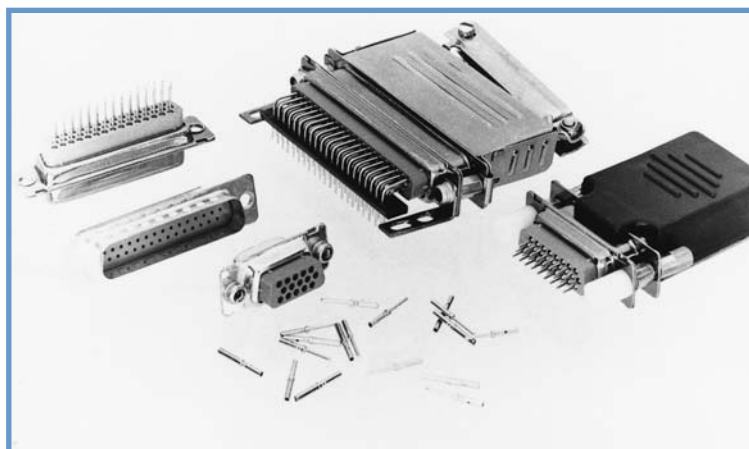



Positronic Industries
connectpositronic.com

MILITARY QUALITY, REMOVABLE CONTACT, HIGH DENSITY SUBMINIATURE-D CONNECTORS

FOR MILITARY AND SEVERE INDUSTRIAL ENVIRONMENTAL APPLICATIONS

D-Sub

DD SERIES

90° PRINTED BOARD MOUNT CONNECTOR CODE 4, 0.450 [11.43] CONTACT EXTENSION

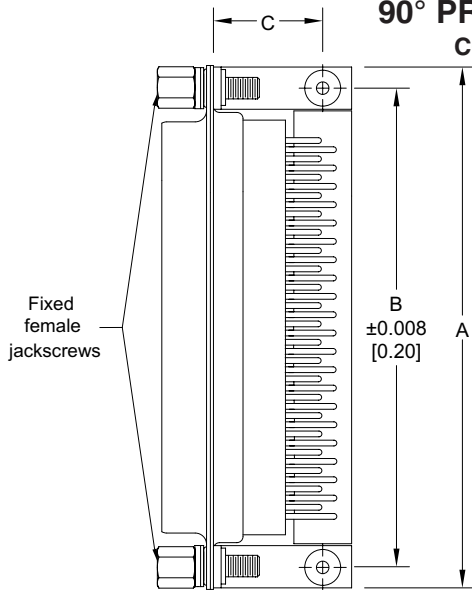

DD**4R7000 0.450 [11.43] CONTACT EXTENSION				
PART NUMBER	A	B	C	D
DD15*4R7***	1.204 [30.58]	0.984 [24.99]	0.528 [13.41]	0.450 [11.43]
DD26*4R7***	1.532 [38.91]	1.312 [33.32]	0.528 [13.41]	0.450 [11.43]
DD44*4R7***	2.072 [52.63]	1.852 [47.04]	0.528 [13.41]	0.450 [11.43]
DD62*4R7***	2.720 [69.09]	2.500 [63.50]	0.528 [13.41]	0.450 [11.43]
DD78*4R7***	2.626 [66.70]	2.406 [61.11]	0.573 [14.55]	0.450 [11.43]

Specify code 4
in step 4 of
ordering information

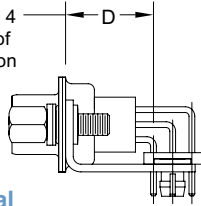

Typical
Part Number:
DD44M4R7NT2X

0.078 [1.98] Typ.
0.078 [1.98] Typ.

Numbering shown is rear view
of male and face view of female.

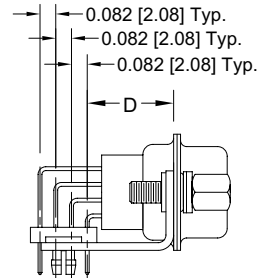
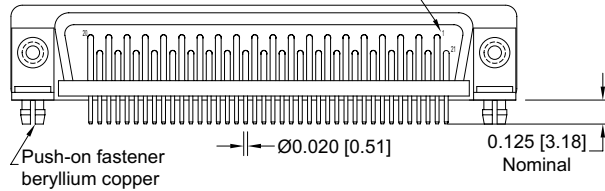

Typical Part Number:
DD78M4R7NT2X

90° PRINTED BOARD MOUNT CONNECTOR, SIZE 104 CODE 4, 0.450 [11.43] CONTACT EXTENSION

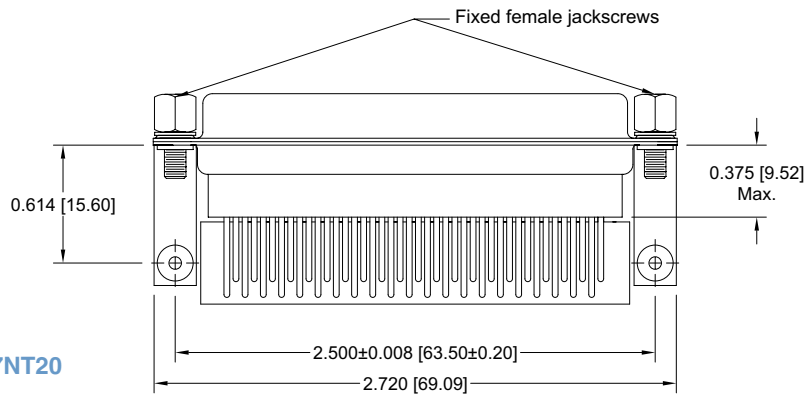

Typical Part Number: DD104M4R7NT20

Specify code 4
in step 4 of
ordering information

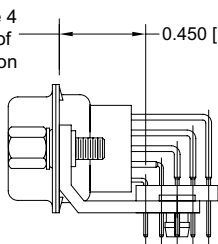

0.082 [2.08]
Typ.

Numbering
shown is rear view
of male and face view
of female

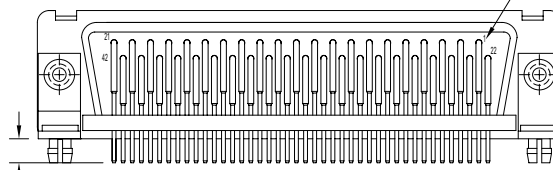

Push-on fastener
beryllium copper



90° AND STRAIGHT PRINTED BOARD
CONTACT HOLE PATTERN

Mount connector with mating face positioned to follow direction of arrows.

DD15 MALE

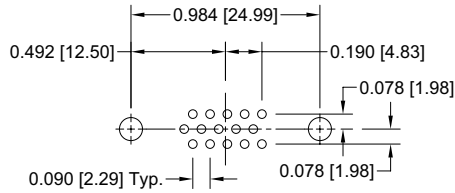

DD15 FEMALE

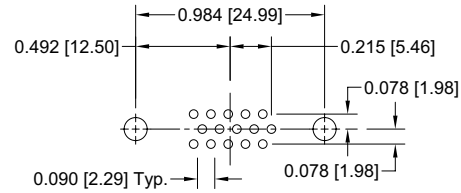

DD 26 MALE

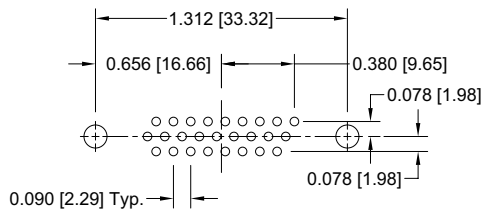

DD 26 FEMALE

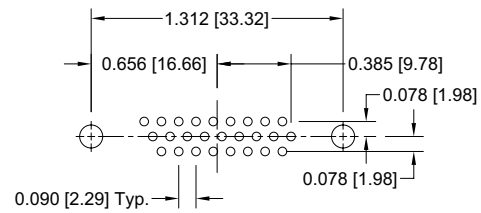

DD44 MALE

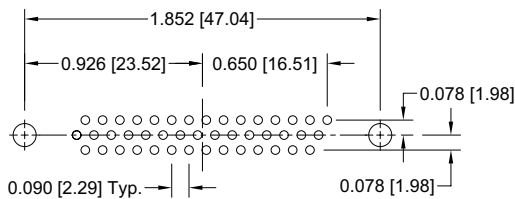

DD44 FEMALE

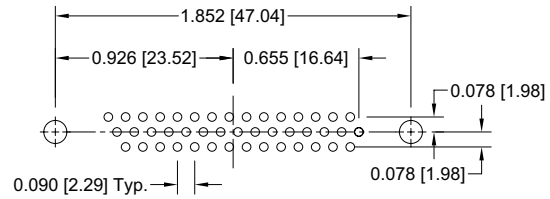

DD62 MALE

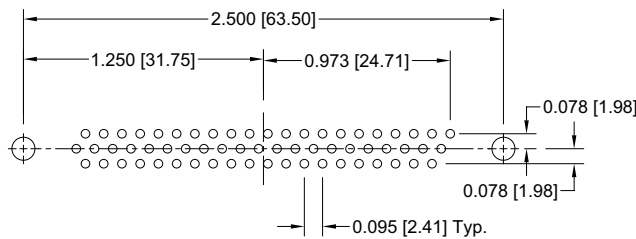

DD62 FEMALE

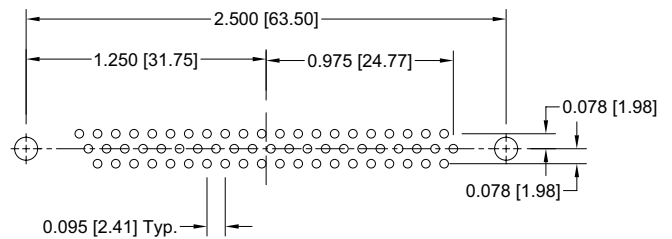

DD78 MALE

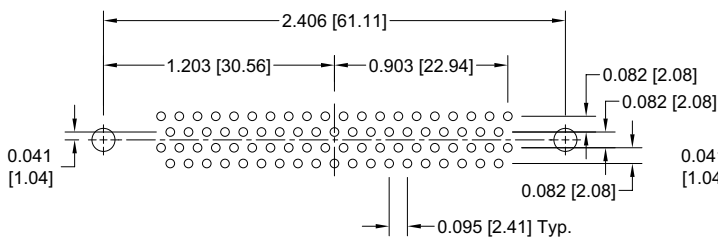

DD78 FEMALE

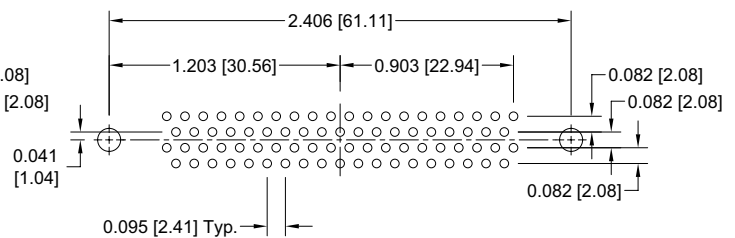

DD104 MALE

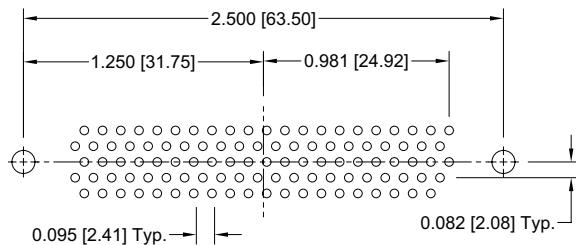

DD104 FEMALE

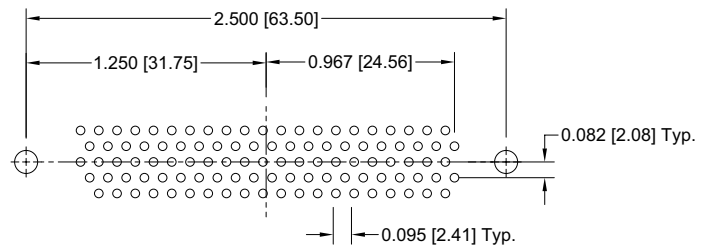

Suggest 0.035 [0.89] Ø hole for contact termination positions.
Suggest 0.123 ±0.003 [3.12 ±0.08] Ø hole for mounting connector with push-on fasteners.

DIMENSIONS ARE IN INCHES [MILLIMETERS].
ALL DIMENSIONS ARE SUBJECT TO CHANGE.



CRIMPING INFORMATION FOR DD AND ODD SERIES CRIMP CONTACTS

USE INDICATED POSITRONIC TOOLS FOR BEST RESULTS

Step 1: Strip wire to indicated length.

- Take Care Not To:
- Damage or remove strands.
 - Untwist or overtwist strands.
 - Leave insulation particles on strands.
 - Damage insulation.

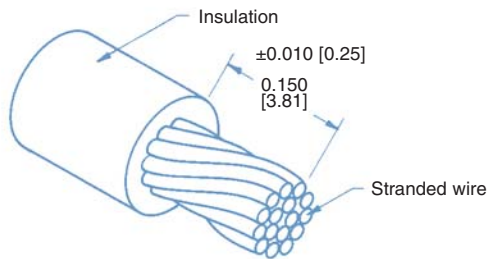

Correctly Stripped Wire

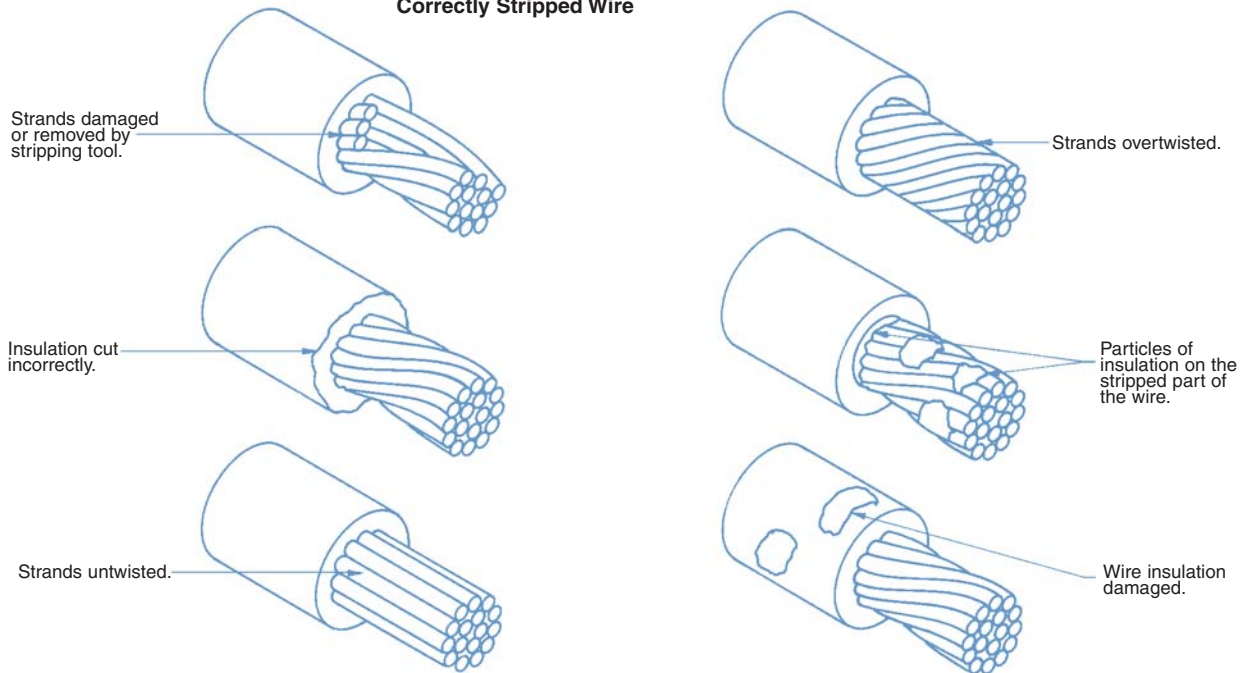

Examples of Stripping Faults

Step 2: Crimp wire to contact.

- For Hand Crimp Tool:
- Place contact into crimping tool.
 - Insert wire into contact.
 - Center contact by slowly closing the crimping tool until the crimp indenters make contact with the crimp barrel.
 - Complete the cycle of the crimping tool in one smooth motion.
 - Remove the crimped contact.

- For Automatic Pneumatic Crimp Tool:
- Insert the wire into the contact, positioned in the crimp tool by the plastic carrier.
 - Depress the activating device of the crimping tool to start the crimping cycle.
 - Remove the crimped contact.



CRIMPING INFORMATION FOR DD AND ODD CRIMP CONTACTS

Step 3: Inspect the crimp.

- For All Tools:**
- Strands to be visible through the inspection hole.
 - Strands not to be visible beyond the insulation support.
 - Crimped contact to meet recommended conductor tensile force shown in chart.
 - Check for peeled gold and bent contacts.

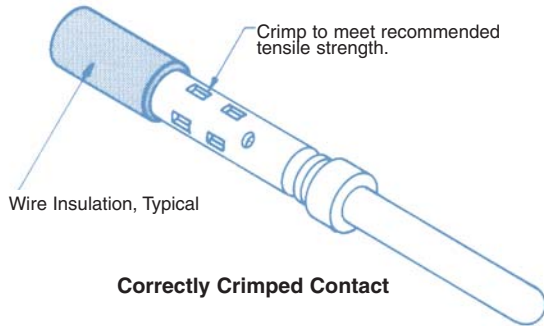

Cross Section of Correctly Crimped Contact

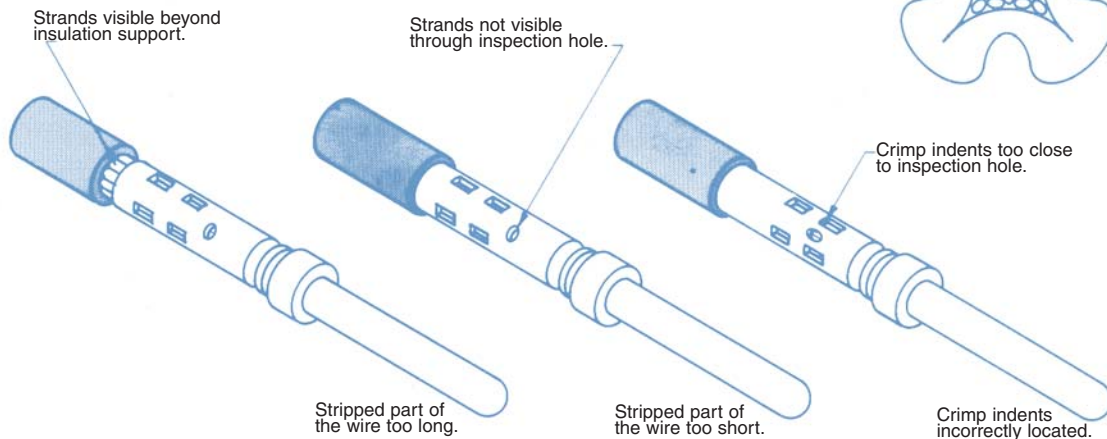
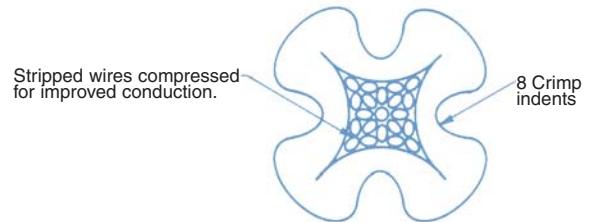

Examples of Crimping Faults

Positronic Recommended Conductor Tensile Strength					
WIRE SIZE AWG/[mm ²]	.22 [0.3]	.24 [0.25]	.26 [0.12]	.28 [0.08]	.30 [0.05]
AXIAL LOAD POUNDS/[N]	.12 [53]	.8 [36]	.5 [22]	.3 [13]	.15 [6.7]

Conductor tensile strength values are derived using silver-tin plated copper wires.

Values may change depending upon what type of wire is used.

Positronic recommended tools for DD series contacts. For more information see contact crimp tools and accessories page.		
CRIMP TOOLS	POSITIONERS FOR FC8022D	POSITIONERS FOR MC8022D
9507 HAND CRIMP TOOL	9502-3	9502-4
9550-1 AUTOMATIC PNEUMATIC CRIMP TOOL	Supplied in reels	Supplied in reels



Positronic Industries
connectpositronic.com

MILITARY QUALITY, REMOVABLE CONTACT, HIGH DENSITY SUBMINIATURE-D CONNECTORS

FOR MILITARY AND SEVERE INDUSTRIAL ENVIRONMENTAL APPLICATIONS

D-Sub

AUTOMATIC CRIMP TOOL, PNEUMATICALLY ACTUATED Part No. 9550-1

This fast cycling automatic crimp tool produces an 8 indent crimp on wire sizes 20 AWG [0.5mm²] through 32 AWG [0.03mm²]. DD Series contacts must be ordered on reels.

To order, specify part number 9550-1. Foot control valve is supplied as a standard accessory.



MINIATURE STEP ADJUSTABLE TOOL (M22520/2-01) Part No. 9507

This miniature step adjustable hand crimping tool produces an 8 indent crimp configuration and will crimp wire sizes 20 AWG [0.5mm²] through 32 AWG [0.03mm²].

To crimp FC8022D contacts, order contact positioner 9502-3. To crimp MC8022D contacts, order contact positioner 9502-4. To crimp MC8020D and FC8020D contacts, consult Technical Sales for contact positioners. Each positioner is equipped with a data plate which gives the correct crimp-depth setting for each wire size, and must be used with 9507 tool frame for best results when crimping Densi-D Series contacts.



INSERTION/REMOVAL TOOL (M81969/1-04) Part No. 4811-2

One end of this tool is used to insert contacts into Densi-D Series connectors. The other end is used to extract contacts. This is accomplished by sliding the extraction tip down the wire into the connector until it bottoms against the contact. A slight rotation while pushing will release the contacts, which are then extracted by simultaneously pulling on the wire.

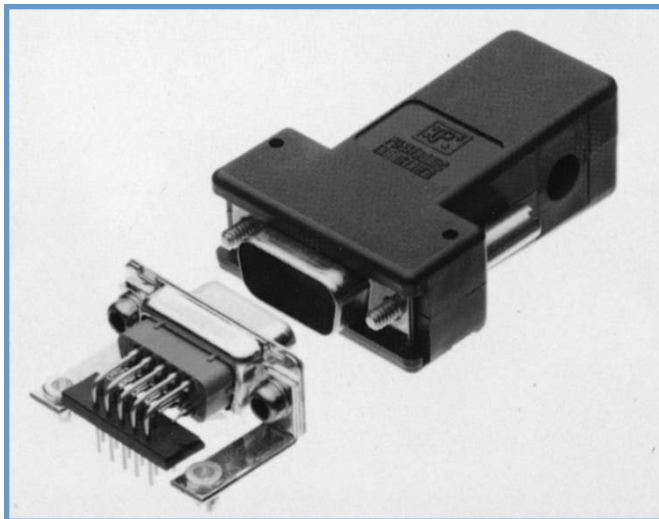

DD SERIES



ORDERING INFORMATION - CODE NUMBERING SYSTEM

Specify Complete Connector By Selecting An Option From Step 1 Through 8

STEP	1	2	3	4	5	6	7	8	9
EXAMPLE	DD	62	F	4	R7	N	T6	S	—

STEP 1 - BASIC SERIES

DD Series

STEP 2 - CONNECTOR VARIANTS

15, 26, 44, 62, 78, 104

STEP 3 - CONNECTOR GENDER

- M - Male
- F - Female

STEP 4 - CONTACT TERMINATION TYPE

- 0 - Ordered Without Contacts.
- 1 - Crimp, 22 AWG–30 AWG [0.3mm²–0.05mm²].
- 2 - Solder cup, 22 AWG–30 AWG [0.3mm²–0.05mm²].
- 3 - Solder, Straight Printed Board Mount with 0.150 [3.81] Tail Length.
- 32 - Solder, Straight Printed Board Mount with 0.300 [7.62] Tail Length.
- 4 - Solder, 90° Printed Board Mount with 0.450 [11.43] Contact Extension.

*STEP 5 - MOUNTING STYLE

- 0 - Mounting Hole, 0.120 [3.05] Ø.
- 02 - Mounting Hole, 0.154 [3.91] Ø.
- B3 - Bracket, Mounting, 90° Metal with Cross Bar.
- B8 - Bracket, Mounting, 90° Plastic with Cross Bar.
- F - Float Mounts, Universal.
- P - Threaded Post, Brass, 0.375 [9.53] Length.
- P2 - Threaded Post, Nylon, 0.375 [9.53] Length.
- R2 - Bracket, Mounting, 90° Metal, Swaged to Connector with 4-40 Thread Fixed Female Jackscrews with Cross Bar.
- R6 - Bracket, Mounting, 90° Metal, Swaged to Connector with 0.120 [3.05] Ø Mounting Hole with Cross Bar.
- R7 - Bracket, Mounting, 90° Metal, Swaged to Connector with 4-40 Threads with Cross Bar.
- R8 - Bracket, Mounting, 90° Metal, Swaged to Connector with 4-40 Locknut with Cross Bar.
- S - Swaged Spacer, 4-40 Threads, 0.375 [9.53] Length.
- S2 - Swaged Spacer, 4-40 Threads, 0.125 [3.18] Length.
- S5 - Swaged Locknut, 4-40 Threads.
- S6 - Swaged Spacer with Push-on Fasteners, 4-40 Threads, 0.375 [9.53] Length.
- S7 - Swaged Spacer with Push-on Fastener for use with Ferrite Inductor, 4-40 Threads, 0.515 [13.08] Length.

STEP 9 - SPECIAL OPTIONS

CONTACT TECHNICAL SALES FOR ORDERING DETAILS OF THE FOLLOWING:

Other Special Requirements.
Straight and Right Angle Thermocouple
PCB mount contacts

STEP 8 - SHELL OPTIONS

- 0 - Zinc Plated with Dichromate Seal.
- S - Stainless Steel.
- X - Tin Plated.
- Z - Tin Plated and Dimpled (male connectors only).
- C - Cadmium with Dichromate Seal.

*STEP 7 - LOCKING AND POLARIZING SYSTEMS

- 0 - None.
- V3 - Lock Tab, connector front panel mounted.
- V5 - Lock Tab, connector rear panel mounted.
- VL - Lock Lever, used with Hoods only.
- T - Fixed Female Jackscrews.
- T2 - Fixed Female Jackscrews.
- T6 - Fixed Male and Female Polarized Jackscrews.
- E - Rotating Male Jackscrews.
- E2 - Rotating Male Screw Locks.
- E3 - Rotating Male with internal hex for 3/32 hex drives
- E6 - Rotating Male and Female Polarized Jackscrews.

*STEP 6 - HOODS AND PUSH-ON FASTENERS

- 0 - None.
- J - Hood, Top Opening, Plastic.
- L - Hood, Side Opening, Plastic.
- Y - Hood, Top Opening, Plastic with Rotating Male Jackscrews. Available in size 78 and 104 only.
- Y6 - Hood, Top Opening, Plastic with Rotating Male and Female Polarized Jackscrews. Available in size 78 and 104 only.
- Z - Hood, Top or Side Opening, Robust and Extended Height, Composite and Plastic with Rotating Male Jackscrews. Available in size 15, 26, 44, 62, and 78 only.
- H - Hood, Top Opening, Metal. Available in size 26, 44, 62, and 78 only.
- G - Hood, EMI/RFI, Metal.
- W - Hood, Top or Side Opening, Plastic. Available in size 15, 26, and 44 only.
- N - Push-on Fastener, for 90° Mounting Brackets.
- **F - Ferrite Inductor



Contact Technical Sales for details.

*For additional information on accessories listed in steps 5, 6 and 7, see Accessory Catalog.

**Ferrite inductor is available on contact type 32 only.



***NOTE:** Parts are to be ordered to the military number,
the Positronic part number is for reference only.

Positronic Industries offers the following listing of connectors and connector accessories, which are products qualified under Military Specification MIL-DTL-24308, SAE AS 39029 and MIL-C-85049. For additional Q.P.L. connectors, please consult the factory sales office.

MILITARY PART NUMBER	REFERENCE NUMBER*	MILITARY PART NUMBER	REFERENCE NUMBER*	MILITARY PART NUMBER	REFERENCE NUMBER*	MILITARY PART NUMBER	REFERENCE NUMBER*
M24308/1-1	HDC9F20000-50	M24308/2-13F	DD44F1000C-50	M24308/2-349	DD44F1F000-50	M24308/2-519	RD37F10000-50-799.0
M24308/1-1F	HDC9F2000C-50	M24308/2-14	DD62F10000-50	M24308/2-349F	DD44F1F00C-50	M24308/2-520	RD50F10000-50-799.0
M24308/1-2	HDC15F20000-50	M24308/2-14F	DD62F1000C-50	M24308/2-350	DD62F1F000-50	M24308/2-521	RD9F10000-50-799.1
M24308/1-2F	HDC15F2000C-50	M24308/2-15	DD78F10000-50	M24308/2-350F	DD62F1F00C-50	M24308/2-522	RD15F10000-50-799.1
M24308/1-3	HDC25F20000-50	M24308/2-15F	DD78F1000C-50	M24308/2-351	DD78F1F000-50	M24308/2-523	RD25F10000-50-799.1
M24308/1-3F	HDC25F2000C-50	M24308/2-16	DD104F10000-50	M24308/2-351F	DD78F1F00C-50	M24308/2-524	RD37F10000-50-799.1
M24308/1-4	HDC37F20000-50	M24308/2-16F	DD104F1000C-50	M24308/2-352	DD104F1F000-50	M24308/2-525	RD50F10000-50-799.1
M24308/1-4F	HDC37F2000C-50	M24308/2-17	DD15F10000-50-400.1	M24308/2-352F	DD104F1F00C-50	M24308/2-526	DD15F10000-50-799.0
M24308/1-5	HDC50F20000-50	M24308/2-17F	DD15F1000C-50-400.1	M24308/2-353	RD9F1F000-50-400.0	M24308/2-527	DD26F10000-50-799.0
M24308/1-5F	HDC50F2000C-50	M24308/2-18	DD26F10000-50-400.1	M24308/2-353F	RD9F1F00C-50-400.0	M24308/2-528	DD44F10000-50-799.0
M24308/1-23	HDC9F2F000-50	M24308/2-18F	DD26F1000C-50-400.1	M24308/2-354	RD15F1F000-50-400.0	M24308/2-529	DD62F10000-50-799.0
M24308/1-23F	HDC9F2F00C-50	M24308/2-19	DD44F10000-50-400.1	M24308/2-354F	RD15F1F00C-50-400.0	M24308/2-530	DD78F10000-50-799.0
M24308/1-24	HDC15F2F000-50	M24308/2-19F	DD44F1000C-50-400.1	M24308/2-355	RD25F1F000-50-400.0	M24308/2-531	DD104F10000-50-799.0
M24308/1-24F	HDC15F2F00C-50	M24308/2-20	DD62F10000-50-400.1	M24308/2-355F	RD25F1F00C-50-400.0	M24308/2-532	DD15F10000-50-799.1
M24308/1-25	HDC25F2F000-50	M24308/2-20F	DD62F1000C-50-400.1	M24308/2-356	RD37F1F000-50-400.0	M24308/2-533	DD26F10000-50-799.1
M24308/1-25F	HDC25F2F00C-50	M24308/2-21	DD78F10000-50-400.1	M24308/2-356F	RD37F1F00C-50-400.0	M24308/2-534	DD44F10000-50-799.1
M24308/1-26	HDC37F2F000-50	M24308/2-21F	DD78F1000C-50-400.1	M24308/2-357	RD50F1F000-50-400.0	M24308/2-535	DD62F10000-50-799.1
M24308/1-26F	HDC37F2F00C-50	M24308/2-22	DD104F10000-50-400.1	M24308/2-357F	RD50F1F00C-50-400.0	M24308/2-536	DD78F10000-50-799.1
M24308/1-27	HDC50F2F000-50	M24308/2-22F	DD104F1000C-50-400.1	M24308/2-358	DD15F1F000-50-400.1	M24308/2-537	DD104F10000-50-799.1
M24308/1-27F	HDC50F2F00C-50	M24308/2-281	RD9F00000	M24308/2-358F	DD15F1F00C-50-400.1	M24308/2-560	RD9F00000-799.0
M24308/1-34	HDC9F20000-50-799.0	M24308/2-281F	RD9F0000C	M24308/2-359	DD26F1F000-50-400.1	M24308/2-561	RD15F00000-799.0
M24308/1-35	HDC15F20000-50-799.0	M24308/2-282	RD15F00000	M24308/2-359F	DD26F1F00C-50-400.1	M24308/2-562	RD25F00000-799.0
M24308/1-36	HDC25F20000-50-799.0	M24308/2-282F	RD15F0000C	M24308/2-360	DD44F1F000-50-400.1	M24308/2-563	RD37F00000-799.0
M24308/1-37	HDC37F20000-50-799.0	M24308/2-283	RD25F00000	M24308/2-360F	DD44F1F00C-50-400.1	M24308/2-564	RD50F00000-799.0
M24308/1-38	HDC50F20000-50-799.0	M24308/2-283F	RD25F0000C	M24308/2-361	DD62F1F000-50-400.1	M24308/2-565	DD15F00000-799.0
M24308/1-56	HDC9F2F000-50-799.2	M24308/2-284	RD37F00000	M24308/2-361F	DD62F1F00C-50-400.1	M24308/2-566	DD26F00000-799.0
M24308/1-57	HDC15F2F000-50-799.2	M24308/2-284F	RD37F0000C	M24308/2-362	DD78F1F000-50-400.1	M24308/2-567	DD44F00000-799.0
M24308/1-58	HDC25F2F000-50-799.2	M24308/2-285	RD50F00000	M24308/2-362F	DD78F1F00C-50-400.1	M24308/2-568	DD62F00000-799.0
M24308/1-59	HDC37F2F000-50-799.2	M24308/2-285F	RD50F0000C	M24308/2-363	DD104F1F000-50-400.1	M24308/2-569	DD78F00000-799.0
M24308/1-60	HDC50F2F000-50-799.2	M24308/2-286	DD15F00000	M24308/2-363F	DD104F1F00C-50-400.1	M24308/2-570	DD104F00000-799.0
M24308/2-1	RD9F10000-50	M24308/2-286F	DD15F0000C	M24308/2-482	RD9F0F000	M24308/2-585	RD9F1F000-50-799.2
M24308/2-1F	RD9F1000C-50	M24308/2-287	DD26F00000	M24308/2-482F	RD9F0F00C	M24308/2-586	RD15F1F000-50-799.2
M24308/2-2	RD15F10000-50	M24308/2-287F	DD26F0000C	M24308/2-483	RD15F0F000	M24308/2-587	RD25F1F000-50-799.2
M24308/2-2F	RD15F1000C-50	M24308/2-288	DD44F00000	M24308/2-483F	RD15F0F00C	M24308/2-588	RD37F1F000-50-799.2
M24308/2-3	RD25F10000-50	M24308/2-288F	DD44F0000C	M24308/2-484	RD25F0F000	M24308/2-589	RD50F1F000-50-799.2
M24308/2-3F	RD25F1000C-50	M24308/2-289	DD62F00000	M24308/2-484F	RD25F0F00C	M24308/2-590	DD15F1F000-50-799.2
M24308/2-4	RD37F10000-50	M24308/2-289F	DD62F0000C	M24308/2-485	RD37F0F000	M24308/2-591	DD26F1F000-50-799.2
M24308/2-4F	RD37F1000C-50	M24308/2-290	DD78F00000	M24308/2-485F	RD37F0F00C	M24308/2-592	DD44F1F000-50-799.2
M24308/2-5	RD50F10000-50	M24308/2-290F	DD78F0000C	M24308/2-486	RD50F0F000	M24038/2-593	DD62F1F000-50-799.2
M24308/2-5F	RD50F1000C-50	M24308/2-291	DD104F00000	M24308/2-486F	RD50F0F00C	M24308/2-594	DD78F1F000-50-799.2
M24308/2-6	RD9F10000-50-400.0	M24308/2-291F	DD104F0000C	M24308/2-487	DD15F0F000	M24308/2-595	DD104F1F000-50-799.2
M24308/2-6F	RD9F1000C-50-400.0	M24308/2-342	RD9F1F000-50	M24308/2-487F	DD15F0F00C	M24308/2-596	RD9F1F000-50-799.3
M24308/2-7	RD15F10000-50-400.0	M24308/2-342F	RD9F1F00C-50	M24308/2-488	DD26F0F000	M24308/2-597	RD15F1F000-50-799.3
M24308/2-7F	RD15F1000C-50-400.0	M24308/2-343	RD15F1F000-50	M24308/2-488F	DD26F0F00C	M24308/2-598	RD25F1F000-50-799.3
M24308/2-8	RD25F10000-50-400.0	M24308/2-343F	RD15F1F00C-50	M24308/2-489	DD44F0F000	M24308/2-599	RD37F1F000-50-799.3
M24308/2-8F	RD25F1000C-50-400.0	M24308/2-344	RD25F1F000-50	M24308/2-489F	DD44F0F00C	M24308/2-600	RD50F1F000-50-799.3
M24308/2-9	RD37F10000-50-400.0	M24308/2-344F	RD25F1F00C-50	M24308/2-490	DD62F0F000	M24308/2-601	DD15F1F000-50-799.3
M24308/2-9F	RD37F1000C-50-400.0	M24308/2-345	RD37F1F000-50	M24308/2-490F	DD62F0F00C	M24308/2-602	DD26F1F000-50-799.3
M24308/2-10	RD50F10000-50-400.0	M24308/2-345F	RD37F1F00C-50	M24308/2-491	DD78F0F000	M24308/2-603	DD44F1F000-50-799.3
M24308/2-10F	RD50F1000C-50-400.0	M24308/2-346	RD50F1F000-50	M24308/2-491F	DD78F0F00C	M24308/2-604	DD62F1F000-50-799.3
M24308/2-11	DD15F10000-50	M24308/2-346F	RD50F1F00C-50	M24308/2-492	DD104F0F000	M24308/2-605	DD78F1F000-50-799.3
M24308/2-11F	DD15F1000C-50	M24308/2-347	DD15F1F000-50	M24308/2-492F	DD104F0F00C	M24308/2-606	DD104F1F000-50-799.3
M24308/2-12	DD26F10000-50	M24308/2-347F	DD15F1F00C-50	M24308/2-516	RD9F10000-50-799.0	M24308/2-607	RD9F0F000-799.2
M24308/2-12F	DD26F1000C-50	M24308/2-348	DD26F1F000-50	M24308/2-517	RD15F10000-50-799.0	M24308/2-608	RD15F0F000-799.2
M24308/2-13	DD44F10000-50	M24308/2-348F	DD26F1F00C-50	M24308/2-518	RD25F10000-50-799.0	M24308/2-609	RD25F0F000-799.2



Positronic Industries
connectpositronic.com

MIL-DTL-24308 / SAE AS 39029 / MIL-C-85049 QUALIFIED PRODUCTS LISTING

D-Sub

***NOTE:** Parts are to be ordered to the military number, the Positronic part number is for reference only.

Positronic HDC Series connectors are Q.P.L. approved to MIL-DTL-24308 per test report number 24308-618-79/24308-1210-85.
Positronic RD Series hoods are Q.P.L. approved to MIL-C-85049 per test report number 85049-870-84.
Positronic DD Series connectors are Q.P.L. approved to MIL-DTL-24308 per test report number 24308-1209-85/24308-1210-85/24308-117-89.
Positronic RD Series connectors are Q.P.L. approved to MIL-DTL-24308 per test report number 24308-211-79/24308-1210-85.
Positronic RD Series contacts are Q.P.L. approved to SAE AS 39029 per test report number 39029-694-79.

MILITARY PART NUMBER	REFERENCE NUMBER*	MILITARY PART NUMBER	REFERENCE NUMBER*	MILITARY PART NUMBER	REFERENCE NUMBER*	MILITARY PART NUMBER	REFERENCE NUMBER*
M24308/2-610	RD37F0F000-799.2	M24308/4-3	RD25M10000-50	M24308/4-265	DD26M00000	M24308/4-347	DD44M10000-50-799.0
M24308/2-611	RD50F0F000-799.2	M24308/4-3F	RD25M1000C-50	M24308/4-265F	DD26M0000C	M24308/4-348	DD62M10000-50-799.0
M24308/2-612	DD15F0F000-799.2	M24308/4-4	RD37M10000-50	M24308/4-266	DD44M00000	M24308/4-349	DD78M10000-50-799.0
M24308/2-613	DD26F0F000-799.2	M24308/4-4F	RD37M1000C-50	M24308/4-266F	DD44M0000C	M24308/4-350	DD104M10000-50-799.0
M24308/2-614	DD44F0F000-799.2	M24308/4-5	RD50M10000-50	M24308/4-267	DD62M00000	M24308/4-351	DD15M10000-50-799.1
M24308/2-615	DD62F0F000-799.2	M24308/4-5F	RD50M1000C-50	M24308/4-267F	DD62M0000C	M24308/4-352	DD26M10000-50-799.1
M24308/2-616	DD78F0F000-799.2	M24308/4-6	RD9M10000-50-400.0	M24308/4-268	DD78M00000	M24308/4-353	DD44M10000-50-799.1
M24308/2-617	DD104F0F000-799.2	M24308/4-6F	RD9M1000C-50-400.0	M24308/4-268F	DD78M0000C	M24308/4-354	DD62M10000-50-799.1
M24308/3-1	HDC9M20000-50	M24308/4-7	RD15M10000-50-400.0	M24308/4-269	DD104M00000	M24308/4-355	DD78M10000-50-799.1
M24308/3-1F	HDC9M2000C-50	M24308/4-7F	RD15M1000C-50-400.0	M24308/4-269F	DD104M0000C	M24308/4-356	DD104M10000-50-799.1
M24308/3-2	HDC15M20000-50	M24308/4-8	RD25M10000-50-400.0	M24308/4-302	RD9M1F000-50	M24308/4-357	RD9M00000-799.0
M24308/3-2F	HDC15M2000C-50	M24308/4-8F	RD25M1000C-50-400.0	M24308/4-302F	RD9M1F00C-50	M24308/4-358	RD15M00000-799.0
M24308/3-3	HDC25M20000-50	M24308/4-9	RD37M10000-50-400.0	M24308/4-303	RD15M1F000-50	M24308/4-359	RD25M00000-799.0
M24308/3-3F	HDC25M2000C-50	M24308/4-9F	RD37M1000C-50-400.0	M24308/4-303F	RD15M1F00C-50	M24308/4-360	RD37M00000-799.0
M24308/3-4	HDC37M20000-50	M24308/4-10	RD50M10000-50-400.0	M24308/4-304	RD25M1F000-50	M24308/4-361	RD50M00000-799.0
M24308/3-4F	HDC37M2000C-50	M24308/4-10F	RD50M1000C-50-400.0	M24308/4-304F	RD25M1F00C-50	M24308/4-362	DD15M00000-799.0
M24308/3-5	HDC50M20000-50	M24308/4-11	DD15M10000-50	M24308/4-305	RD37M1F000-50	M24308/4-363	DD26M00000-799.0
M24308/3-5F	HDC50M2000C-50	M24308/4-11F	DD15M1000C-50	M24308/4-305F	RD37M1F00C-50	M24308/4-364	DD44M00000-799.0
M24308/3-12	HDC9M2F000-50	M24308/4-12	DD26M10000-50	M24308/4-306	RD50M1F000-50	M24308/4-365	DD62M00000-799.0
M24308/3-12F	HDC9M2F00C-50	M24308/4-12F	DD26M1000C-50	M24308/4-306F	RD50M1F00C-50	M24308/4-366	DD78M00000-799.0
M24308/3-13	HDC15M2F000-50	M24308/4-13	DD44M10000-50	M24308/4-313	RD9M1F000-50-400.0	M24308/4-367	DD104M00000-799.0
M24308/3-13F	HDC15M2F00C-50	M24308/4-13F	DD44M1000C-50	M24308/4-313F	RD9M1F00C-50-400.0	M24308/4-401	RD9M1F000-50-799.2
M24308/3-14	HDC25M2F000-50	M24308/4-14	DD62M10000-50	M24308/4-314	RD15M1F000-50-400.0	M24308/4-402	RD15M1F000-50-799.2
M24308/3-14F	HDC25M2F00C-50	M24308/4-14F	DD62M1000C-50	M24308/4-314F	RD15M1F00C-50-400.0	M24308/4-403	RD25M1F000-50-799.2
M24308/3-15	HDC37M2F000-50	M24308/4-15	DD78M10000-50	M24308/4-315	RD25M1F000-50-400.0	M24308/4-404	RD37M1F000-50-799.2
M24308/3-15F	HDC37M2F00C-50	M24308/4-15F	DD78M1000C-50	M24308/4-315F	RD25M1F00C-50-400.0	M24308/4-405	RD50M1F000-50-799.2
M24308/3-16	HDC50M2F000-50	M24308/4-16	DD104M10000-50	M24308/4-316	RD37M1F000-50-400.0	M24308/4-406	DD15M1F000-50-799.2
M24308/3-16F	HDC50M2F00C-50	M24308/4-16F	DD104M1000C-50	M24308/4-316F	RD37M1F00C-50-400.0	M24308/4-407	DD26M1F000-50-799.2
M24308/3-17	HDC9M2F000-50	M24308/4-17	DD15M10000-50-400.1	M24308/4-317	RD50M1F000-50-400.0	M24308/4-408	DD44M1F000-50-799.2
M24308/3-17F	HDC9M2F00C-50	M24308/4-17F	DD15M1000C-50-400.1	M24308/4-317F	RD50M1F00C-50-400.0	M24308/4-409	DD62M1F000-50-799.2
M24308/3-18	HDC15M2F000-50	M24308/4-18	DD26M10000-50-400.1	M24308/4-324	RD9M0F000	M24308/4-410	DD78M1F000-50-799.2
M24308/3-18F	HDC15M2F00C-50	M24308/4-18F	DD26M1000C-50-400.1	M24308/4-324F	RD9M0F00C	M24308/4-411	DD104M1F000-50-799.2
M24308/3-19	HDC25M2F000-50	M24308/4-19	DD44M10000-50-400.1	M24308/4-325	RD15M0F000	M24308/4-412	RD9M1F000-50-799.3
M24308/3-19F	HDC25M2F00C-50	M24308/4-19F	DD44M1000C-50-400.1	M24308/4-325F	RD15M0F00C	M24308/4-413	RD15M1F000-50-799.3
M24308/3-20	HDC37M2F000-50	M24308/4-20	DD62M10000-50-400.1	M24308/4-326	RD25M0F000	M24308/4-414	RD25M1F000-50-799.3
M24308/3-20F	HDC37M2F00C-50	M24308/4-20F	DD62M1000C-50-400.1	M24308/4-326F	RD25M0F00C	M24308/4-415	RD37M1F000-50-799.3
M24308/3-21	HDC50M2F000-50	M24308/4-21	DD78M10000-50-400.1	M24308/4-327	RD37M0F000	M24308/4-416	RD50M1F000-50-799.3
M24308/3-21F	HDC50M2F00C-50	M24308/4-21F	DD78M1000C-50-400.1	M24308/4-327F	RD37M0F00C	M24308/4-417	DD15M1F000-50-799.3
M24308/3-23	HDC9M20000-50-799.0	M24308/4-22	DD104M10000-50-400.1	M24308/4-328	RD50M0F000	M24308/4-418	DD26M1F000-50-799.3
M24308/3-24	HDC15M20000-50-799.0	M24308/4-22F	DD104M1000C-50-400.1	M24308/4-328F	RD50M0F00C	M24308/4-419	DD44M1F000-50-799.3
M24308/3-25	HDC25M20000-50-799.0	M24308/4-259	RD9M00000	M24308/4-335	RD9M10000-50-799.0	M24308/4-420	DD62M1F000-50-799.3
M24308/3-26	HDC37M20000-50-799.0	M24308/4-259F	RD9M0000C	M24308/4-336	RD15M10000-50-799.0	M24308/4-421	DD78M1F000-50-799.3
M24308/3-27	HDC50M20000-50-799.0	M24308/4-260	RD15M00000	M24308/4-337	RD25M10000-50-799.0	M24308/4-422	DD104M1F000-50-799.3
M24308/3-39	HDC9M2F000-50-799.2	M24308/4-260F	RD15M0000C	M24308/4-338	RD37M10000-50-799.0	M24308/4-423	RD9M0F000-799.2
M24308/3-40	HDC15M2F000-50-799.2	M24308/4-261	RD25M00000	M24308/4-339	RD50M10000-50-799.0	M24308/4-424	RD15M0F000-799.2
M24308/3-41	HDC25M2F000-50-799.2	M24308/4-261F	RD25M0000C	M24308/4-340	RD9M10000-50-799.1	M24308/4-425	RD25M0F000-799.2
M24308/3-42	HDC37M2F000-50-799.2	M24308/4-262	RD37M00000	M24308/4-341	RD15M10000-50-799.1	M24308/4-426	RD37M0F000-799.2
M24308/3-43	HDC50M2F000-50-799.2	M24308/4-262F	RD37M0000C	M24308/4-342	RD25M10000-50-799.1	M24308/4-427	RD50M0F000-799.2
M24308/4-1	RD9M10000-50	M24308/4-263	RD50M00000	M24308/4-343	RD37M10000-50-799.1	M24308/4-428	DD15M0F000-799.2
M24308/4-1F	RD9M1000C-50	M24308/4-263F	RD50M0000C	M24308/4-344	RD50M10000-50-799.1	M24308/4-429	DD26M0F000-799.2
M24308/4-2	RD15M10000-50	M24308/4-264	DD15M00000	M24308/4-345	DD15M10000-50-799.0	M24308/4-430	DD44M0F000-799.2
M24308/4-2F	RD15M1000C-50	M24308/4-264F	DD15M0000C	M24308/4-346	DD26M10000-50-799.0	M24308/4-431	DD62M0F000-799.2

MIL LISTING



***NOTE:** Parts are to be ordered to the military number, the Positronic part number is for reference only.

Positronic HDC Series connectors are Q.P.L. approved to MIL-DTL-24308 per test report number 24308-618-79/24308-1210-85.
 Positronic RD Series hoods are Q.P.L. approved to MIL-C-85049 per test report number 85049-870-84.
 Positronic DD Series connectors are Q.P.L. approved to MIL-DTL-24308 per test report number 24308-1209-85/24308-1210-85/24308-117-89.
 Positronic RD Series connectors are Q.P.L. approved to MIL-DTL-24308 per test report number 24308-211-79/24308-1210-85.
 Positronic RD Series contacts are Q.P.L. approved to SAE AS 39029 per test report number 39029-694-79.

MILITARY PART NUMBER	REFERENCE NUMBER*	MILITARY PART NUMBER	REFERENCE NUMBER*	MILITARY PART NUMBER	REFERENCE NUMBER*	MILITARY PART NUMBER	REFERENCE NUMBER*
M24308/4-432	DD78M0F000-799.2	M24308/4-460	RD37M0F000	M24308/5-57	HDC15F2F000-50-403.4	M24308/6-17	DD15F10000-50-403.2
M24308/4-433	DD104M0F000-799.2	M24308/4-460F	RD37M0F00C	M24308/5-58	HDC25F2F000-50-403.4	M24308/6-17F	DD15F1000C-50-403.2
M24308/4-435	RD9M1F000-50	M24308/4-461	RD50M0F000	M24308/5-59	HDC37F2F000-50-403.4	M24308/6-17P	DD15F1000S-50-400.1
M24308/4-435F	RD9M1F00C-50	M24308/4-461F	RD50M0F00C	M24308/5-60	HDC50F2F000-50-403.4	M24308/6-18	DD26F10000-50-403.2
M24308/4-436	RD15M1F000-50	M24308/4-462	DD15M0F000	M24308/6-1	RD9F10000-50-403.0	M24308/6-18F	DD26F1000C-50-403.2
M24308/4-436F	RD15M1F00C-50	M24308/4-462F	DD15M0F00C	M24308/6-1F	RD9F1000C-50-403.0	M24308/6-18P	DD26F1000S-50-400.1
M24308/4-437	RD25M1F000-50	M24308/4-463	DD26M0F000	M24308/6-1P	RD9F1000S-50	M24308/6-19	DD44F10000-50-403.2
M24308/4-437F	RD25M1F00C-50	M24308/4-463F	DD26M0F00C	M24308/6-2	RD15F10000-50-403.0	M24308/6-19F	DD44F1000C-50-403.2
M24308/4-438	RD37M1F000-50	M24308/4-464	DD44M0F000	M24308/6-2F	RD15F1000C-50-403.0	M24308/6-19P	DD44F1000S-50-400.1
M24308/4-438F	RD37M1F00C-50	M24308/4-464F	DD44M0F00C	M24308/6-2P	RD15F1000S-50	M24308/6-20	DD62F10000-50-403.2
M24308/4-439	RD50M1F000-50	M24308/4-465	DD62M0F000	M24308/6-3	RD25F10000-50-403.0	M24308/6-20F	DD62F1000C-50-403.2
M24308/4-439F	RD50M1F00C-50	M24308/4-465F	DD62M0F00C	M24308/6-3F	RD25F1000C-50-403.0	M24308/6-20P	DD62F1000S-50-400.1
M24308/4-440	DD15M10000-50	M24308/4-466	DD78M0F000	M24308/6-3P	RD25F1000S-50	M24308/6-21	DD78F10000-50-403.2
M24308/4-440F	DD15M1000C-50	M24308/4-466F	DD78M0F00C	M24308/6-4	RD37F10000-50-403.0	M24308/6-21F	DD78F1000C-50-403.2
M24308/4-441	DD26M10000-50	M24308/4-467	DD104M0F000	M24308/6-4F	RD37F1000C-50-403.0	M24308/6-21P	DD78F1000S-50-400.1
M24308/4-441F	DD26M1000C-50	M24308/4-467F	DD104M0F00C	M24308/6-4P	RD37F1000S-50	M24308/6-22	DD104F10000-50-403.2
M24308/4-442	DD44M10000-50	M24308/5-1	HDC9F20000-50-403.0	M24308/6-5	RD50F10000-50-403.0	M24308/6-22F	DD104F1000C-50-403.2
M24308/4-442F	DD44M1000C-50	M24308/5-1F	HDC9F2000C-50-403.0	M24308/6-5F	RD50F1000C-50-403.0	M24308/6-22P	DD104F1000S-50-400.1
M24308/4-443	DD62M10000-50	M24308/5-1P	HDC9F2000S-50	M24308/6-5P	RD50F1000S-50	M24308/6-281	RD9F00000-403.0
M24308/4-443F	DD62M1000C-50	M24308/5-2	HDC15F20000-50-403.0	M24308/6-6	RD9F10000-50-403.1	M24308/6-281F	RD9F0000C-403.0
M24308/4-444	DD78M10000-50	M24308/5-2F	HDC15F2000C-50-403.0	M24308/6-6F	RD9F1000C-50-403.1	M24308/6-281P	RD9F0000S
M24308/4-444F	DD78M1000C-50	M24308/5-2P	HDC15F2000S-50	M24308/6-6P	RD9F1000S-50-400.0	M24308/6-282	RD15F00000-403.0
M24308/4-445	DD104M10000-50	M24308/5-3	HDC25F20000-50-403.0	M24308/6-7	RD15F10000-50-403.1	M24308/6-282F	RD15F0000C-403.0
M24308/4-445F	DD104M1000C-50	M24308/5-3F	HDC25F2000C-50-403.0	M24308/6-7F	RD15F1000C-50-403.1	M24308/6-282P	RD15F0000S
M24308/4-446	RD9M1F000-50-400.0	M24308/5-3P	HDC25F2000S-50	M24308/6-7P	RD15F1000S-50-400.0	M24308/6-283	RD25F00000-403.0
M24308/4-446F	RD9M1F00C-50-400.0	M24308/5-4	HDC37F20000-50-403.0	M24308/6-8	RD25F10000-50-403.1	M24308/6-283F	RD25F0000C-403.0
M24308/4-447	RD15M1F000-50-400.0	M24308/5-4F	HDC37F2000C-50-403.0	M24308/6-8F	RD25F1000C-50-403.1	M24308/6-283P	RD25F0000S
M24308/4-447F	RD15M1F00C-50-400.0	M24308/5-4P	HDC37F2000S-50	M24308/6-8P	RD25F1000S-50-400.0	M24308/6-284	RD37F00000-403.0
M24308/4-448	RD25M1F000-50-400.0	M24308/5-5	HDC50F20000-50-403.0	M24308/6-9	RD37F10000-50-403.1	M24308/6-284F	RD37F0000C-403.0
M24308/4-448F	RD25M1F00C-50-400.0	M24308/5-5F	HDC50F2000C-50-403.0	M24308/6-9F	RD37F1000C-50-403.1	M24308/6-284P	RD37F0000S
M24308/4-449	RD37M1F000-50-400.0	M24308/5-5P	HDC50F2000S-50	M24308/6-9P	RD37F1000S-50-400.0	M24308/6-285	RD50F00000-403.0
M24308/4-449F	RD37M1F00C-50-400.0	M24308/5-23	HDC9F2F000-50-403.0	M24308/6-10	RD50F10000-50-403.1	M24308/6-285F	RD50F0000C-403.0
M24308/4-450	RD50M1F000-50-400.0	M24308/5-23F	HDC9F2F00C-50-403.0	M24308/6-10F	RD50F1000C-50-403.1	M24308/6-285P	RD50F0000S
M24308/4-450F	RD50M1F00C-50-400.0	M24308/5-23P	HDC9F2F00S-50	M24308/6-10P	RD50F1000S-50-400.0	M24308/6-286	DD15F00000-403.0
M24308/4-451	DD15M1F000-50-400.1	M24308/5-24	HDC15F2F000-50-403.0	M24308/6-11	DD15F10000-50-403.0	M24308/6-286F	DD15F0000C-403.0
M24308/4-451F	DD15M1F00C-50-400.1	M24308/5-24F	HDC15F2F00C-50-403.0	M24308/6-11F	DD15F1000C-50-403.0	M24308/6-286P	DD15F0000S
M24308/4-452	DD26M1F000-50-400.1	M24308/5-24P	HDC15F2F00S-50	M24308/6-11P	DD15F1000S-50	M24308/6-287	DD26F00000-403.0
M24308/4-452F	DD26M1F00C-50-400.1	M24308/5-25	HDC25F2F000-50-403.0	M24308/6-12	DD26F10000-50-403.0	M24308/6-287F	DD26F0000C-403.0
M24308/4-453	DD44M1F000-50-400.1	M24308/5-25F	HDC25F2F00C-50-403.0	M24308/6-12F	DD26F1000C-50-403.0	M24308/6-287P	DD26F0000S
M24308/4-453F	DD44M1F00C-50-400.1	M24308/5-25P	HDC25F2F00S-50	M24308/6-12P	DD26F1000S-50	M24308/6-288	DD44F00000-403.0
M24308/4-454	DD62M1F000-50-400.1	M24308/5-26	HDC37F2F000-50-403.0	M24308/6-13	DD44F10000-50-403.0	M24308/6-288F	DD44F0000C-403.0
M24308/4-454F	DD62M1F00C-50-400.1	M24308/5-26F	HDC37F2F00C-50-403.0	M24308/6-13F	DD44F1000C-50-403.0	M24308/6-288P	DD44F0000S
M24308/4-455	DD78M1F000-50-400.1	M24308/5-26P	HDC37F2F00S-50	M24308/6-13P	DD44F1000S-50	M24308/6-289	DD62F00000-403.0
M24308/4-455F	DD78M1F00C-50-400.1	M24308/5-27	HDC50F2F000-50-403.0	M24308/6-14	DD62F10000-50-403.0	M24308/6-289F	DD62F0000C-403.0
M24308/4-456	DD104M1F000-50-400.1	M24308/5-27F	HDC50F2F00C-50-403.0	M24308/6-14F	DD62F1000C-50-403.0	M24308/6-289P	DD62F0000S
M24308/4-456F	DD104M1F00C-50-400.1	M24308/5-27P	HDC50F2F00S-50	M24308/6-14P	DD62F1000S-50	M24308/6-290	DD78F00000-403.0
M24308/4-457	RD9M0F000	M24308/5-34	HDC9F20000-50-403.3	M24308/6-15	DD78F10000-50-403.0	M24308/6-290F	DD78F0000C-403.0
M24308/4-457F	RD9M0F00C	M24308/5-35	HDC15F20000-50-403.3	M24308/6-15F	DD78F1000C-50-403.0	M24308/6-290P	DD78F0000S
M24308/4-458	RD15M0F000	M24308/5-36	HDC25F20000-50-403.3	M24308/6-15P	DD78F1000S-50	M24308/6-291	DD104F00000-403.0
M24308/4-458F	RD15M0F00C	M24308/5-37	HDC37F20000-50-403.3	M24308/6-16	DD104F10000-50-403.0	M24308/6-291F	DD104F0000C-403.0
M24308/4-459	RD25M0F000	M24308/5-38	HDC50F20000-50-403.3	M24308/6-16F	DD104F1000C-50-403.0	M24308/6-291P	DD104F0000S
M24308/4-459F	RD25M0F00C	M24308/5-56	HDC9F2F000-50-403.4	M24308/6-16P	DD104F1000S-50	M24308/6-453	RD9F1F000-50-403.0



Positronic Industries
connectpositronic.com

MIL-DTL-24308 / SAE AS 39029 / MIL-C-85049 QUALIFIED PRODUCTS LISTING

D-Sub

***NOTE:** Parts are to be ordered to the military number, the Positronic part number is for reference only.

Positronic HDC Series connectors are Q.P.L. approved to MIL-DTL-24308 per test report number 24308-618-79/24308-1210-85.
Positronic RD Series hoods are Q.P.L. approved to MIL-C-85049 per test report number 85049-870-84.
Positronic DD Series connectors are Q.P.L. approved to MIL-DTL-24308 per test report number 24308-1209-85/24308-1210-85/24308-117-89.
Positronic RD Series connectors are Q.P.L. approved to MIL-DTL-24308 per test report number 24308-211-79/24308-1210-85.
Positronic RD Series contacts are Q.P.L. approved to SAE AS 39029 per test report number 39029-694-79.

MILITARY PART NUMBER	REFERENCE NUMBER*	MILITARY PART NUMBER	REFERENCE NUMBER*	MILITARY PART NUMBER	REFERENCE NUMBER*	MILITARY PART NUMBER	REFERENCE NUMBER*
M24308/6-453F	RD9F1F00C-50-403.0	M24308/6-470P	DD26F1F00S-50-400.1	M24308/6-508	RD15F10000-50-403.5	M24308/6-576	RD37F0F000-403.4
M24308/6-453P	RD9F1F00S-50	M24308/6-471	DD44F1F000-50-403.2	M24308/6-509	RD25F10000-50-403.5	M24308/6-577	RD50F0F000-403.4
M24308/6-454	RD15F1F000-50-403.0	M24308/6-471F	DD44F1F00C-50-403.2	M24308/6-510	RD37F10000-50-403.5	M24308/6-578	DD15F0F000-403.4
M24308/6-454F	RD15F1F00C-50-403.0	M24308/6-471P	DD44F1F00S-50-400.1	M24308/6-511	RD50F10000-50-403.5	M24308/6-579	DD26F0F000-403.4
M24308/6-454P	RD15F1F00S-50	M24308/6-472	DD62F1F000-50-403.2	M24308/6-512	DD15F10000-50-403.3	M24308/6-580	DD44F0F000-403.4
M24308/6-455	RD25F1F000-50-403.0	M24308/6-472F	DD62F1F00C-50-403.2	M24308/6-513	DD26F10000-50-403.3	M24308/6-581	DD62F0F000-403.4
M24308/6-455F	RD25F1F00C-50-403.0	M24308/6-472P	DD62F1F00S-50-400.1	M24308/6-514	DD44F10000-50-403.3	M24308/6-582	DD78F0F000-403.4
M24308/6-455P	RD25F1F00S-50	M24308/6-473	DD78F1F000-50-403.2	M24308/6-515	DD62F10000-50-403.3	M24308/6-583	DD104F0F000-403.4
M24308/6-456	RD37F1F000-50-403.0	M24308/6-473F	DD78F1F00C-50-403.2	M24308/6-516	DD78F10000-50-403.3	M24308/7-1	HDC9M20000-50-403.0
M24308/6-456F	RD37F1F00C-50-403.0	M24308/6-473P	DD78F1F00S-50-400.1	M24308/6-517	DD104F10000-50-403.3	M24308/7-1F	HDC9M2000C-50-403.0
M24308/6-456P	RD37F1F00S-50	M24308/6-474	DD104F1F000-50-403.2	M24308/6-518	DD15F10000-50-403.5	M24308/7-1P	HDC9M2000S-50
M24308/6-457	RD50F1F000-50-403.0	M24308/6-474F	DD104F1F00C-50-403.2	M24308/6-519	DD26F10000-50-403.5	M24308/7-2	HDC15M20000-50-403.0
M24308/6-457F	RD50F1F00C-50-403.0	M24308/6-474P	DD104F1F00S-50-400.1	M24308/6-520	DD44F10000-50-403.5	M24308/7-2F	HDC15M2000C-50-403.0
M24308/6-457P	RD50F1F00S-50	M24308/6-491	RD9F0F000-403.0	M24308/6-521	DD62F10000-50-403.5	M24308/7-2P	HDC15M2000S-50
M24308/6-458	DD15F1F000-50-403.0	M24308/6-491F	RD9F0F00C-403.0	M24308/6-522	DD78F10000-50-403.5	M24308/7-3	HDC25M20000-50-403.0
M24308/6-458F	DD15F1F00C-50-403.0	M24308/6-491P	RD9F0F00S	M24308/6-523	DD104F10000-50-403.5	M24308/7-3F	HDC25M2000C-50-403.0
M24308/6-458P	DD15F1F00S-50	M24308/6-492	RD15F0F000-403.0	M24308/6-540	RD9F00000-403.3	M24308/7-3P	HDC25M2000S-50
M24308/6-459	DD26F1F000-50-403.0	M24308/6-492F	RD15F0F00C-403.0	M24308/6-541	RD15F00000-403.3	M24308/7-4	HDC37M20000-50-403.0
M24308/6-459F	DD26F1F00C-50-403.0	M24308/6-492P	RD15F0F00S	M24308/6-542	RD25F00000-403.3	M24308/7-4F	HDC37M2000C-50-403.0
M24308/6-459P	DD26F1F00S-50	M24308/6-493	RD25F0F000-403.0	M24308/6-543	RD37F00000-403.3	M24308/7-4P	HDC37M2000S-50
M24308/6-460	DD44F1F000-50-403.0	M24308/6-493F	RD25F0F00C-403.0	M24308/6-544	RD50F00000-403.3	M24308/7-5	HDC50M20000-50-403.0
M24308/6-460F	DD44F1F00C-50-403.0	M24308/6-493P	RD25F0F00S	M24308/6-545	DD15F00000-403.3	M24308/7-5F	HDC50M2000C-50-403.0
M24308/6-460P	DD44F1F00S-50	M24308/6-494	RD37F0F000-403.0	M24308/6-546	DD26F00000-403.3	M24308/7-5P	HDC50M2000S-50
M24308/6-461	DD62F1F000-50-403.0	M24308/6-494F	RD37F0F00C-403.0	M24308/6-547	DD44F00000-403.3	M24308/7-12	HDC9M2F000-50-403.0
M24308/6-461F	DD62F1F00C-50-403.0	M24308/6-494P	RD37F0F00S	M24308/6-548	DD62F00000-403.3	M24308/7-12F	HDC9M2F00C-50-403.0
M24308/6-461P	DD62F1F00S-50	M24308/6-495	RD50F0F000-403.0	M24308/6-549	DD78F00000-403.3	M24308/7-12P	HDC9M2F00S-50
M24308/6-462	DD78F1F000-50-403.0	M24308/6-495F	RD50F0F00C-403.0	M24308/6-550	DD104F00000-403.3	M24308/7-13	HDC15M2F000-50-403.0
M24308/6-462F	DD78F1F00C-50-403.0	M24308/6-495P	RD50F0F00S	M24308/6-551	RD9F1F000-50-403.4	M24308/7-13F	HDC15M2F00C-50-403.0
M24308/6-462P	DD78F1F00S-50	M24308/6-496	DD15F0F000-403.0	M24308/6-552	RD15F1F000-50-403.4	M24308/7-13P	HDC15M2F00S-50
M24308/6-463	DD104F1F000-50-403.0	M24308/6-496F	DD15F0F00C-403.0	M24308/6-553	RD25F1F000-50-403.4	M24308/7-14	HDC25M2F000-50-403.0
M24308/6-463F	DD104F1F00C-50-403.0	M24308/6-496P	DD15F0F00S	M24308/6-554	RD37F1F000-50-403.4	M24308/7-14F	HDC25M2F00C-50-403.0
M24308/6-463P	DD104F1F00S-50	M24308/6-497	DD26F0F000-403.0	M24308/6-555	RD50F1F000-50-403.4	M24308/7-14P	HDC25M2F00S-50
M24308/6-464	RD9F1F000-50-403.1	M24308/6-497F	DD26F0F00C-403.0	M24308/6-556	DD15F1F000-50-403.4	M24308/7-15	HDC37M2F000-50-403.0
M24308/6-464F	RD9F1F00C-50-403.1	M24308/6-497P	DD26F0F00S	M24308/6-557	DD26F1F000-50-403.4	M24308/7-15F	HDC37M2F00C-50-403.0
M24308/6-464P	RD9F1F00S-50-400.0	M24308/6-498	DD44F0F000-403.0	M24308/6-558	DD44F1F000-50-403.4	M24308/7-15P	HDC37M2F00S-50
M24308/6-465	RD15F1F000-50-403.1	M24308/6-498F	DD44F0F00C-403.0	M24308/6-559	DD62F1F000-50-403.4	M24308/7-16	HDC50M2F000-50-403.0
M24308/6-465F	RD15F1F00C-50-403.1	M24308/6-498P	DD44F0F00S	M24308/6-560	DD78F1F000-50-403.4	M24308/7-16F	HDC50M2F00C-50-403.0
M24308/6-465P	RD15F1F00S-50-400.0	M24308/6-499	DD62F0F000-403.0	M24308/6-561	DD104F1F000-50-403.4	M24308/7-16P	HDC50M2F00S-50
M24308/6-466	RD25F1F000-50-403.1	M24308/6-499F	DD62F0F00C-403.0	M24308/6-562	RD9F1F000-50-403.6	M24308/7-17	HDC9M2F000-50-403.0
M24308/6-466F	RD25F1F00C-50-403.1	M24308/6-499P	DD62F0F00S	M24308/6-563	RD15F1F000-50-403.6	M24308/7-17F	HDC9M2F00C-50-403.0
M24308/6-466P	RD25F1F00S-50-400.0	M24308/6-500	DD78F0F000-403.0	M24308/6-564	RD25F1F000-50-403.6	M24308/7-17P	HDC9M2F00S-50
M24308/6-467	RD37F1F000-50-403.1	M24308/6-500F	DD78F0F00C-403.0	M24308/6-565	RD37F1F000-50-403.6	M24308/7-18	HDC15M2F000-50-403.0
M24308/6-467F	RD37F1F00C-50-403.1	M24308/6-500P	DD78F0F00S	M24308/6-566	RD50F1F000-50-403.6	M24308/7-18F	HDC15M2F00C-50-403.0
M24308/6-467P	RD37F1F00S-50-400.0	M24308/6-501	DD104F0F000-403.0	M24308/6-567	DD15F1F000-50-403.6	M24308/7-18P	HDC15M2F00S-50
M24308/6-468	RD50F1F000-50-403.1	M24308/6-501F	DD104F0F00C-403.0	M24308/6-568	DD26F1F000-50-403.6	M24308/7-19	HDC25M2F000-50-403.0
M24308/6-468F	RD50F1F00C-50-403.1	M24308/6-501P	DD104F0F00S	M24308/6-569	DD44F1F000-50-403.6	M24308/7-19F	HDC25M2F00C-50-403.0
M24308/6-468P	RD50F1F00S-50-400.0	M24308/6-502	RD9F10000-50-403.3	M24308/6-570	DD62F1F000-50-403.6	M24308/7-19P	HDC25M2F00S-50
M24308/6-469	DD15F1F000-50-403.2	M24308/6-503	RD15F10000-50-403.3	M24308/6-571	DD78F1F000-50-403.6	M24308/7-20	HDC37M2F000-50-403.0
M24308/6-469F	DD15F1F00C-50-403.2	M24308/6-504	RD25F10000-50-403.3	M24308/6-572	DD104F1F000-50-403.6	M24308/7-20F	HDC37M2F00C-50-403.0
M24308/6-469P	DD15F1F00S-50-400.1	M24308/6-505	RD37F10000-50-403.3	M24308/6-573	RD9F0F000-403.4	M24308/7-20P	HDC37M2F00S-50
M24308/6-470	DD26F1F000-50-403.2	M24308/6-506	RD50F10000-50-403.3	M24308/6-574	RD15F0F000-403.4	M24308/7-21	HDC50M2F000-50-403.0
M24308/6-470F	DD26F1F00C-50-403.2	M24308/6-507	RD9F10000-50-403.5	M24308/6-575	RD25F0F000-403.4	M24308/7-21F	HDC50M2F00C-50-403.0

MIL LISTING



***NOTE:** Parts are to be ordered to the military number, the Positronic part number is for reference only.

Positronic HDC Series connectors are Q.P.L. approved to MIL-DTL-24308 per test report number 24308-618-79/24308-1210-85.
 Positronic RD Series hoods are Q.P.L. approved to MIL-C-85049 per test report number 85049-870-84.
 Positronic DD Series connectors are Q.P.L. approved to MIL-DTL-24308 per test report number 24308-1209-85/24308-1210-85/24308-117-89.
 Positronic RD Series connectors are Q.P.L. approved to MIL-DTL-24308 per test report number 24308-211-79/24308-1210-85.
 Positronic RD Series contacts are Q.P.L. approved to SAE AS 39029 per test report number 39029-694-79.

MILITARY PART NUMBER	REFERENCE NUMBER*	MILITARY PART NUMBER	REFERENCE NUMBER*	MILITARY PART NUMBER	REFERENCE NUMBER*	MILITARY PART NUMBER	REFERENCE NUMBER*
M24308/7-21P	HDC50M2F00S-50	M24308/8-14P	DD62M1000S-50	M24308/8-268	DD78M00000-403.0	M24308/8-414	RD25M1F000-50-403.6
M24308/7-23	HDC9M20000-50-403.3	M24308/8-15	DD78M10000-50-403.0	M24308/8-268F	DD78M0000C-403.0	M24308/8-415	RD37M1F000-50-403.6
M24308/7-24	HDC15M20000-50-403.3	M24308/8-15F	DD78M1000C-50-403.0	M24308/8-268P	DD78M0000S	M24308/8-416	RD50M1F000-50-403.6
M24308/7-25	HDC25M20000-50-403.3	M24308/8-15P	DD78M1000S-50	M24308/8-269	DD104M00000-403.0	M24308/8-417	DD15M1F000-50-403.6
M24308/7-26	HDC37M20000-50-403.3	M24308/8-16	DD104M10000-50-403.0	M24308/8-269F	DD104M0000C-403.0	M24308/8-418	DD26M1F000-50-403.6
M24308/7-27	HDC50M20000-50-403.3	M24308/8-16F	DD104M1000C-50-403.0	M24308/8-269P	DD104M0000S	M24308/8-419	DD44M1F000-50-403.6
M24308/7-34	HDC9M2F000-50-403.4	M24308/8-16P	DD104M1000S-50	M24308/8-335	RD9M10000-50-403.3	M24308/8-420	DD62M1F000-50-403.6
M24308/7-35	HDC15M2F000-50-403.4	M24308/8-17	DD15M10000-50-403.2	M24308/8-336	RD15M10000-50-403.3	M24308/8-421	DD78M1F000-50-403.6
M24308/7-36	HDC25M2F000-50-403.4	M24308/8-17F	DD15M1000C-50-403.2	M24308/8-337	RD25M10000-50-403.3	M24308/8-422	DD104M1F000-50-403.6
M24308/7-37	HDC37M2F000-50-403.4	M24308/8-17P	DD15M1000S-50-400.1	M24308/8-338	RD37M10000-50-403.3	M24308/8-423	RD9M0F000-403.4
M24308/7-38	HDC50M2F000-50-403.4	M24308/8-18	DD26M10000-50-403.2	M24308/8-339	RD50M10000-50-403.3	M24308/8-424	RD15M0F000-403.4
M24308/8-1	RD9M10000-50-403.0	M24308/8-18F	DD26M1000C-50-403.2	M24308/8-340	RD9M10000-50-403.5	M24308/8-425	RD25M0F000-403.4
M24308/8-1F	RD9M1000C-50-403.0	M24308/8-18P	DD26M1000S-50-400.1	M24308/8-341	RD15M10000-50-403.5	M24308/8-426	RD37M0F000-403.4
M24308/8-1P	RD9M1000S-50	M24308/8-19	DD44M10000-50-403.2	M24308/8-342	RD25M10000-50-403.5	M24308/8-427	RD50M0F000-403.4
M24308/8-2	RD15M10000-50-403.0	M24308/8-19F	DD44M1000C-50-403.2	M24308/8-343	RD37M10000-50-403.5	M24308/8-428	DD15M0F000-403.4
M24308/8-2F	RD15M1000C-50-403.0	M24308/8-19P	DD44M1000S-50-400.1	M24308/8-344	RD50M10000-50-403.5	M24308/8-429	DD26M0F000-403.4
M24308/8-2P	RD15M1000S-50	M24308/8-20	DD62M10000-50-403.2	M24308/8-345	DD15M10000-50-403.3	M24308/8-430	DD44M0F000-403.4
M24308/8-3	RD25M10000-50-403.0	M24308/8-20F	DD62M1000C-50-403.2	M24308/8-346	DD26M10000-50-403.3	M24308/8-431	DD62M0F000-403.4
M24308/8-3F	RD25M1000C-50-403.0	M24308/8-20P	DD62M1000S-50-400.1	M24308/8-347	DD44M10000-50-403.3	M24308/8-432	DD78M0F000-403.4
M24308/8-3P	RD25M1000S-50	M24308/8-21	DD78M10000-50-403.2	M24308/8-348	DD62M10000-50-403.3	M24308/8-433	DD104M0F000-403.4
M24308/8-4	RD37M10000-50-403.0	M24308/8-21F	DD78M1000C-50-403.2	M24308/8-349	DD78M10000-50-403.3	M24308/8-435	RD9M1F000-50-403.0
M24308/8-4F	RD37M1000C-50-403.0	M24308/8-21P	DD78M1000S-50-400.1	M24308/8-350	DD104M10000-50-403.3	M24308/8-435F	RD9M1F00C-50-403.0
M24308/8-4P	RD37M1000S-50	M24308/8-22	DD104M10000-50-403.2	M24308/8-351	DD15M10000-50-403.5	M24308/8-435P	RD9M1F00S-50
M24308/8-5	RD50M10000-50-403.0	M24308/8-22F	DD104M1000C-50-403.2	M24308/8-352	DD26M10000-50-403.5	M24308/8-436	RD15M1F000-50-403.0
M24308/8-5F	RD50M1000C-50-403.0	M24308/8-22P	DD104M1000S-50-400.1	M24308/8-353	DD44M10000-50-403.5	M24308/8-436F	RD15M1F00C-50-403.0
M24308/8-5P	RD50M1000S-50	M24308/8-259	RD9M00000-403.0	M24308/8-354	DD62M10000-50-403.5	M24308/8-436P	RD15M1F00S-50
M24308/8-6	RD9M10000-50-403.1	M24308/8-259F	RD9M0000C-403.0	M24308/8-355	DD78M10000-50-403.5	M24308/8-437	RD25M1F000-50-403.0
M24308/8-6F	RD9M1000C-50-403.1	M24308/8-259P	RD9M0000S	M24308/8-356	DD104M10000-50-403.5	M24308/8-437F	RD25M1F00C-50-403.0
M24308/8-6P	RD9M1000S-50-400.0	M24308/8-260	RD15M00000-403.0	M24308/8-357	RD9M00000-403.3	M24308/8-437P	RD25M1F00S-50
M24308/8-7	RD15M10000-50-403.1	M24308/8-260F	RD15M0000C-403.0	M24308/8-358	RD15M00000-403.3	M24308/8-438	RD37M1F000-50-403.0
M24308/8-7F	RD15M1000C-50-403.1	M24308/8-260P	RD15M0000S	M24308/8-359	RD25M00000-403.3	M24308/8-438F	RD37M1F00C-50-403.0
M24308/8-7P	RD15M1000S-50-400.0	M24308/8-261	RD25M00000-403.0	M24308/8-360	RD37M00000-403.3	M24308/8-438P	RD37M1F00S-50
M24308/8-8	RD25M10000-50-403.1	M24308/8-261F	RD25M0000C-403.0	M24308/8-361	RD50M00000-403.3	M24308/8-439	RD50M1F000-50-403.0
M24308/8-8F	RD25M1000C-50-403.1	M24308/8-261P	RD25M0000S	M24308/8-362	DD15M00000-403.3	M24308/8-439F	RD50M1F00C-50-403.0
M24308/8-8P	RD25M1000S-50-400.0	M24308/8-262	RD37M00000-403.0	M24308/8-363	DD26M00000-403.3	M24308/8-439P	RD50M1F00S-50
M24308/8-9	RD37M10000-50-403.1	M24308/8-262F	RD37M0000C-403.0	M24308/8-364	DD44M00000-403.3	M24308/8-440	DD15M1F000-50-403.0
M24308/8-9F	RD37M1000C-50-403.1	M24308/8-262P	RD37M0000S	M24308/8-365	DD62M00000-403.3	M24308/8-440F	DD15M1F00C-50-403.0
M24308/8-9P	RD37M1000S-50-400.0	M24308/8-263	RD50M00000-403.0	M24308/8-366	DD78M00000-403.3	M24308/8-440P	DD15M1F00S-50
M24308/8-10	RD50M10000-50-403.1	M24308/8-263F	RD50M0000C-403.0	M24308/8-367	DD104M00000-403.3	M24308/8-441	DD26M1F000-50-403.0
M24308/8-10F	RD50M1000C-50-403.1	M24308/8-263P	RD50M0000S	M24308/8-401	RD9M1F000-50-403.4	M24308/8-441F	DD26M1F00C-50-403.0
M24308/8-10P	RD50M1000S-50-400.0	M24308/8-264	DD15M00000-403.0	M24308/8-402	RD15M1F000-50-403.4	M24308/8-441P	DD26M1F00S-50
M24308/8-11	DD15M10000-50-403.0	M24308/8-264F	DD15M0000C-403.0	M24308/8-403	RD25M1F000-50-403.4	M24308/8-442	DD44M1F000-50-403.0
M24308/8-11F	DD15M1000C-50-403.0	M24308/8-264P	DD15M0000S	M24308/8-404	RD37M1F000-50-403.4	M24308/8-442F	DD44M1F00C-50-403.0
M24308/8-11P	DD15M1000S-50	M24308/8-265	DD26M00000-403.0	M24308/8-405	RD50M1F000-50-403.4	M24308/8-442P	DD44M1F00S-50
M24308/8-12	DD26M10000-50-403.0	M24308/8-265F	DD26M0000C-403.0	M24308/8-406	DD15M1F000-50-403.4	M24308/8-443	DD62M1F000-50-403.0
M24308/8-12F	DD26M1000C-50-403.0	M24308/8-265P	DD26M0000S	M24308/8-407	DD26M1F000-50-403.4	M24308/8-443F	DD62M1F00C-50-403.0
M24308/8-12P	DD26M1000S-50	M24308/8-266	DD44M00000-403.0	M24308/8-408	DD44M1F000-50-403.4	M24308/8-443P	DD62M1F00S-50
M24308/8-13	DD44M10000-50-403.0	M24308/8-266F	DD44M0000C-403.0	M24308/8-409	DD62M1F000-50-403.4	M24308/8-444	DD78M1F000-50-403.0
M24308/8-13F	DD44M1000C-50-403.0	M24308/8-266P	DD44M0000S	M24308/8-410	DD78M1F000-50-403.4	M24308/8-444F	DD78M1F00C-50-403.0
M24308/8-13P	DD44M1000S-50	M24308/8-267	DD62M00000-403.0	M24308/8-411	DD104M1F000-50-403.4	M24308/8-444P	DD78M1F00S-50
M24308/8-14	DD62M10000-50-403.0	M24308/8-267F	DD62M0000C-403.0	M24308/8-412	RD9M1F000-50-403.6	M24308/8-445	DD104M1F000-50-403.0
M24308/8-14F	DD62M1000C-50-403.0	M24308/8-267P	DD62M0000S	M24308/8-413	RD15M1F000-50-403.6	M24308/8-445F	DD104M1F00C-50-403.0



Positronic Industries
connectpositronic.com

MIL-DTL-24308 / SAE AS 39029 / MIL-C-85049 QUALIFIED PRODUCTS LISTING

D-Sub

***NOTE:** Parts are to be ordered to the military number, the Positronic part number is for reference only.

Positronic HDC Series connectors are Q.P.L. approved to MIL-DTL-24308 per test report number 24308-618-79/24308-1210-85.
Positronic RD Series hoods are Q.P.L. approved to MIL-C-85049 per test report number 85049-870-84.
Positronic DD Series connectors are Q.P.L. approved to MIL-DTL-24308 per test report number 24308-1209-85/24308-1210-85/24308-117-89.
Positronic RD Series connectors are Q.P.L. approved to MIL-DTL-24308 per test report number 24308-211-79/24308-1210-85.
Positronic RD Series contacts are Q.P.L. approved to SAE AS 39029 per test report number 39029-694-79.

MILITARY PART NUMBER	REFERENCE NUMBER*	MILITARY PART NUMBER	REFERENCE NUMBER*	MILITARY PART NUMBER	REFERENCE NUMBER*	MILITARY PART NUMBER	REFERENCE NUMBER*
M24308/8-445P	DD104M1F00S-50	M24608/8-463	DD26M0F000-403.0	M24308/23-205F	HDC50F3P00C-50-403.0	M24308/23-313	HDC9F3P000-50-799.17
M24308/8-446	RD9M1F000-50-403.1	M24308/8-463F	DD26M0F00C-403.0	M24308/23-205P	HDC50F3P00S-50	M24308/23-14	HDC15F3P000-50-375.2
M24308/8-446F	RD9M1F00C-50-403.1	M24308/8-463P	DD26M0F00S	M24308/23-305	HDC50F3P000-50-799.7	M24308/23-14F	HDC15F3P00C-50-375.2
M24308/8-446P	RD9M1F00S-50-400.0	M24308/8-464	DD44M0F000-403.0	M24308/23-7	HDC9F3P000-50-375.10	M24308/23-14P	HDC15F3P00S-50-375.2
M24308/8-447	RD15M1F000-50-403.1	M24308/8-464F	DD44M0F00C-403.0	M24308/23-7F	HDC9F3P00C-50-375.10	M24308/23-114	HDC15F3P000-50-403.46
M24308/8-447F	RD15M1F00C-50-403.1	M24308/8-464P	DD44M0F00S	M24308/23-7P	HDC9F3P00S-50-375.10	M24308/23-214	HDC15F3P000-50-403.47
M24308/8-447P	RD15M1F00S-50-400.0	M24308/8-465	DD62M0F000-403.0	M24308/23-107	HDC9F3P000-50-403.28	M24308/23-214F	HDC15F3P00C-50-403.47
M24308/8-448	RD25M1F000-50-403.1	M24308/8-465F	DD62M0F00C-403.0	M24308/23-207	HDC9F3P000-50-403.29	M24308/23-15	HDC25F3P000-50-375.2
M24308/8-448F	RD25M1F00C-50-403.1	M24308/8-465P	DD62M0F00S	M24308/23-207F	HDC9F3P00C-50-403.29	M24308/23-15F	HDC25F3P00C-50-375.2
M24308/8-448P	RD25M1F00S-50-400.0	M24308/8-466	DD78M0F000-403.0	M24308/23-207P	HDC9F3P00S-50-375.10	M24308/23-15P	HDC25F3P00S-50-375.2
M24308/8-449	RD37M1F000-50-403.1	M24308/8-466F	DD78M0F00C-403.0	M24308/23-214P	HDC15F3P00S-50-375.2	M24308/23-115	HDC25F3P000-50-403.46
M24308/8-449F	RD37M1F00C-50-403.1	M24308/8-466P	DD78M0F00S	M24308/23-314	HDC15F3P000-50-799.17	M24308/23-215	HDC25F3P000-50-403.47
M24308/8-449P	RD37M1F00S-50-400.0	M24308/8-467	DD104M0F000-403.0	M24308/23-307	HDC9F3P000-50-799.8	M24308/23-215F	HDC25F3P00C-50-403.47
M24308/8-450	RD50M1F000-50-403.1	M24308/8-467F	DD104M0F00C-403.0	M24308/23-8	HDC15F3P000-50-375.10	M24308/23-215P	HDC25F3P00S-50-375.2
M24308/8-450F	RD50M1F00C-50-403.1	M24308/8-467P	DD104M0F00S	M24308/23-8F	HDC15F3P00C-50-375.10	M24308/23-315	HDC25F3P000-50-799.17
M24308/8-450P	RD50M1F00S-50-400.0	M24308/23-1	HDC9F3P000-50	M24308/23-8P	HDC15F3P00S-50-375.10	M24308/23-16	HDC37F3P000-50-375.2
M24308/8-451	DD15M1F000-50-403.2	M24308/23-1F	HDC9F3P00C-50	M24308/23-108	HDC15F3P000-50-403.28	M24308/23-16F	HDC37F3P00C-50-375.2
M24308/8-451F	DD15M1F00C-50-403.2	M24308/23-1P	HDC9F3P00S-50	M24308/23-208	HDC15F3P000-50-403.29	M24308/23-16P	HDC37F3P00S-50-375.2
M24308/8-451P	DD15M1F00S-50-400.1	M24308/23-101	HDC9F3P000-50-403.27	M24308/23-208F	HDC15F3P00C-50-403.29	M24308/23-116	HDC37F3P00C-50-403.46
M24308/8-452	DD26M1F000-50-403.2	M24308/23-201	HDC9F3P000-50-403.0	M24308/23-208P	HDC15F3P00S-50-375.10	M24308/23-216	HDC37F3P000-50-403.4
M24308/8-452F	DD26M1F00C-50-403.2	M24308/23-201F	HDC9F3P00C-50-403.0	M24308/23-308	HDC15F3P000-50-799.8	M24308/23-216F	HDC37F3P00C-50-403.47
M24308/8-452P	DD26M1F00S-50-400.1	M24308/23-201P	HDC9F3P00S-50	M24308/23-9	HDC25F3P000-50-375.10	M24308/23-216P	HDC37F3P00S-50-375.2
M24308/8-453	DD44M1F000-50-403.2	M24308/23-301	HDC9F3P00C-50-799.7	M24308/23-9F	HDC25F3P00C-50-375.10	M24308/23-316	HDC37F3P000-50-799.17
M24308/8-453F	DD44M1F00C-50-403.2	M24308/23-2	HDC15F3P000-50	M24308/23-9P	HDC25F3P00S-50-375.10	M24308/23-17	HDC50F3P000-50-375.2
M24308/8-453P	DD44M1F00S-50-400.1	M24308/23-2F	HDC15F3P00C-50	M24308/23-109	HDC25F3P000-50-403.28	M24308/23-17F	HDC50F3P00C-50-375.2
M24308/8-454	DD62M1F000-50-403.2	M24308/23-2P	HDC15F3P00S-50	M24308/23-209	HDC25F3P000-50-403.29	M24308/23-17P	HDC50F3P00S-50-375.2
M24308/8-454F	DD62M1F00C-50-403.2	M24308/23-102	HDC15F3P000-50-403.27	M24308/23-209F	HDC25F3P00C-50-403.29	M24308/23-117	HDC50F3P000-50-403.46
M24308/8-454P	DD62M1F00S-50-400.1	M24308/23-202	HDC15F3P000-50-403.0	M24308/23-209P	HDC25F3P00S-50-375.10	M24308/23-217	HDC50F3P000-50-403.47
M24308/8-455	DD78M1F000-50-403.2	M24308/23-202F	HDC15F3P00C-50-403.0	M24308/23-309	HDC25F3P000-50-799.8	M24308/23-217F	HDC50F3P00C-50-403.47
M24308/8-455F	DD78M1F00C-50-403.2	M24308/23-202P	HDC15F3P00S-50	M24308/23-10	HDC37F3P000-50-375.10	M24308/23-217P	HDC50F3P00S-50-375.2
M24308/8-455P	DD78M1F00S-50-400.1	M24308/23-302	HDC15F3P000-50-799.7	M24308/23-10F	HDC37F3P00C-50-375.10	M24308/23-317	HDC50F3P000-50-799.17
M24308/8-456	DD104M1F000-50-403.2	M24308/23-3	HDC25F3P000-50	M24308/23-10P	HDC37F3P00S-50-375.10	M24308/23-19	HDC9F3P000-50-375.9
M24308/8-456F	DD104M1F00C-50-403.2	M24308/23-3F	HDC25F3P00C-50	M24308/23-110	HDC37F3P000-50-403.28	M24308/23-19F	HDC9F3P00C-50-375.9
M24308/8-456P	DD104M1F00S-50-400.1	M24308/23-3P	HDC25F3P00S-50	M24308/23-210	HDC37F3P000-50-403.29	M24308/23-19P	HDC9F3P00S-50-375.9
M24308/8-457	RD9M0F000-403.0	M24308/23-103	HDC25F3P000-50-403.27	M24308/23-210F	HDC37F3P00C-50-403.29	M24308/23-119	HDC9F3P000-50-403.32
M24308/8-457F	RD9M0F00C-403.0	M24308/23-203	HDC25F3P000-50-403.0	M24308/23-210P	HDC37F3P00S-50-375.10	M24308/23-219	HDC9F3P000-50-403.33
M24308/8-457P	RD9M0F00S	M24308/23-203F	HDC25F3P00C-50-403.0	M24308/23-310	HDC37F3P000-50-799.8	M24308/23-219F	HDC9F3P00C-50-403.33
M24308/8-458	RD15M0F000-403.0	M24308/23-203P	HDC25F3P00S-50	M24308/23-11	HDC50F3P000-50-375.10	M24308/23-219P	HDC9F3P00S-50-375.9
M24308/8-458F	RD15M0F00C-403.0	M24308/23-303	HDC25F3P000-50-799.7	M24308/23-11F	HDC50F3P00C-50-375.10	M24308/23-319	HDC9F3P000-50-799.10
M24308/8-458P	RD15M0F00S	M24308/23-4	HDC37F3P000-50	M24308/23-11P	HDC50F3P00S-50-375.10	M24308/23-20	HDC15F3P000-50-375.9
M24308/8-459	RD25M0F000-403.0	M24308/23-4F	HDC37F3P00C-50	M24308/23-111	HDC50F3P000-50-403.28	M24308/23-20F	HDC15F3P00C-50-375.9
M24308/8-459F	RD25M0F00C-403.0	M24308/23-4P	HDC37F3P00S-50	M24308/23-211	HDC50F3P000-50-403.29	M24308/23-20P	HDC15F3P00S-50-375.9
M24308/8-459P	RD25M0F00S	M24308/23-104	HDC37F3P000-50-403.27	M24308/23-211F	HDC50F3P00C-50-403.29	M24308/23-120	HDC15F3P000-50-403.32
M24308/8-460	RD37M0F000-403.0	M24308/23-204	HDC37F3P000-50-403.0	M24308/23-211P	HDC50F3P00S-50-375.10	M24308/23-220	HDC15F3P000-50-403.33
M24308/8-460F	RD37M0F00C-403.0	M24308/23-204F	HDC37F3P00C-50-403.0	M24308/23-311	HDC50F3P000-50-799.8	M24308/23-220F	HDC15F3P00C-50-403.33
M24308/8-460P	RD37M0F00S	M24308/23-204P	HDC37F3P00S-50	M24308/23-13	HDC9F3P000-50-375.2	M24308/23-220P	HDC15F3P00S-50-375.9
M24308/8-461	RD50M0F000-403.0	M24308/23-304	HDC37F3P000-50-799.7	M24308/23-13F	HDC9F3P00C-50-375.2	M24308/23-320	HDC15F3P000-50-799.10
M24308/8-461F	RD50M0F00C-403.0	M24308/23-5	HDC50F3P000-50	M24308/23-13P	HDC9F3P00S-50-375.2	M24308/23-21	HDC25F3P000-50-375.9
M24308/8-461P	RD50M0F00S	M24308/23-5F	HDC50F3P00C-50	M24308/23-113	HDC9F3P000-50-403.46	M24308/23-21F	HDC25F3P00C-50-375.9
M24308/8-462	DD15M0F000-403.0	M24308/23-5P	HDC50F3P00S-50	M24308/23-213	HDC9F3P000-50-403.47	M24308/23-21P	HDC25F3P00S-50-375.9
M24308/8-462F	DD15M0F00C-403.0	M24308/23-105	HDC50F3P000-50-403.27	M24308/23-213F	HDC9F3P00C-50-403.47	M24308/23-121	HDC25F3P000-50-403.32
M24308/8-462P	DD15M0F00S	M24308/23-205	HDC50F3P000-50-403.0	M24308/23-213P	HDC9F3P00S-50-375.2	M24308/23-221	HDC25F3P000-50-403.33

MIL LISTING



***NOTE:** Parts are to be ordered to the military number, the Positronic part number is for reference only.

Positronic HDC Series connectors are Q.P.L. approved to MIL-DTL-24308 per test report number 24308-618-79/24308-1210-85.
 Positronic RD Series hoods are Q.P.L. approved to MIL-C-85049 per test report number 85049-870-84.
 Positronic DD Series connectors are Q.P.L. approved to MIL-DTL-24308 per test report number 24308-1209-85/24308-1210-85/24308-117-89.
 Positronic RD Series connectors are Q.P.L. approved to MIL-DTL-24308 per test report number 24308-211-79/24308-1210-85.
 Positronic RD Series contacts are Q.P.L. approved to SAE AS 39029 per test report number 39029-694-79.

MILITARY PART NUMBER	REFERENCE NUMBER*	MILITARY PART NUMBER	REFERENCE NUMBER*	MILITARY PART NUMBER	REFERENCE NUMBER*	MILITARY PART NUMBER	REFERENCE NUMBER*
M24308/23-221F	HDC25F3P00C-50-403.33	M24308/23-29F	HDC50F5B800C-50-376.6	M24308/23-237F	HDC9F5B800C-50-403.39	M24308/23-245F	HDC25F5B800C-50-376.2
M24308/23-221P	HDC25F3P00S-50-375.9	M24308/23-29P	HDC50F5B800S-50-376.6	M24308/23-237P	HDC9F5B800S-50-376.5	M24308/23-245P	HDC25F5B800S-50-376.2
M24308/23-321	HDC25F3P000-50-799.10	M24308/23-129	HDC50F5B8000-50-403.34	M24308/23-337	HDC9F5B8000-50-799.13	M24308/23-145	HDC25F5B8000-50-403.48
M24308/23-22	HDC37F3P00C-50-375.9	M24308/23-229	HDC50F5B8000-50-403.35	M24308/23-38	HDC15F5B8000-50-376.5	M24308/23-245	HDC25F5B8000-50-403.49
M24308/23-22F	HDC37F3P00C-50-375.9	M24308/23-229F	HDC50F5B800C-50-403.35	M24308/23-38F	HDC15F5B800C-50-376.5	M24308/23-245F	HDC25F5B800C-50-403.49
M24308/23-22P	HDC37F3P00S-50-375.9	M24308/23-229P	HDC50F5B800S-50-376.6	M24308/23-38P	HDC15F5B800S-50-376.5	M24308/23-245P	HDC25F5B800S-50-376.2
M24308/23-122	HDC37F3P000-50-403.32	M24308/23-328	HDC50F5B8000-50-799.11	M24308/23-138	HDC15F5B8000-50-403.38	M24308/23-345	HDC25F5B8000-50-799.18
M24308/23-222	HDC37F3P000-50-403.33	M24308/23-31	HDC9F5B8000-50	M24308/23-238	HDC15F5B8000-50-403.39	M24308/23-346	HDC37F5B8000-50-376.2
M24308/23-222F	HDC37F3P00C-50-403.33	M24308/23-31F	HDC9F5B800C-50	M24308/23-238F	HDC15F5B800C-50-403.39	M24308/23-346F	HDC37F5B800C-50-376.2
M24308/23-222P	HDC37F3P00S-50-375.9	M24308/23-31P	HDC9F5B800S-50	M24308/23-238P	HDC15F5B800S-50-376.5	M24308/23-346P	HDC37F5B800S-50-376.2
M24308/23-322	HDC37F3P000-50-799.10	M24308/23-131	HDC9F5B8000-50-403.36	M24308/23-338	HDC15F5B8000-50-799.13	M24308/23-146	HDC37F5B8000-50-403.48
M24308/23-23	HDC50F3P000-50-375.9	M24308/23-231	HDC9F5B8000-50-403.0	M24308/23-39	HDC25F5B8000-50-376.5	M24308/23-246	HDC37F5B8000-50-403.49
M24308/23-23F	HDC50F3P00C-50-375.9	M24308/23-231F	HDC9F5B800C-50-403.0	M24308/23-39F	HDC25F5B800C-50-376.5	M24308/23-246F	HDC37F5B800C-50-403.49
M24308/23-23P	HDC50F3P00S-50-375.9	M24308/23-231P	HDC9F5B800S-50	M24308/23-39P	HDC25F5B800S-50-376.5	M24308/23-246P	HDC37F5B800S-50-376.2
M24308/23-123	HDC50F3P000-50-403.32	M24308/23-331	HDC9F5B8000-50-799.12	M24308/23-139	HDC25F5B8000-50-403.38	M24308/23-346	HDC37F5B8000-50-799.18
M24308/23-223	HDC50F3P000-50-403.33	M24308/23-32	HDC15F5B8000-50	M24308/23-239	HDC25F5B8000-50-403.39	M24308/23-47	HDC50F5B8000-50-376.2
M24308/23-223F	HDC50F3P00C-50-403.33	M24308/23-32F	HDC15F5B800C-50	M24308/23-239F	HDC25F5B800C-50-403.39	M24308/23-47F	HDC50F5B800C-50-376.2
M24308/23-223P	HDC50F3P00S-50-375.9	M24308/23-32P	HDC15F5B800S-50	M24308/23-239P	HDC25F5B800S-50-376.5	M24308/23-47P	HDC50F5B800S-50-376.2
M24308/23-323	HDC50F3P000-50-799.10	M24308/23-132	HDC15F5B8000-50-403.36	M24308/23-339	HDC25F5B8000-50-799.13	M24308/23-147	HDC50F5B8000-50-403.48
M24308/23-25	HDC9F5B8000-50-376.6	M24308/23-232	HDC15F5B8000-50-403.0	M24308/23-40	HDC37F5B8000-50-376.5	M24308/23-247	HDC50F5B8000-50-403.49
M24308/23-25F	HDC9F5B800C-50-376.6	M24308/23-232F	HDC15F5B800C-50-403.0	M24308/23-40F	HDC37F5B800C-50-376.5	M24308/23-247F	HDC50F5B800C-50-403.49
M24308/23-25P	HDC9F5B800S-50-376.6	M24308/23-232P	HDC15F5B800S-50	M24308/23-40P	HDC37F5B800S-50-376.5	M24308/23-247P	HDC50F5B800S-50-376.2
M24308/23-125	HDC9F5B8000-50-403.34	M24308/23-332	HDC15F5B8000-50-799.12	M24308/23-140	HDC37F5B8000-50-403.38	M24308/23-347	HDC50F5B8000-50-799.18
M24308/23-225	HDC9F5B8000-50-403.35	M24308/23-33	HDC25F5B8000-50	M24308/23-240	HDC37F5B8000-50-403.39	M24308/23-49	HDC9F5B8000-50-376.8
M24308/23-225F	HDC9F5B800C-50-403.35	M24308/23-33F	HDC25F5B800C-50	M24308/23-240F	HDC37F5B800C-50-403.39	M24308/23-49F	HDC9F5B800C-50-376.8
M24308/23-225P	HDC9F5B800S-50-376.6	M24308/23-33P	HDC25F5B800S-50	M24308/23-240P	HDC37F5B800S-50-376.5	M24308/23-49P	HDC9F5B800S-50-376.8
M24308/23-325	HDC9F5B8000-50-799.11	M24308/23-133	HDC25F5B8000-50-403.36	M24308/23-340	HDC37F5B8000-50-799.13	M24308/23-149	HDC9F5B8000-50-403.42
M24308/23-26	HDC15F5B8000-50-376.6	M24308/23-233	HDC25F5B8000-50-403.0	M24308/23-41	HDC50F5B8000-50-376.5	M24308/23-249	HDC9F5B8000-50-403.43
M24308/23-26F	HDC15F5B800C-50-376.6	M24308/23-233F	HDC25F5B800C-50-403.0	M24308/23-41F	HDC50F5B800C-50-376.5	M24308/23-249F	HDC9F5B800C-50-403.43
M24308/23-26P	HDC15F5B800S-50-376.6	M24308/23-233P	HDC25F5B800S-50	M24308/23-41P	HDC50F5B800S-50-376.5	M24308/23-249P	HDC9F5B800S-50-376.8
M24308/23-126	HDC15F5B8000-50-403.34	M24308/23-333	HDC25F5B8000-50-799.12	M24308/23-141	HDC50F5B8000-50-403.38	M24308/23-349	HDC9F5B8000-50-799.15
M24308/23-226	HDC15F5B8000-50-403.35	M24308/23-34	HDC37F5B8000-50	M24308/23-241	HDC50F5B8000-50-403.39	M24308/23-50	HDC15F5B8000-50-376.8
M24308/23-226F	HDC15F5B800C-50-403.35	M24308/23-34F	HDC37F5B800C-50	M24308/23-241F	HDC50F5B800C-50-403.39	M24308/23-50F	HDC15F5B800C-50-376.8
M24308/23-226P	HDC15F5B800S-50-376.6	M24308/23-34P	HDC37F5B800S-50	M24308/23-241P	HDC50F5B800S-50-376.5	M24308/23-50P	HDC15F5B800S-50-376.8
M24308/23-326	HDC15F5B8000-50-799.11	M24308/23-134	HDC37F5B8000-50-403.36	M24308/23-341	HDC50F5B8000-50-799.13	M24308/23-150	HDC15F5B8000-50-403.42
M24308/23-27	HDC25F5B8000-50-376.6	M24308/23-234	HDC37F5B8000-50-403.0	M24308/23-43	HDC9F5B8000-50-376.2	M24308/23-250	HDC15F5B8000-50-403.43
M24308/23-27F	HDC25F5B800C-50-376.6	M24308/23-234F	HDC37F5B800C-50-403.0	M24308/23-43F	HDC9F5B800C-50-376.2	M24308/23-250F	HDC15F5B800C-50-403.43
M24308/23-27P	HDC25F5B800S-50-376.6	M24308/23-234P	HDC37F5B800S-50	M24308/23-43P	HDC9F5B800S-50-376.2	M24308/23-250P	HDC15F5B800S-50-376.8
M24308/23-127	HDC25F5B8000-50-403.34	M24308/23-334	HDC37F5B8000-50-799.12	M24308/23-143	HDC9F5B8000-50-403.48	M24308/23-350	HDC15F5B8000-50-799.15
M24308/23-227	HDC25F5B8000-50-403.35	M24308/23-35	HDC50F5B8000-50	M24308/23-243	HDC9F5B8000-50-403.49	M24308/23-51	HDC25F5B8000-50-376.8
M24308/23-227F	HDC25F5B800C-50-403.35	M24308/23-35F	HDC50F5B800C-50	M24308/23-243F	HDC9F5B800C-50-403.49	M24308/23-51F	HDC25F5B800C-50-376.8
M24308/23-227P	HDC25F5B800S-50-376.6	M24308/23-35P	HDC50F5B800S-50	M24308/23-243P	HDC9F5B800S-50-376.2	M24308/23-51P	HDC25F5B800S-50-376.8
M24308/23-327	HDC25F5B8000-50-799.11	M24308/23-135	HDC50F5B8000-50-403.36	M24308/23-343	HDC9F5B8000-50-799.18	M24308/23-151	HDC25F5B8000-50-403.42
M24308/23-28	HDC37F5B8000-50-376.6	M24308/23-235	HDC50F5B8000-50-403.0	M24308/23-44	HDC15F5B8000-50-376.2	M24308/23-251	HDC25F5B8000-50-403.43
M24308/23-28F	HDC37F5B800C-50-376.6	M24308/23-235F	HDC50F5B800C-50-403.0	M24308/23-44F	HDC15F5B800C-50-376.2	M24308/23-251F	HDC25F5B800C-50-403.43
M24308/23-28P	HDC37F5B800S-50-376.6	M24308/23-235P	HDC50F5B800S-50	M24308/23-44P	HDC15F5B800S-50-376.2	M24308/23-251P	HDC25F5B800S-50-376.8
M24308/23-128	HDC37F5B8000-50-403.34	M24308/23-335	HDC50F5B8000-50-799.12	M24308/23-144	HDC15F5B8000-50-403.48	M24308/23-351	HDC25F5B8000-50-799.15
M24308/23-228	HDC37F5B8000-50-403.35	M24308/23-37	HDC9F5B8000-50-376.5	M24308/23-244	HDC15F5B8000-50-403.49	M24308/23-52	HDC37F5B8000-50-376.8
M24308/23-228F	HDC37F5B800C-50-403.35	M24308/23-37F	HDC9F5B800C-50-376.5	M24308/23-244F	HDC15F5B800C-50-403.49	M24308/23-52F	HDC37F5B800C-50-376.8
M24308/23-228P	HDC37F5B800S-50-376.6	M24308/23-37P	HDC9F5B800S-50-376.5	M24308/23-244P	HDC15F5B800S-50-376.2	M24308/23-52P	HDC37F5B800S-50-376.8
M24308/23-328	HDC37F5B8000-50-799.11	M24308/23-137	HDC9F5B8000-50-403.38	M24308/23-344	HDC15F5B8000-50-799.18	M24308/23-152	HDC37F5B8000-50-403.42
M24308/23-29	HDC50F5B8000-50-376.6	M24308/23-237	HDC9F5B8000-50-403.39	M24308/23-45	HDC25F5B8000-50-376.2	M24308/23-252	HDC37F5B8000-50-403.43

MIL LISTING



Positronic Industries
connectpositronic.com

MIL-DTL-24308 / SAE AS 39029 / MIL-C-85049 QUALIFIED PRODUCTS LISTING

D-Sub

***NOTE:** Parts are to be ordered to the military number, the Positronic part number is for reference only.

Positronic HDC Series connectors are Q.P.L. approved to MIL-DTL-24308 per test report number 24308-618-79/24308-1210-85.
Positronic RD Series hoods are Q.P.L. approved to MIL-C-85049 per test report number 85049-870-84.
Positronic DD Series connectors are Q.P.L. approved to MIL-DTL-24308 per test report number 24308-1209-85/24308-1210-85/24308-117-89.
Positronic RD Series connectors are Q.P.L. approved to MIL-DTL-24308 per test report number 24308-211-79/24308-1210-85.
Positronic RD Series contacts are Q.P.L. approved to SAE AS 39029 per test report number 39029-694-79.

MILITARY PART NUMBER	REFERENCE NUMBER*	MILITARY PART NUMBER	REFERENCE NUMBER*	MILITARY PART NUMBER	REFERENCE NUMBER*	MILITARY PART NUMBER	REFERENCE NUMBER*
M24308/23-252F	HDC37F5B800C-50-403.43	M24308/23-61P	DD15F3P00S-50	M24308/23-268P	DD26F32P00S-50	M24308/23-76P	DD62F4B800S-50
M24308/23-252P	HDC37F5B800S-50-376.8	M24308/23-161	DD15F3P000-50-403.27	M24308/23-368	DD26F32P000-50-799.7	M24308/23-176	DD62F4B8000-50-403.36
M24308/23-352	HDC37F5B8000-50-799.15	M24308/23-261	DD15F3P000-50-403.0	M24308/23-69	DD44F32P000-50	M24308/23-276	DD62F4B8000-50-403.0
M24308/23-53	HDC50F5B8000-50-376.8	M24308/23-261F	DD15F3P00C-50-403.0	M24308/23-69F	DD44F32P00C-50	M24308/23-276F	DD62F4B800C-50-403.0
M24308/23-53F	HDC50F5B800C-50-376.8	M24308/23-261P	DD15F3P00S-50	M24308/23-69P	DD44F32P00S-50	M24308/23-276P	DD62F4B800S-50
M24308/23-53P	HDC50F5B800S-50-376.8	M24308/23-361	DD15F3P000-50-799.7	M24308/23-169	DD44F32P000-50-403.27	M24308/23-376	DD62F4B8000-50-799.12
M24308/23-153	HDC50F5B8000-50-403.42	M24308/23-62	DD26F3P000-50	M24308/23-269	DD44F32P000-50-403.0	M24308/23-77	DD78F4B8000-50
M24308/23-253	HDC50F5B8000-50-403.43	M24308/23-62F	DD26F3P00C-50	M24308/23-269F	DD44F32P00C-50-403.0	M24308/23-77F	DD78F4B800C-50
M24308/23-253F	HDC50F5B800C-50-403.43	M24308/23-62P	DD26F3P00S-50	M24308/23-269P	DD44F32P00S-50	M24308/23-77P	DD78F4B800S-50
M24308/23-253P	HDC50F5B800S-50-376.8	M24308/23-162	DD26F3P000-50-403.27	M24308/23-369	DD44F32P000-50-799.7	M24308/23-177	DD78F4B8000-50-403.36
M24308/23-353	HDC50F5B8000-50-799.15	M24308/23-262	DD26F3P000-50-403.0	M24308/23-70	DD62F32P000-50	M24308/23-277	DD78F4B8000-50-403.0
M24308/23-55	HDC9F5B8000-50-376.7	MM24308/23-262F	DD26F3P00C-50-403.0	M24308/23-70F	DD62F32P00C-50	M24308/23-277F	DD78F4B800C-50-403.0
M24308/23-55F	HDC9F5B800C-50-376.7	M24308/23-262P	DD26F3P00S-50	M24308/23-70P	DD62F32P00S-50	M24308/23-277P	DD78F4B800S-50
M24308/23-55P	HDC9F5B800S-50-376.7	M24308/23-362	DD26F3P000-50-799.7	M24308/23-170	DD62F32P000-50-403.27	M24308/23-377	DD78F4B8000-50-799.12
M24308/23-155	HDC9F5B8000-50-403.44	M24308/23-63	DD44F3P000-50	M24308/23-270	DD62F32P000-50-403.0	M24308/24-1	HDC9M3P000-50
M24308/23-255	HDC9F5B8000-50-403.45	M24308/23-63F	DD44F3P00C-50	M24308/23-270F	DD62F32P00C-50-403.0	M24308/24-1F	HDC9M3P00C-50
M24308/23-255F	HDC9F5B800C-50-403.45	M24308/23-63P	DD44F3P00S-50	M24308/23-270P	DD62F32P00S-50	M24308/24-1P	HDC9M3P00S-50
M24308/23-255P	HDC9F5B800S-50-376	M24308/23-163	DD44F3P000-50-403.27	M24308/23-370	DD62F32P000-50-799.7	M24308/24-101	HDC9M3P000-50-403.27
M24308/23-355	HDC9F5B8000-50-799.16	M24308/23-263	DD44F3P000-50-403.0	M24308/23-71	DD78F32P000-50	M24308/24-201	HDC9M3P000-50-403.0
M24308/23-56	HDC15F5B8000-50-376.7	M24308/23-263F	DD44F3P00C-50-403.0	M24308/23-71F	DD78F32P00C-50	M24308/24-201F	HDC9M3P00C-50-403.0
M24308/23-56F	HDC15F5B800C-50-376.7	M24308/23-263P	DD44F3P00S-50	M24308/23-71P	DD78F32P00S-50	M24308/24-201P	HDC9M3P00S-50
M24308/23-56P	HDC15F5B800S-50-376.7	M24308/23-363	DD44F3P000-50-799.7	M24308/23-171	DD78F32P000-50-403.27	M24308/24-201P	HDC9M3P000-50-799.7
M24308/23-156	HDC15F5B8000-50-403.44	M24308/23-64	DD62F3P000-50	M24308/23-271	DD78F32P000-50-403.0	M24308/24-2	HDC15M3P000-50
M24308/23-256	HDC15F5B8000-50-403.45	M24308/23-64F	DD62F3P00C-50	M24308/23-271F	DD78F32P00C-50-403.0	M24308/24-2F	HDC15M3P00C-50
M24308/23-256F	HDC15F5B800C-50-403.45	M24308/23-64P	DD62F3P00S-50	M24308/23-271P	DD78F32P00S-50	M24308/24-2P	HDC15M3P00S-50
M24308/23-256P	HDC15F5B800S-50-376.7	M24308/23-164	DD62F3P000-50-403.27	M24308/23-371	DD78F32P000-50-799.7	M24308/24-102	HDC15M3P000-50-403.27
M24308/23-356	HDC15F5B8000-50-799.16	M24308/23-264	DD62F3P000-50-403.0	M24308/23-73	DD15F4B8000-50	M24308/24-202	HDC15M3P000-50-403.0
M24308/23-57	HDC25F5B8000-50-376.7	M24308/23-264F	DD62F3P00C-50-403.0	M24308/23-73F	DD15F4B800C-50	M24308/24-202F	HDC15M3P00C-50-403.0
M24308/23-57F	HDC25F5B800C-50-376.7	M24308/23-264P	DD62F3P00S-50	M24308/23-73P	DD15F4B800S-50	M24308/24-202P	HDC15M3P00S-50
M24308/23-57P	HDC25F5B800S-50-376.7	M24308/23-364	DD62F3P000-50-799.7	M24308/23-173	DD15F4B8000-50-403.36	M24308/24-302	HDC15M3P000-50-799.7
M24308/23-157	HDC25F5B8000-50-403.44	M24308/23-65	DD78F3P000-50	M24308/23-273	DD15F4B8000-50-403.0	M24308/24-3	HDC25M3P000-50
M24308/23-257	HDC25F5B8000-50-403.45	M24308/23-65F	DD78F3P00C-50	M24308/23-273F	DD15F4B800C-50-403.0	M24308/24-3F	HDC25M3P00C-50
M24308/23-257F	HDC25F5B800C-50-403.45	M24308/23-65P	DD78F3P00S-50	M24308/23-273P	DD15F4B800S-50	M24308/24-3P	HDC25M3P00S-50
M24308/23-257P	HDC25F5B800S-50-376.7	M24308/23-165	DD78F3P000-50-403.27	M24308/23-373	DD15F4B8000-50-799.12	M24308/24-103	HDC25M3P000-50-403.27
M24308/23-357	HDC25F5B8000-50-799.16	M24308/23-265	DD78F3P000-50-403.0	M24308/23-74	DD26F4B8000-50	M24308/24-203	HDC25M3P000-50-403.0
M24308/23-58	HDC37F5B8000-50-376.7	M24308/23-265F	DD78F3P00C-50-403.0	M24308/23-74F	DD26F4B800C-50	M24308/24-203F	HDC25M3P00C-50-403.0
M24308/23-58F	HDC37F5B800C-50-376.7	M24308/23-265P	DD78F3P00S-50	M24308/23-74P	DD26F4B800S-50	M24308/24-203P	HDC25M3P00S-50
M24308/23-58P	HDC37F5B800S-50-376.7	M24308/23-365	DD78F3P000-50-799.7	M24308/23-174	DD26F4B8000-50-403.36	M24308/24-303	HDC25M3P000-50-799.7
M24308/23-158	HDC37F5B8000-50-403.44	M24308/23-67	DD15F32P000-50	M24308/23-274	DD26F4B8000-50-403.0	M24308/24-4	HDC37M3P000-50
M24308/23-258	HDC37F5B8000-50-403.45	M24308/23-67F	DD15F32P00C-50	M24308/23-274F	DD26F4B800C-50-403.0	M24308/24-4F	HDC37M3P00C-50
M24308/23-258F	HDC37F5B800C-50-403.45	M24308/23-67P	DD15F32P00S-50	M24308/23-274P	DD26F4B800S-50	M24308/24-4P	HDC37M3P00S-50
M24308/23-258P	HDC37F5B800S-50-376.7	M24308/23-167	DD15F32P000-50-403.27	M24308/23-374	DD26F4B8000-50-799.12	M24308/24-104	HDC37M3P000-50-403.27
M24308/23-358	HDC37F5B8000-50-799.16	M24308/23-267	DD15F32P000-50-403.0	M24308/23-75	DD44F4B8000-50	M24308/24-204	HDC37M3P000-50-403.0
M24308/23-59	HDC50F5B8000-50-376.7	M24308/23-267F	DD15F32P00C-50-403.0	M24308/23-75F	DD44F4B800C-50	M24308/24-204F	HDC37M3P00C-50-403.0
M24308/23-59F	HDC50F5B800C-50-376.7	M24308/23-267P	DD15F32P00S-50	M24308/23-75P	DD44F4B800S-50	M24308/24-204P	HDC37M3P00S-50
M24308/23-59P	HDC50F5B800S-50-376.7	M24308/23-367	DD15F32P000-50-799.7	M24308/23-175	DD44F4B8000-50-403.36	M24308/24-304	HDC37M3P000-50-799.7
M24308/23-159	HDC50F5B8000-50-403.44	M24308/23-68	DD26F32P000-50	M24308/23-275	DD44F4B8000-50-403.0	M24308/24-5	HDC50M3P000-50
M24308/23-259	HDC50F5B8000-50-403.45	M24308/23-68F	DD26F32P00C-50	M24308/23-275F	DD44F4B800C-50-403.0	M24308/24-5F	HDC50M3P00C-50
M24308/23-259F	HDC50F5B800C-50-376.7	M24308/23-68P	DD26F32P00S-50	M24308/23-275P	DD44F4B800S-50	M24308/24-5P	HDC50M3P00S-50
M24308/23-359	HDC50F5B8000-50-799.16	M24308/23-168	DD26F32P000-50-403.27	M24308/23-375	DD44F4B8000-50-799.12	M24308/24-105	HDC50M3P000-50-403.27
M24308/23-61	DD15F3P000-50	M2M24308/23-268	DD26F32P000-50-403.0	M24308/23-76	DD62F4B8000-50	M24308/24-205	HDC50M3P000-50-403.0
M24308/23-61F	DD15F3P00C-50	M24308/23-268F	DD26F32P00C-50-403.0	M24308/23-76F	DD62F4B800C-50	M24308/24-205F	HDC50M3P00C-50-403.0

MIL LISTING



***NOTE:** Parts are to be ordered to the military number, the Positronic part number is for reference only.

Positronic HDC Series connectors are Q.P.L. approved to MIL-DTL-24308 per test report number 24308-618-79/24308-1210-85.
 Positronic RD Series hoods are Q.P.L. approved to MIL-C-85049 per test report number 85049-870-84.
 Positronic DD Series connectors are Q.P.L. approved to MIL-DTL-24308 per test report number 24308-1209-85/24308-1210-85/24308-117-89.
 Positronic RD Series connectors are Q.P.L. approved to MIL-DTL-24308 per test report number 24308-211-79/24308-1210-85.
 Positronic RD Series contacts are Q.P.L. approved to SAE AS 39029 per test report number 39029-694-79.

MILITARY PART NUMBER	REFERENCE NUMBER*	MILITARY PART NUMBER	REFERENCE NUMBER*	MILITARY PART NUMBER	REFERENCE NUMBER*	MILITARY PART NUMBER	REFERENCE NUMBER*
M24308/24-205P	HDC50M3P00S-50	M24308/24-14P	HDC15M3P00S-50-375.3	M24308/24-221P	HDC25M3P00S-50-375.9	M24308/24-129	HDC50M5B8000-50-403.34
M24308/24-305	HDC50M3P000-50-799.7	M24308/24-114	HDC15M3P000-50-403.30	M24308/24-321	HDC25M3P000-50-799.10	M24308/24-229	HDC50M5B8000-50-403.35
M24308/24-7	HDC9M3P000-50-375.10	M24308/24-214	HDC15M3P000-50-403.31	M24308/24-22	HDC37M3P000-50-375.9	M24308/24-229F	HDC50M5B800C-50-403.35
M24308/24-7F	HDC9M3P00C-50-375.10	M24308/24-214F	HDC15M3P00C-50-403.31	M24308/24-22F	HDC37M3P00C-50-375.9	M24308/24-229P	HDC50M5B800S-50-376.6
M24308/24-7P	HDC9M3P00S-50-375.10	M24308/24-214P	HDC15M3P00S-50-375.3	M24308/24-22P	HDC37M3P00S-50-375.9	M24308/24-329	HDC50M5B8000-50-799.11
M24308/24-107	HDC9M3P000-50-403.28	M24308/24-314	HDC15M3P000-50-799.9	M24308/24-122	HDC37M3P000-50-403.32	M24308/24-31	HDC9M5B8000-50
M24308/24-207	HDC9M3P000-50-403.29	M24308/24-15	HDC25M3P000-50-375.3	M24308/24-222	HDC37M3P000-50-403.33	M24308/24-31F	HDC9M5B800C-50
M24308/24-207F	HDC9M3P00C-50-403.29	M24308/24-15F	HDC25M3P00C-50-375.3	M24308/24-212F	HDC37M3P00C-50-403.33	M24308/24-31P	HDC9M5B800S-50
M24308/24-207P	HDC9M3P00S-50-375.10	M24308/24-15P	HDC25M3P00S-50-375.3	M24308/24-222P	HDC37M3P00S-50-375.9	M24308/24-131	HDC9M5B8000-50-403.36
M24308/24-307	HDC9M3P000-50-799.8	M24308/24-115	HDC25M3P000-50-403.30	M24308/24-322	HDC37M3P000-50-799.10	M24308/24-231	HDC9M5B8000-50-403.37
M24308/24-8	HDC15M3P000-50-375.10	M24308/24-215	HDC25M3P000-50-403.31	M24308/24-23	HDC50M3P000-50-375.9	M24308/24-231F	HDC9M5B800C-50-403.37
M24308/24-8F	HDC15M3P00C-50-375.10	M24308/24-215F	HDC25M3P00C-50-403.31	M24308/24-23F	HDC50M3P00C-50-375.9	M24308/24-231P	HDC9M5B800S-50
M24308/24-8P	HDC15M3P00S-50-375.10	M24308/24-215P	HDC25M3P00S-50-375.3	M24308/24-23P	HDC50M3P00S-50-375.9	M24308/24-331	HDC9M5B8000-50-799.12
M24308/24-108	HDC15M3P000-50-403.28	M24308/24-315	HDC25M3P000-50-799.9	M24308/24-123	HDC50M3P000-50-403.32	M24308/24-32	HDC15M5B8000-50
M24308/24-208	HDC15M3P000-50-403.29	M24308/24-16	HDC37M3P000-50-375.3	M24308/24-223	HDC50M3P000-50-403.33	M24308/24-32F	HDC15M5B800C-50
M24308/24-208F	HDC15M3P00C-50-403.29	M24308/24-16F	HDC37M3P00C-50-375.3	M24308/24-223F	HDC50M3P00C-50-375.9	M24308/24-32P	HDC15M5B800S-50
M24308/24-208P	HDC15M3P00S-50-375.10	M24308/24-16P	HDC37M3P00S-50-375.3	M24308/24-323	HDC50M3P000-50-799.10	M24308/24-132	HDC15M5B8000-50-403.36
M24308/24-308	HDC15M3P000-50-799.8	M24308/24-116	HDC37M3P000-50-403.30	M24308/24-25	HDC9M5B8000-50-376.6	M24308/24-232	HDC15M5B8000-50-403.37
M24308/24-9	HDC25M3P000-50-375.10	M24308/24-216	HDC37M3P000-50-403.31	M24308/24-25F	HDC9M5B800C-50-376.6	M24308/24-232F	HDC15M5B800C-50-403.37
M24308/24-9F	HDC25M3P00C-50-375.10	M24308/24-216F	HDC37M3P00C-50-403.31	M24308/24-25P	HDC9M5B800S-50-376.6	M24308/24-232P	HDC15M5B800S-50
M24308/24-9P	HDC25M3P00S-50-375.10	M24308/24-216P	HDC37M3P00S-50-375.3	M24308/24-125	HDC9M5B8000-50-403.34	M24308/24-332	HDC15M5B8000-50-799.12
M24308/24-109	HDC25M3P000-50-403.28	M24308/24-316	HDC37M3P000-50-799.9	M24308/24-225	HDC9M5B8000-50-403.35	M24308/24-33	HDC25M5B8000-50
M24308/24-209	HDC25M3P000-50-403.29	M24308/24-17	HDC50M3P000-50-375.3	M24308/24-225F	HDC9M5B800C-50-403.35	M24308/24-33F	HDC25M5B800C-50
M24308/24-209F	HDC25M3P00C-50-403.29	M24308/24-17F	HDC50M3P00C-50-375.3	M24308/24-225P	HDC9M5B800S-50-376.6	M24308/24-33P	HDC25M5B800S-50
M24308/24-209P	HDC25M3P00S-50-375.10	M24308/24-17P	HDC50M3P00S-50-375.3	M24308/24-325	HDC9M5B8000-50-799.11	M24308/24-133	HDC25M5B8000-50-403.36
M24308/24-309	HDC25M3P000-50-799.8	M24308/24-117	HDC50M3P000-50-403.30	M24308/24-26	HDC15M5B8000-50-376.6	M24308/24-233	HDC25M5B8000-50-403.37
M24308/24-10	HDC37M3P000-50-375.10	M24308/24-217	HDC50M3P000-50-403.31	M24308/24-26F	HDC15M5B800C-50-376.6	M24308/24-233F	HDC25M5B800C-50-403.37
M24308/24-10F	HDC37M3P00C-50-375.10	M24308/24-217F	HDC50M3P00C-50-403.31	M24308/24-26P	HDC15M5B800S-50-376.6	M24308/24-233P	HDC25M5B800S-50
M24308/24-10P	HDC37M3P00S-50-375.10	M24308/24-217P	HDC50M3P00S-50-375.3	M24308/24-126	HDC15M5B8000-50-403.34	M24308/24-333	HDC25M5B8000-50-799.12
M24308/24-110	HDC37M3P000-50-403.28	M24308/24-317	HDC50M3P000-50-799.9	M24308/24-226	HDC15M5B8000-50-403.35	M24308/24-34	HDC37M5B8000-50
M24308/24-210	HDC37M3P000-50-403.29	M24308/24-19	HDC9M3P000-50-375.9	M24308/24-226F	HDC15M5B800C-50-403.35	M24308/24-34F	HDC37M5B800C-50
M24308/24-210F	HDC37M3P00C-50-403.29	M24308/24-19F	HDC9M3P00C-50-375.9	M24308/24-226P	HDC15M5B800S-50-376.6	M24308/24-34P	HDC37M5B800S-50
M24308/24-210P	HDC37M3P00S-50-375.10	M24308/24-19P	HDC9M3P00S-50-375.9	M24308/24-326	HDC15M5B8000-50-799.11	M24308/24-134	HDC37M5B8000-50-403.36
M24308/24-310	HDC37M3P000-50-799.8	M24308/24-119	HDC9M3P000-50-403.32	M24308/24-27	HDC25M5B8000-50-376.6	M24308/24-234	HDC37M5B8000-50-403.37
M24308/24-11	HDC50M3P000-50-375.10	M24308/24-219	HDC9M3P000-50-403.33	M24308/24-27F	HDC25M5B800C-50-376.6	M24308/24-234F	HDC37M5B800C-50-403.37
M24308/24-11F	HDC50M3P00C-50-375.10	M24308/24-219F	HDC9M3P00C-50-403.33	M24308/24-27P	HDC25M5B800S-50-376.6	M24308/24-234P	HDC37M5B800S-50
M24308/24-11P	HDC50M3P00S-50-375.10	M24308/24-219P	HDC9M3P00S-50-375.9	M24308/24-127	HDC25M5B8000-50-403.34	M24308/24-334	HDC37M5B8000-50-799.12
M24308/24-111	HDC50M3P000-50-403.28	M24308/24-319	HDC9M3P000-50-799.10	M24308/24-227	HDC25M5B8000-50-403.35	M24308/24-35	HDC50M5B8000-50
M24308/24-211	HDC50M3P000-50-403.29	M24308/24-20	HDC15M3P000-50-375.9	M24308/24-227F	HDC25M5B800C-50-403.35	M24308/24-35F	HDC50M5B800C-50
M24308/24-211F	HDC50M3P00C-50-403.29	M24308/24-20F	HDC15M3P00C-50-375.9	M24308/24-227P	HDC25M5B800S-50-376.6	M24308/24-35P	HDC50M5B800S-50
M24308/24-211P	HDC50M3P00S-50-375.10	M24308/24-20P	HDC15M3P00S-50-375.9	M24308/24-327	HDC25M5B8000-50-799.11	M24308/24-135	HDC50M5B8000-50-403.36
M24308/24-311	HDC50M3P000-50-799.8	M24308/24-120	HDC15M3P000-50-403.32	M24308/24-28	HDC37M5B8000-50-376.6	M24308/24-235	HDC50M5B8000-50-403.37
M24308/24-13	HDC9M3P000-50-375.3	M24308/24-220	HDC15M3P000-50-403.33	M24308/24-28F	HDC37M5B800C-50-376.6	M24308/24-235F	HDC50M5B800C-50-403.37
M24308/24-13F	HDC9M3P00C-50-375.3	M24308/24-220F	HDC15M3P00C-50-403.33	M24308/24-28P	HDC37M5B800S-50-376.6	M24308/24-235P	HDC50M5B800S-50
M24308/24-13P	HDC9M3P00S-50-375.3	M24308/24-220P	HDC15M3P00S-50-375.9	M24308/24-128	HDC37M5B8000-50-403.34	M24308/24-335	HDC50M5B8000-50-799.12
M24308/24-113	HDC9M3P000-50-403.30	M24308/24-320	HDC15M3P000-50-799.10	M24308/24-228	HDC37M5B8000-50-403.35	M24308/24-37	HDC9M5B8000-50-376.5
M24308/24-213	HDC9M3P000-50-403.31	M24308/24-21	HDC25M3P000-50-375.9	M24308/24-228F	HDC37M5B800C-50-403.35	M24308/24-37F	HDC9M5B800C-50-376.5
M24308/24-213F	HDC9M3P00C-50-403.31	M24308/24-21F	HDC25M3P00C-50-375.9	M24308/24-228P	HDC37M5B800S-50-376.6	M24308/24-37P	HDC9M5B800S-50-376.5
M24308/24-213P	HDC9M3P00S-50-375.3	M24308/24-21P	HDC25M3P00S-50-375.9	M24308/24-328	HDC37M5B8000-50-799.11	M24308/24-137	HDC9M5B8000-50-403.38
M24308/24-313	HDC9M3P000-50-799.9	M24308/24-121	HDC25M3P000-50-403.32	M24308/24-29	HDC50M5B8000-50-376.6	M24308/24-237	HDC9M5B8000-50-403.39
M24308/24-14	HDC15M3P000-50-375.3	M24308/24-221	HDC25M3P000-50-403.33	M24308/24-29F	HDC50M5B800C-50-376.6	M24308/24-237F	HDC9M5B800C-50-403.39
M24308/24-14F	HDC15M3P00C-50-375.3	M24308/24-221F	HDC25M3P00C-50-403.33	M24308/24-29P	HDC50M5B800S-50-376.6	M24308/24-237P	HDC9M5B800S-50-376.5



Positronic Industries
connectpositronic.com

MIL-DTL-24308 / SAE AS 39029 / MIL-C-85049 QUALIFIED PRODUCTS LISTING

D-Sub

***NOTE:** Parts are to be ordered to the military number, the Positronic part number is for reference only.

Positronic HDC Series connectors are Q.P.L. approved to MIL-DTL-24308 per test report number 24308-618-79/24308-1210-85.

Positronic RD Series hoods are Q.P.L. approved to MIL-C-85049 per test report number 85049-870-84.

Positronic DD Series connectors are Q.P.L. approved to MIL-DTL-24308 per test report number 24308-1209-85/24308-1210-85/24308-117-89.

Positronic RD Series connectors are Q.P.L. approved to MIL-DTL-24308 per test report number 24308-211-79/24308-1210-85.

Positronic RD Series contacts are Q.P.L. approved to SAE AS 39029 per test report number 39029-694-79.

MILITARY PART NUMBER	REFERENCE NUMBER*	MILITARY PART NUMBER	REFERENCE NUMBER*	MILITARY PART NUMBER	REFERENCE NUMBER*	MILITARY PART NUMBER	REFERENCE NUMBER*
M24308/24-337	HDC9M5B8000-50-799.13	M24308/24-145	HDC25M5B8000-50-403.40	M24308/24-352	HDC37M5B8000-50-799.15	M24308/24-161	DD15M3P000-50-403.27
M24308/24-38	HDC15M5B8000-50-376.5	M24308/24-245	HDC25M5B8000-50-403.41	M24308/24-53	HDC50M5B8000-50-376.8	M24308/24-261	DD15M3P000-50-403.0
M24308/24-38F	HDC15M5B800C-50-376.5	M24308/24-245F	HDC25M5B800C-50-403.41	M24308/24-53F	HDC50M5B800C-50-376.8	M24308/24-261F	DD15M3P00C-50-403.0
M24308/24-38P	HDC15M5B800S-50-376.5	M24308/24-245P	HDC25M5B800S-50-376.3	M24308/24-53P	HDC50M5B800S-50-376.8	M24308/24-261P	DD15M3P00S-50
M24308/24-138	HDC15M5B8000-50-403.38	M24308/24-345	HDC25M5B8000-50-799.14	M24308/24-153	HDC50M5B8000-50-403.42	M24308/24-361	DD15M3P000-50-799.7
M24308/24-238	HDC15M5B8000-50-403.39	M24308/24-46	HDC37M5B8000-50-376.3	M24308/24-253	HDC50M5B8000-50-403.43	M24308/24-62	DD26M3P000-50
M24308/24-238F	HDC15M5B800C-50-403.39	M24308/24-46F	HDC37M5B800C-50-376.3	M24308/24-253F	HDC50M5B800C-50-403.43	M24308/24-62F	DD26M3P00C-50
M24308/24-238P	HDC15M5B800S-50-376.5	M24308/24-46P	HDC37M5B800S-50-376.3	M24308/24-253P	HDC50M5B800S-50-376.8	M24308/24-62P	DD26M3P00S-50
M24308/24-338	HDC15M5B8000-50-799.13	M24308/24-146	HDC37M5B8000-50-403.40	M24308/24-353	HDC50M5B8000-50-799.15	M24308/24-162	DD26M3P000-50-403.27
M24308/24-39	HDC25M5B8000-50-376.5	M24308/24-246	HDC37M5B8000-50-403.41	M24308/24-55	HDC9M5B8000-50-376.7	M24308/24-262	DD26M3P000-50-403.0
M24308/24-39F	HDC25M5B800C-50-376.5	M24308/24-246F	HDC37M5B800C-50-403.41	M24308/24-55F	HDC9M5B800C-50-376.7	M24308/24-262F	DD26M3P00C-50-403.0
M24308/24-39P	HDC25M5B800S-50-376.5	M24308/24-249P	HDC37M5B800S-50-376.3	M24308/24-55P	HDC9M5B800S-50-376.7	M24308/24-262P	DD26M3P00S-50
M24308/24-139	HDC25M5B8000-50-403.38	M24308/24-346	HDC37M5B8000-50-799.14	M24308/24-155	HDC9M5B8000-50-403.44	M24308/24-362	DD26M3P000-50-799.7
M24308/24-239	HDC25M5B8000-50-403.39	M24308/24-47	HDC50M5B8000-50-376.3	M24308/24-255	HDC9M5B8000-50-403.45	M24308/24-63	DD44M3P000-50-403.0
M24308/24-239F	HDC25M5B800C-50-403.39	M24308/24-47F	HDC50M5B800C-50-376.3	M24308/24-255F	HDC9M5B800C-50-403.45	M24308/24-63F	DD44M3P00C-50
M24308/24-239P	HDC25M5B800S-50-376.5	M24308/24-47P	HDC50M5B800S-50-376.3	M24308/24-255P	HDC9M5B800S-50-376.7	M24308/24-63P	DD44M3P00S-50
M24308/24-339	HDC25M5B8000-50-799.13	M24308/24-147	HDC50M5B8000-50-403.40	M24308/24-355	HDC9M5B8000-50-799.16	M24308/24-163	DD44M3P000-50-403.27
M24308/24-40	HDC37M5B8000-50-376.5	M24308/24-247	HDC50M5B8000-50-403.41	M24308/24-56	HDC15M5B8000-50-376.7	M24308/24-263	DD44M3P000-50-403.0
M24308/24-40F	HDC37M5B800C-50-376.5	M24308/24-247F	HDC50M5B800C-50-403.41	M24308/24-56F	HDC15M5B800C-50-376.7	M24308/24-263F	DD44M3P00C-50-403.0
M24308/24-40P	HDC37M5B800S-50-376.5	M24308/24-247P	HDC50M5B800S-50-376.3	M24308/24-56P	HDC15M5B800S-50-376.7	M24308/24-263P	DD44M3P00S-50
M24308/24-140	HDC37M5B8000-50-403.38	M24308/24-347	HDC50M5B8000-50-799.14	M24308/24-156	HDC15M5B8000-50-403.44	M24308/24-363	DD44M3P000-50-799.7
M24308/24-240	HDC37M5B8000-50-403.39	M24308/24-49	HDC9M5B8000-50-376.8	M24308/24-256	HDC15M5B8000-50-403.45	M24308/24-64	DD62M3P000-50
M24308/24-240F	HDC37M5B800C-50-403.39	M24308/24-49F	HDC9M5B800C-50-376.8	M24308/24-256F	HDC15M5B800C-50-403.45	M24308/24-64F	DD62M3P00C-50
M24308/24-240P	HDC37M5B800S-50-376.5	M24308/24-49P	HDC9M5B800S-50-376.8	M24308/24-256P	HDC15M5B800S-50-376.7	M24308/24-64P	DD62M3P00S-50
M24308/24-340	HDC37M5B8000-50-799.13	M24308/24-149	HDC9M5B8000-50-403.42	M24308/24-356	HDC15M5B8000-50-799.16	M24308/24-164	DD62M3P000-50-403.27
M24308/24-41	HDC50M5B8000-50-376.5	M24308/24-249	HDC9M5B800C-50-403.43	M24308/24-57	HDC25M5B8000-50-376.7	M24308/24-264	DD62M3P000-50-403.0
M24308/24-41F	HDC50M5B800C-50-376.5	M24308/24-249F	HDC9M5B800C-50-403.43	M24308/24-57F	HDC25M5B800C-50-376.7	M24308/24-264F	DD62M3P00C-50-403.0
M24308/24-41P	HDC50M5B800S-50-376.5	M24308/24-249P	HDC9M5B800S-50-376.8	M24308/24-57P	HDC25M5B800S-50-376.7	M24308/24-264P	DD62M3P00S-50
M24308/24-141	HDC50M5B8000-50-403.38	M24308/24-349	HDC9M5B8000-50-799.15	M24308/24-157	HDC25M5B8000-50-403.44	M24308/24-364	DD62M3P000-50-799.7
M24308/24-241	HDC50M5B8000-50-403.39	M24308/24-50	HDC15M5B8000-50-376.8	M24308/24-257	HDC25M5B8000-50-403.45	M24308/24-65	DD78M3P000-50
M24308/24-241F	HDC50M5B800C-50-403.39	M24308/24-50F	HDC15M5B800C-50-376.8	M24308/24-257F	HDC25M5B800C-50-403.45	M24308/24-65F	DD78M3P00C-50
M24308/24-241P	HDC50M5B800S-50-376.5	M24308/24-50P	HDC15M5B800S-50-376.8	M24308/24-257P	HDC25M5B800S-50-376.7	M24308/24-65P	DD78M3P00S-50
M24308/24-341	HDC50M5B8000-50-799.13	M24308/24-150	HDC15M5B8000-50-403.42	M24308/24-357	HDC25M5B8000-50-799.16	M24308/24-165	DD78M3P000-50-403.27
M24308/24-43	HDC9M5B8000-50-376.3	M24308/24-250	HDC15M5B8000-50-403.43	M24308/24-58	HDC37M5B8000-50-376.7	M24308/24-265	DD78M3P000-50-403.0
M24308/24-43F	HDC9M5B800C-50-376.5	M24308/24-250F	HDC15M5B800C-50-403.43	M24308/24-58F	HDC37M5B800C-50-376.7	M24308/24-265F	DD78M3P00C-50-403.0
M24308/24-43P	HDC9M5B800S-50-376.3	M24308/24-250P	HDC15M5B800S-50-376.8	M24308/24-58P	HDC37M5B800S-50-376.7	M24308/24-265P	DD78M3P00S-50
M24308/24-143	HDC9M5B8000-50-403.40	M24308/24-350	HDC15M5B8000-50-799.15	M24308/24-158	HDC37M5B8000-50-403.44	M24308/24-365	DD78M3P000-50-799.7
M24308/24-243	HDC9M5B8000-50-403.41	M24308/24-51	HDC25M5B8000-50-376.8	M24308/24-258	HDC37M5B8000-50-403.45	M24308/24-67	DD15M32P000-50
M24308/24-243F	HDC9M5B800C-50-403.41	M24308/24-51F	HDC25M5B800C-50-376.8	M24308/24-258F	HDC37M5B800C-50-403.45	M24308/24-67F	DD15M32P00C-50
M24308/24-243P	HDC9M5B800S-50-376.3	M24308/24-51P	HDC25M5B800S-50-376.8	M24308/24-258P	HDC37M5B800S-50-376.7	M24308/24-67P	DD15M32P00S-50
M24308/24-343	HDC9M5B8000-50-799.14	M24308/24-151	HDC25M5B8000-50-403.42	M24308/24-358	HDC37M5B8000-50-799.16	M24308/24-167	DD15M32P000-50-403.27
M24308/24-44	HDC15M5B8000-50-376.3	M24308/24-251	HDC25M5B8000-50-403.43	M24308/24-59	HDC50M5B8000-50-376.7	M24308/24-267	DD15M32P000-50-403.0
M24308/24-44F	HDC15M5B800C-50-376.3	M24308/24-251F	HDC25M5B800C-50-403.43	M24308/24-59F	HDC50M5B800C-50-376.7	M24308/24-267F	DD15M32P00C-50-403.0
M24308/24-44P	HDC15M5B800S-50-376.3	M24308/24-251P	HDC25M5B800S-50-376.8	M24308/24-59P	HDC50M5B800S-50-376.7	M24308/24-267P	DD15M32P00S-50
M24308/24-144	HDC15M5B8000-50-403.40	M24308/24-351	HDC25M5B8000-50-799.15	M24308/24-159	HDC50M5B8000-50-403.44	M24308/24-367	DD15M32P000-50-799.7
M24308/24-244	HDC15M5B8000-50-403.41	M24308/24-52	HDC37M5B8000-50-376.8	M24308/24-259	HDC50M5B8000-50-403.45	M24308/24-68	DD26M32P000-50
M24308/24-244F	HDC15M5B800C-50-403.41	M24308/24-52F	HDC37M5B800C-50-376.8	M24308/24-259F	HDC50M5B800C-50-403.45	M24308/24-68F	DD26M32P00C-50
M24308/24-244P	HDC15M5B800S-50-376.3	M24308/24-52P	HDC37M5B800S-50-376.8	M24308/24-259P	HDC50M5B800S-50-376.7	M24308/24-68P	DD26M32P00S-50
M24308/24-344	HDC15M5B8000-50-799.14	M24308/24-152	HDC37M5B8000-50-403.42	M24308/24-359	HDC50M5B8000-50-799.16	M24308/24-168	DD26M32P000-50-403.27
M24308/24-45	HDC25M5B8000-50-376.3	M24308/24-252	HDC37M5B8000-50-403.43	M24308/24-61	DD15M3P000-50	M24308/24-268	DD26M32P000-50-403.0
M24308/24-45F	HDC25M5B800C-50-376.3	M24308/24-252F	HDC37M5B800C-50-403.43	M24308/24-61F	DD15M3P00C-50	M24308/24-268F	DD26M32P00C-50-403.0
M24308/24-45P	HDC25M5B800S-50-376.3	M24308/24-252P	HDC37M5B800S-50-376.8	M24308/24-61P	DD15M3P00S-50	M24308/24-268P	DD26M32P00S-50

MIL LISTING



***NOTE:** Parts are to be ordered to the military number, the Positronic part number is for reference only.

Positronic HDC Series connectors are Q.P.L. approved to MIL-DTL-24308 per test report number 24308-618-79/24308-1210-85.
 Positronic RD Series hoods are Q.P.L. approved to MIL-C-85049 per test report number 85049-870-84.
 Positronic DD Series connectors are Q.P.L. approved to MIL-DTL-24308 per test report number 24308-1209-85/24308-1210-85/24308-117-89.
 Positronic RD Series connectors are Q.P.L. approved to MIL-DTL-24308 per test report number 24308-211-79/24308-1210-85.
 Positronic RD Series contacts are Q.P.L. approved to SAE SAS 39029 per test report number 39029-694-79.

MILITARY PART NUMBER	REFERENCE NUMBER*	MILITARY PART NUMBER	REFERENCE NUMBER*	MILITARY PART NUMBER	REFERENCE NUMBER*	MILITARY PART NUMBER	REFERENCE NUMBER*
M24308/24-368	DD26M32P000-50-799.7	M24308/24-176	DD62M4B8000-50-403.36				
M24308/24-69	DD44M32P000-50	M24308/24-276	DD62M4B8000-50-403.0				
M24308/24-69F	DD44M32P00C-50	M24308/24-276F	DD62M4B800C-50-403.0				
M24308/24-69P	DD44M32P00S-50	M24308/24-276P	DD62M4B800S-50				
M24308/24-169	DD44M32P000-50-403.27	M24308/24-376	DD62M4B8000-50-799.12				
M24308/24-269	DD44M32P000-50-403.0	M24308/24-77	DD78M4B8000-50				
M24308/24-269F	DD44M32P00C-50-403.0	M24308/24-77F	DD78M4B800C-50				
M24308/24-269P	DD44M32P00S-50	M24308/24-77P	DD78M4B800S-50				
M24308/24-369	DD44M32P000-50-799.7	M24308/24-177	DD78M4B8000-50-403.36				
M24308/24-70	DD62M32P000-50	M24308/24-277	DD78M4B8000-50-403.0				
M24308/24-70F	DD62M32P00C-50	M24308/24-277F	DD78M4B800C-50-403.0				
M24308/24-70P	DD62M32P00S-50	M24308/24-277P	DD78M4B800S-50				
M24308/24-170	DD62M32P000-50-403.27	M24308/24-377	DD78M4B8000-50-799.12				
M24308/24-270	DD62M32P000-50-403.0	M24308/25-6	D00000E20				
M24308/24-270F	DD62M32P00C-50-403.0	M24308/25-6F	D00000E20-462.31				
M24308/24-270P	DD62M32P00S-50	M24308/25-6P	D00000E20-462.23				
M24308/24-370	DD62M32P000-50-799.7	M24308/26-1	D00000T20-462.32				
M24308/24-71	DD78M32P000-50	M24308/26-1F	D00000T20-462.33				
M24308/24-71F	DD78M32P00C-50	M24308/26-1P	D00000T20-462.7				
M24308/24-71P	DD78M32P00S-50	M24308/26-2	D00000T30-462.32				
M24308/24-171	DD78M32P000-50-403.27	M24308/26-2F	D00000T30-462.33				
M24308/24-271	DD78M32P000-50-403.0	M24308/26-2P	D00000T30-462.7				
M24308/24-271F	DD78M32P00C-50-403.0	CRIMP CONTACTS					
M24308/24-271P	DD78M32P00S-50	M39029/57-354	FC8022D-50				
M24308/24-371	DD78M32P000-50-799.7	M39029/58-360	MC8022D-50				
M24308/24-73	DD15M4B8000-50	M39029/63-368	FC6020D-50				
M24308/24-73F	DD15M4B800C-50	M39029/64-369	MC6020D-50				
M24308/24-73P	DD15M4B800S-50	METAL HOODS					
M24308/24-173	DD15M4B8000-50-403.36	M85049/48-1-3F	RD25000H00				
M24308/24-273	DD15M4B8000-50-403.0	M85049/48-1-4F	RD37000H00				
M24308/24-273F	DD15M4B800C-50-403.0	M85049/48-1-5F	RD50000H00				
M24308/24-273P	DD15M4B800S-50						
M24308/24-373	DD15M4B8000-50-799.12						
M24308/24-74	DD26M4B8000-50						
M24308/24-74F	DD26M4B800C-50						
M24308/24-74P	DD26M4B800S-50						
M24308/24-174	DD26M4B8000-50-403.36						
M24308/24-274	DD26M4B8000-50-403.0						
M24308/24-274F	DD26M4B800C-50-403.0						
M24308/24-274P	DD26M4B800S-50						
M24308/24-374	DD26M4B8000-50-799.12						
M24308/24-75	DD44M4B8000-50						
M24308/24-75F	DD44M4B800C-50						
M24308/24-75P	DD44M4B800S-50						
M24308/24-175	DD44M4B8000-50-403.36						
M24308/24-275	DD44M4B8000-50-403.0						
M24308/24-275F	DD44M4B800C-50-403.0						
M24308/24-275P	DD44M4B800S-50						
M24308/24-375	DD44M4B8000-50-799.12						
M24308/24-76	DD62M4B8000-50						
M24308/24-76F	DD62M4B800C-50						
M24308/24-76P	DD62M4B800S-50						